

Attachment B - Premises

RCC - Level 1

Total Area - 455,560 S.F.

Leased Area - 283,513 S.F.

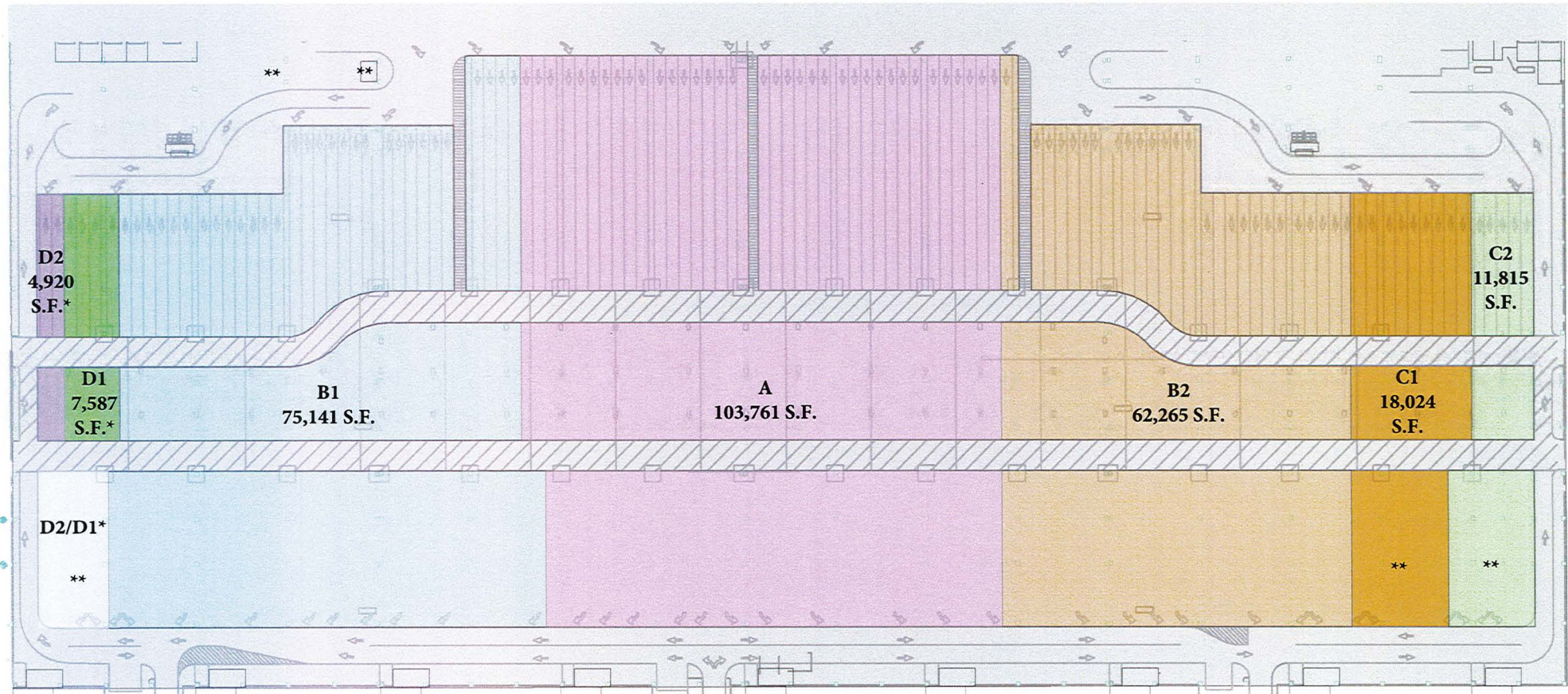

* The bidders awarded packages D2 and D1 will be sharing one car wash and one office (highlighted in light gray as D2/D1) and will evenly split the total area in that space (4,818 S.F.) for cost purposes. The 2,409 S.F. (4,818/2) for each D2 and D1 have already been included in the overall S.F. totals listed above so the size of D2 is 4,920 (2,511+2,409) and D1 is 7,587 (5,178+2,409). The bidders that are awarded either D2 or D1 will have access to the entirety of the one car wash and one office (highlighted in light gray as D2/D1).

** Here is a breakdown of offices/car washes for the following packages:

- D2/D1 one office/one car wash (both shared)
- C1 - two offices/one car wash
- C2 - one office/one car wash

Attachment B - Premises

RCC - Level 2

Total Area - 455,560 S.F.

Leased Area - 290,345 S.F.

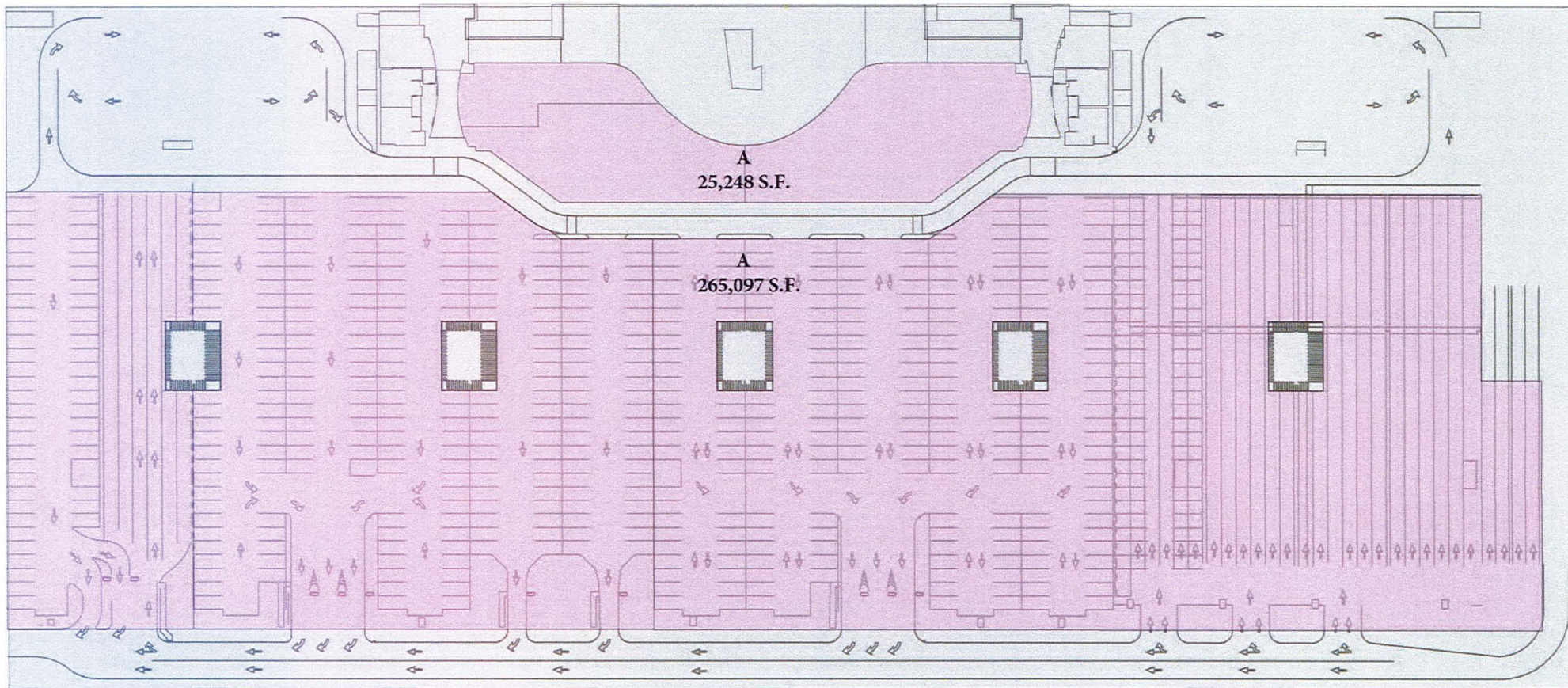

Attachment B - Premises

RCC - Level 3

Total Area - 455,560 S.F.

Leased Area - 278,198 S.F.

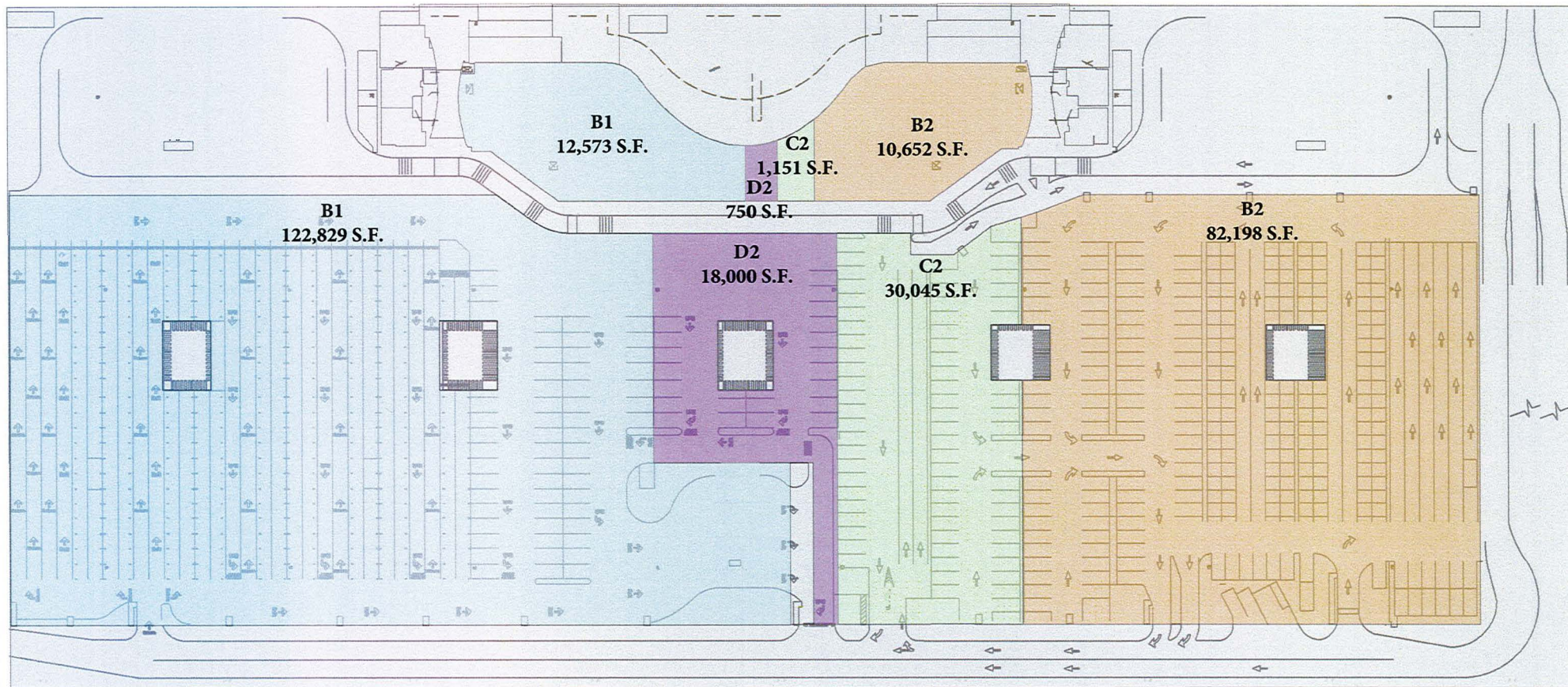

Attachment B - Premises

RCC - Level 4
Total Area - 455,560 S.F.
Leased Area - 276,539 S.F.

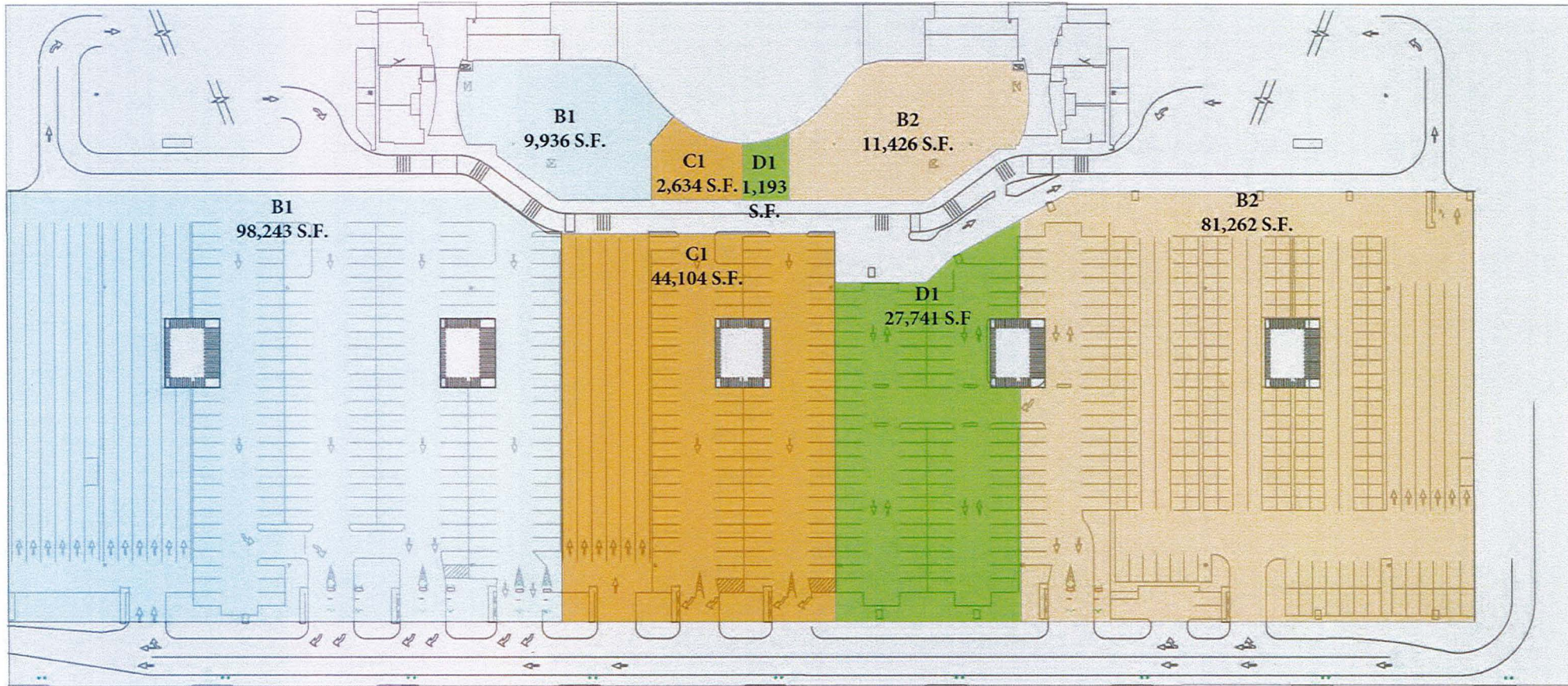

Attachment B - Premises

RCC - Level 5
Total Area - 455,560 S.F.
Leased Area - 273,970 S.F.

