

 Project Location
Andrews Avenue from Oakland Park Boulevard to Prospect Road
Precise Limits of Revocable License Area Shown on Following Pages

Location Map

Limits of County Right-of-Way = 
 Limits of Revocable License Area = 

BCHCED REF #170504001

Exhibit 2
 Page 2 of 10

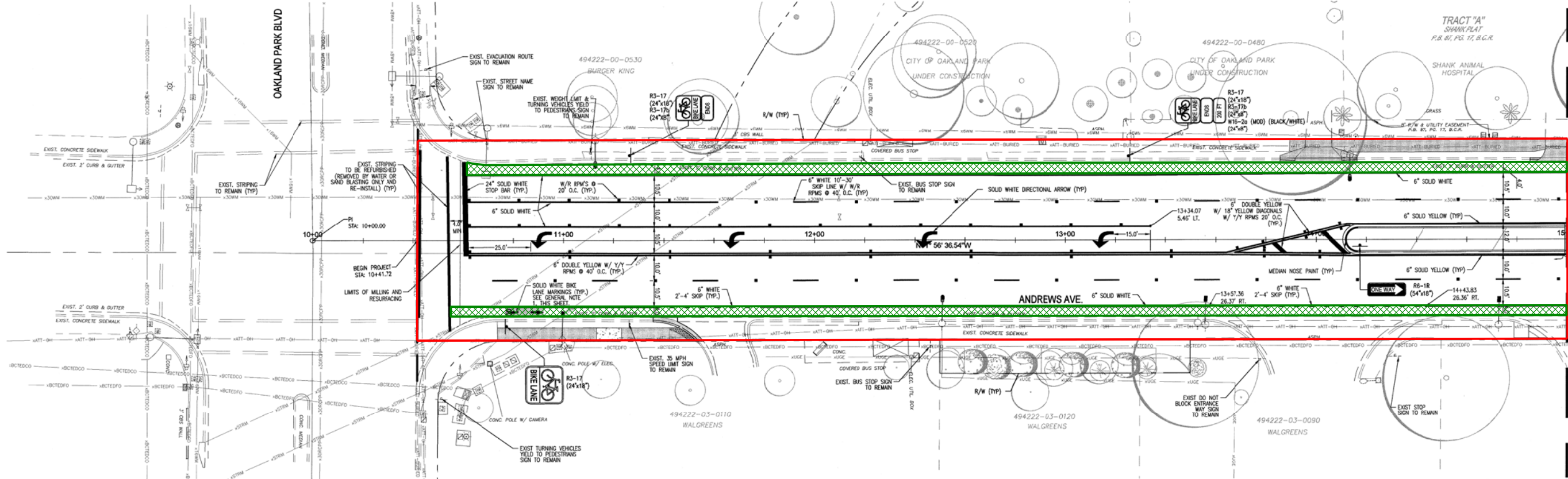
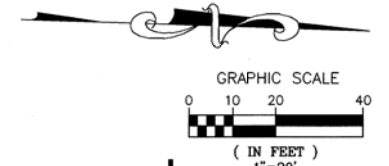

MATCH LINE STA. 15+00.00
 SEE SHEET PMS2 FOR CONTINUATION

GENERAL NOTE:

- BIKE LANE MARKINGS SHALL BE PER FOOT INDEX 17347. GREEN COLOR MARKING SHALL BE NON-REFLECTIVE AND SHALL MEET THE REQUIREMENTS PER FOOT SPECIFICATION 523, PATTERNED PAVEMENTS, AND PLANS PREPARATION MANUAL, VOL.1 SECTION 8.4.2.2. GREEN COLOR BICYCLE LANES. REFER TO DETAILS PROVIDED ON PMS1 FOR MORE INFORMATION.

LEGEND:

 CONCRETE RECONSTRUCTION BY COUNTY

THE FOLLOWING ITEMS ARE NOT REVIEWED OR ACCEPTED BY BROWARD COUNTY:

- BROWARD COUNTY TRAFFIC ENGINEERING DIVISION'S REVIEW DOES NOT INCLUDE A REVIEW AND ACCEPTANCE OF THE PROJECT'S DESIGN OR OPERATION. THESE ITEMS ARE TO BE REVIEWED AND APPROVED BY THE CITY ENGINEER.
- BROWARD COUNTY TRAFFIC ENGINEERING DIVISION DOES NOT REVIEW AND APPROVE, OR INSPECT AND ACCEPT THE FOLLOWING ITEMS FOR MAINTENANCE: PAVEMENT MARKINGS ON OR ADJACENT TO PAVER BRICKS, PAINTED ASPHALT, STAMPED ASPHALT OR PAVEMENT MARKINGS MADE OF PAVER BRICKS, RAISED INTERSECTIONS AND RELATED MARKINGS AND SIGNING, UN-WARRANTED MID-BLOCK CROSSWALKS AND RELATED MARKINGS AND SIGNING, UN-WARRANTED CROSSWALKS AND RELATED MARKINGS AND SIGNING, PAINTED/DECORATIVE CROSSWALKS AND RELATED MARKINGS AND SIGNING, BUNKER SIGNS, RECTANGULAR RAPID FLASHER BEACONS AND RELATED MARKINGS AND SIGNING, ON-STREET PARKING AND RELATED MARKINGS AND SIGNING, IN-ROAD LIGHTING AND RELATED MARKINGS AND SIGNING, GREEN BIKE LANES, FLEXIBLE DELINEATORS, DECORATIVE SIGNS AND DECORATIVE SIGN POSTS, PLANTERS, ON-SITE PAVEMENT MARKINGS AND SIGNING, OFF-SITE PAVEMENT MARKINGS AND SIGNING IN RIGHT-OF-WAY THAT IS NOT DEDICATED FOR PUBLIC USE, SIDEWALK WORK OR ASPHALT WORK.
- THE CITY ENGINEER IS RESPONSIBLE FOR THE REVIEW AND APPROVAL OF THE DESIGN AND OPERATION OF THE PROJECT, AND FOR THE INSPECTION AND ACCEPTANCE OF THE FOLLOWING ITEMS THAT WILL BE MAINTAINED BY THE CITY: PAVEMENT MARKINGS ON OR ADJACENT TO PAVER BRICKS, PAINTED ASPHALT, STAMPED ASPHALT OR PAVEMENT MARKINGS MADE OF PAVER BRICKS, RAISED INTERSECTIONS AND RELATED MARKINGS AND SIGNING, UN-WARRANTED MID-BLOCK CROSSWALKS AND RELATED MARKINGS AND SIGNING, UN-WARRANTED CROSSWALKS AND RELATED MARKINGS AND SIGNING, PAINTED/DECORATIVE CROSSWALKS, RAISED CROSSWALKS AND RELATED MARKINGS AND SIGNING, BUNKER SIGNS, RECTANGULAR RAPID FLASHER BEACONS AND RELATED MARKINGS AND SIGNING, ON-STREET PARKING AND RELATED MARKINGS AND SIGNING, IN-ROAD LIGHTING AND RELATED MARKINGS AND SIGNING, GREEN BIKE LANES, FLEXIBLE DELINEATORS, DECORATIVE SIGNS AND DECORATIVE SIGN POSTS, PLANTERS, ON-SITE PAVEMENT MARKINGS AND SIGNING, OFF-SITE PAVEMENT MARKINGS AND SIGNING IN RIGHT-OF-WAY THAT IS NOT DEDICATED FOR PUBLIC USE, SIDEWALK WORK AND ASPHALT WORK.

PERMIT SET

MUST BE ON JOBSITE AT ALL TIMES DURING CONSTRUCTION

ALL MATERIALS USED AND INSTALLATIONS WITHIN THE PUBLIC RIGHT-OF-WAY OR EASEMENTS SHALL BE IN ACCORDANCE WITH BROWARD COUNTY HIGHWAY CONSTRUCTION AND ENGINEERING MINIMUM STANDARDS.

NOTE: APPROVAL OF THIS PLAN DOES NOT CONSTITUTE A PERMIT FOR CONSTRUCTION. A PERMIT FOR CONSTRUCTION MUST BE OBTAINED FROM THE BROWARD COUNTY HIGHWAY CONSTRUCTION AND ENGINEERING DIVISION PRIOR TO COMMENCING CONSTRUCTION IN THE PUBLIC RIGHT OF WAY.

NOTICE

INSPECTION REQUIRED
 24 HRS. PRIOR TO COMMENCING ANY WORK IN THE PUBLIC RW CONTACT THE BROWARD COUNTY HIGHWAY CONSTRUCTION AND ENGINEERING DIVISION AT 954-577-4600 FOR INSPECTION

BROWARD COUNTY HIGHWAY CONSTRUCTION AND ENGINEERING DIVISION

BROWARD COUNTY TRAFFIC ENGINEERING DIVISION
 APPROVED
 BY: 
 DATE: 5/9/18
 REMARKS:
 APPROVAL IS FOR THE PAVEMENT MARKINGS AND SIGNAGE ONLY AND IS LIMITED TO WORK IN PUBLIC RIGHT-OF-WAY AND DRIVEWAY CONNECTIONS THERE TO

PLAN CONSISTENT WITH PLAT REQUIREMENTS
 PUBLIC RIGHT OF WAY APPROVAL FOR PAVING, GRADING AND DRAINAGE
 BY:  DATE: MAY - 9 2018



KEY MAP
 N.T.S.

NO	DATE	REVISION	BY	NO	DATE	REVISION	BY

DESIGNED NRM 05/16
 CHECKED QAC 08/18
 DATE 08/18
 ISSUED FOR PHASE 08/18

 **Calvin, Giordano & Associates, Inc.**
 EXCEPTIONAL SOLUTIONSSM
 1800 Eller Drive, Suite 600, Fort Lauderdale, Florida 33316
 Phone: 954.921.7781 - Fax: 954.921.8807
 Certificate of Authorization 514

ANDREWS AVENUE ROADWAY IMPROVEMENTS
 (FROM OAKLAND PARK BLVD. TO PROSPECT ROAD)
 OAKLAND PARK, FLORIDA

PAVEMENT MARKING AND SIGNAGE PLAN

CONSTRUCTION DOCUMENTS
 ELEVATIONS ARE NAVD 1988

NICHOLAS B. MAHONS
 STATE OF FLORIDA PROFESSIONAL ENGINEER
 LICENSE No. 78361
 DATE: MAY 4, 2018

SCALE AS SHOWN
 PROJECT No 114259.32
 PURPOSE OF THIS SET CONSTRUCTION

SHEET: PMS1

File Name: P:\Projects\2011\114259_City Of Oakland Park\code Files\Drawings\114259.32_Andrews Avenue Roadway Improvements\114259.32_PMS1 Thru PMS9.dwg - (Plotted by: Katherine Kupsky on Friday, May 4, 2018 2:32:21 PM)

Limits of County Right-of-Way = [Red Box]
Limits of Revocable License Area = [Green Box]

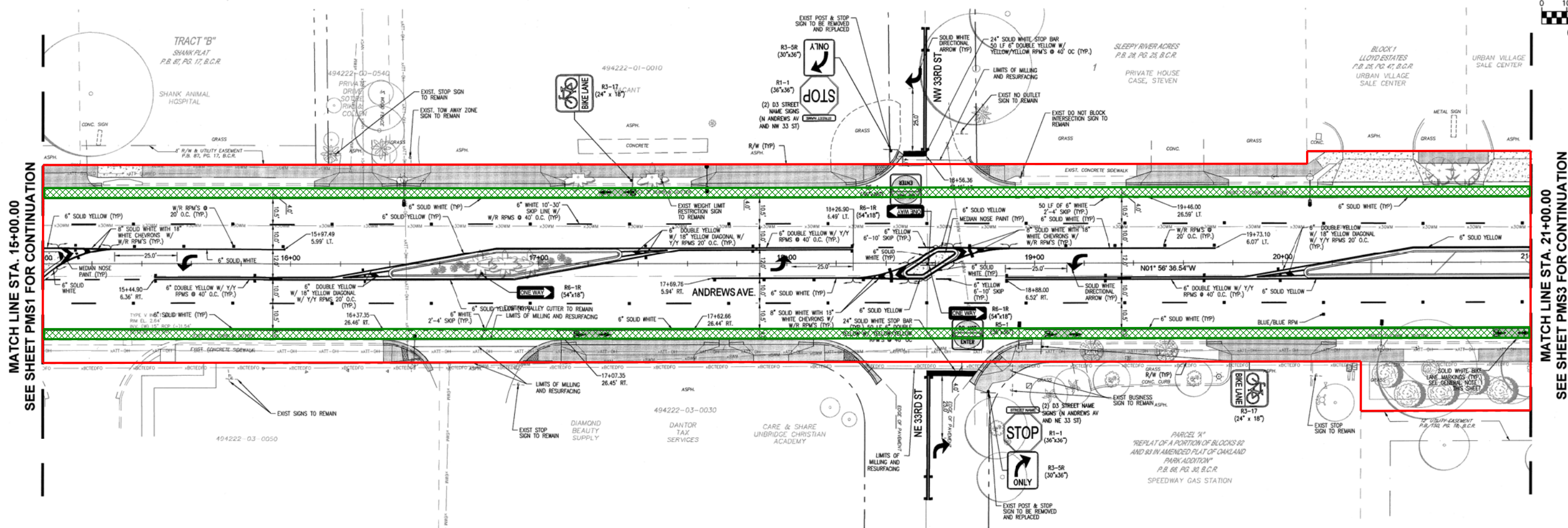
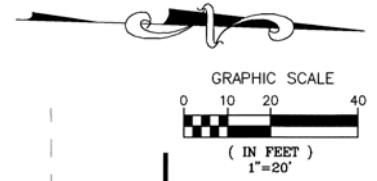

MATCH LINE STA. 15+00.00
SEE SHEET PMS1 FOR CONTINUATION

MATCH LINE STA. 21+00.00
SEE SHEET PMS3 FOR CONTINUATION

- GENERAL NOTE:
1. BIKE LANE MARKINGS SHALL BE PER FOOT INDEX 17347. GREEN COLOR MARKING SHALL BE NON-REFLECTIVE AND SHALL MEET THE REQUIREMENTS PER FOOT SPECIFICATION 523, PATTERNED PAVEMENTS, AND PLANS PREPARATION MANUAL, VOL.1 SECTION 8.4.2.2, GREEN COLOR BICYCLE LANES. REFER TO DETAILS PROVIDED ON PMS11 FOR MORE INFORMATION.
LEGEND:
[Symbol] CONCRETE RECONSTRUCTION BY COUNTY
THE FOLLOWING ITEMS ARE NOT REVIEWED OR ACCEPTED BY BROWARD COUNTY:
1. BROWARD COUNTY TRAFFIC ENGINEERING DIVISION'S REVIEW DOES NOT INCLUDE A REVIEW AND ACCEPTANCE OF THE PROJECT'S DESIGN OR OPERATION. THESE ITEMS ARE TO BE REVIEWED AND APPROVED BY THE CITY ENGINEER.
2. BROWARD COUNTY TRAFFIC ENGINEERING DIVISION DOES NOT REVIEW AND APPROVE, OR INSPECT AND ACCEPT THE FOLLOWING ITEMS FOR MAINTENANCE: PAVEMENT MARKINGS ON OR ADJACENT TO PAVEMENT BRICKS, PAINTED ASPHALT OR PAVEMENT MARKINGS MADE OF PAVEMENT BRICKS, RAISED INTERSECTIONS AND RELATED MARKINGS AND SIGNING, UN-WARRANTED MID-BLOCK CROSSWALKS AND RELATED MARKINGS AND SIGNING, UN-WARRANTED CROSSWALKS AND RELATED MARKINGS AND SIGNING, PAINTED/DECORATIVE CROSSWALKS, RAISED CROSSWALKS AND RELATED MARKINGS AND SIGNING, BLUNKER SIGNS, RECTANGULAR RAPID FLASHER BEACONS AND RELATED MARKINGS AND SIGNING, ON-STREET PARKING AND RELATED MARKINGS AND SIGNING, IN-ROAD LIGHTING AND RELATED MARKINGS AND SIGNING, GREEN BIKE LANES, FLEXIBLE DELINEATORS, DECORATIVE SIGNS AND DECORATIVE SIGN POSTS, PLANTERS, ON-SITE PAVEMENT MARKINGS AND SIGNING, OFF-SITE PAVEMENT MARKINGS AND SIGNING IN RIGHT-OF-WAY THAT IS NOT DEDICATED FOR PUBLIC USE, SIDEWALK WORK OR ASPHALT WORK.
3. THE CITY ENGINEER IS RESPONSIBLE FOR THE REVIEW AND APPROVAL OF THE DESIGN AND OPERATION OF THE PROJECT, AND FOR THE INSPECTION AND ACCEPTANCE OF THE FOLLOWING ITEMS THAT WILL BE MAINTAINED BY THE CITY: PAVEMENT MARKINGS ON OR ADJACENT TO PAVEMENT BRICKS, PAINTED ASPHALT OR PAVEMENT MARKINGS MADE OF PAVEMENT BRICKS, RAISED INTERSECTIONS AND RELATED MARKINGS AND SIGNING, UN-WARRANTED MID-BLOCK CROSSWALKS AND RELATED MARKINGS AND SIGNING, UN-WARRANTED CROSSWALKS AND RELATED MARKINGS AND SIGNING, PAINTED/DECORATIVE CROSSWALKS, RAISED CROSSWALKS AND RELATED MARKINGS AND SIGNING, BLUNKER SIGNS, RECTANGULAR RAPID FLASHER BEACONS AND RELATED MARKINGS AND SIGNING, ON-STREET PARKING AND RELATED MARKINGS AND SIGNING, IN-ROAD LIGHTING AND RELATED MARKINGS AND SIGNING, GREEN BIKE LANES, FLEXIBLE DELINEATORS, DECORATIVE SIGNS AND DECORATIVE SIGN POSTS, PLANTERS, ON-SITE PAVEMENT MARKINGS AND SIGNING, OFF-SITE PAVEMENT MARKINGS AND SIGNING IN RIGHT-OF-WAY THAT IS NOT DEDICATED FOR PUBLIC USE, SIDEWALK WORK AND ASPHALT WORK.
PERMIT SET
MUST BE ON JOBSITE AT ALL TIMES DURING CONSTRUCTION
ALL MATERIALS USED AND INSTALLATIONS WITHIN THE PUBLIC RIGHT OF WAY OR EASEMENTS SHALL BE IN ACCORDANCE WITH BROWARD COUNTY HIGHWAY CONSTRUCTION AND ENGINEERING MINIMUM STANDARDS.
NOTE: APPROVAL OF THIS PLAN DOES NOT CONSTITUTE A PERMIT FOR CONSTRUCTION. A PERMIT FOR CONSTRUCTION MUST BE OBTAINED FROM THE BROWARD COUNTY HIGHWAY CONSTRUCTION AND ENGINEERING DIVISION PRIOR TO COMMENCING CONSTRUCTION IN THE PUBLIC RIGHT OF WAY.
NOTICE
INSPECTION REQUIRED
24 HRS. PRIOR TO COMMENCING ANY WORK IN THE PUBLIC RW CONTACT THE BROWARD COUNTY HIGHWAY CONSTRUCTION AND ENGINEERING DIVISION AT 954-577-4600 FOR INSPECTION



BROWARD COUNTY TRAFFIC ENGINEERING DIVISION
APPROVED [Signature]
DATE: 5/10/18
REMARKS:
APPROVAL IS FOR THE PAVEMENT MARKINGS AND SIGNAGE ONLY AND IS LIMITED TO WORK IN PUBLIC RIGHT-OF-WAY AND DRIVEWAY CONNECTIONS THERETO.
BROWARD COUNTY HIGHWAY CONSTRUCTION AND ENGINEERING DIVISION
PLAN CONSISTENT WITH PLAT REQUIREMENTS
PUBLIC RIGHT OF WAY APPROVAL FOR PAVING, GRADING AND DRAINAGE
MAY - 9 2018
DATE: [Signature]

Table with columns: NO, DATE, REVISION, BY, NO, DATE, REVISION, BY. Includes a row for DESIGNED DATE 05/16, CHECKED DATE 08/16, ISSUED FOR DATE 08/16.

Calvin, Giordano & Associates, Inc.
EXCEPTIONAL SOLUTIONS
1800 Ekar Drive, Suite 600, Fort Lauderdale, Florida 33316
Phone: 954.921.7781 - Fax: 954.921.8807
Certificate of Authorization 514

ANDREWS AVENUE ROADWAY IMPROVEMENTS
(FROM OAKLAND PARK BLVD. TO PROSPECT ROAD)
OAKLAND PARK, FLORIDA

PAVEMENT MARKING AND SIGNAGE PLAN

CONSTRUCTION DOCUMENTS
ELEVATIONS ARE NAVD 1988
NICHOLAS B. MAHON
STATE OF FLORIDA PROFESSIONAL ENGINEER
LICENSE NO. 78362
DATE: MAY 4 2018

SCALE: AS SHOWN
PROJECT No: 114259.32
PURPOSE OF THIS SET: CONSTRUCTION
SHEET: PMS2

File Name: P:\Projects\2011\114259 City Of Oakland Park\cadd Files\Drawings\114259.32_PMS1 Thru PMS9.dwg (Plotted by: Katharine Kupsky on Friday, May 4, 2018 2:32:41 PM)

Limits of County Right-of-Way = [Red Box]
Limits of Revocable License Area = [Green Box]

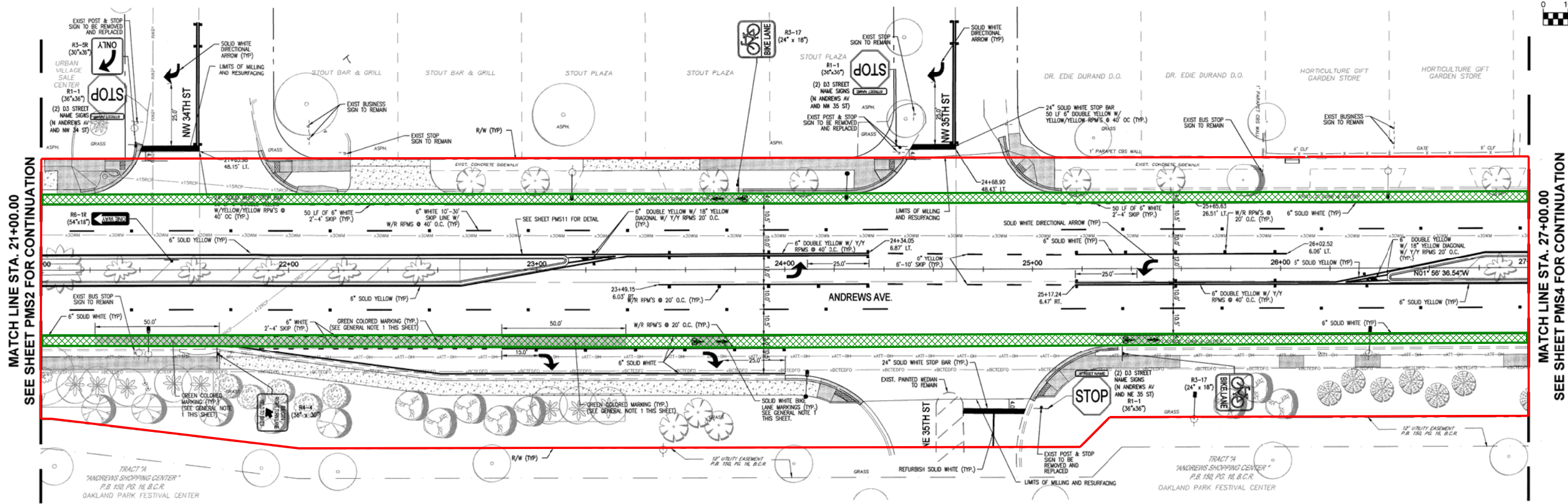
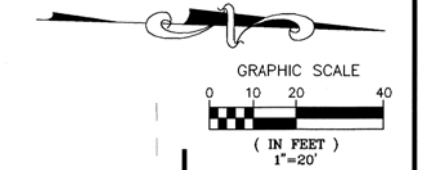

MATCH LINE STA. 21+00.00
SEE SHEET PMS2 FOR CONTINUATION

MATCH LINE STA. 27+00.00
SEE SHEET PMS4 FOR CONTINUATION

GENERAL NOTE:

- 1. BIKE LANE MARKINGS SHALL BE PER FOOT INDEX 17347. GREEN COLOR MARKING SHALL BE NON-REFLECTIVE AND SHALL MEET THE REQUIREMENTS PER FOOT SPECIFICATION 523, PATTERNED PAVEMENTS, AND PLANS PREPARATION MANUAL, VOL. 1 SECTION 8.4.2, GREEN COLOR BICYCLE LANES. REFER TO DETAILS PROVIDED ON PMS11 FOR MORE INFORMATION.

LEGEND:

CONCRETE RECONSTRUCTION BY COUNTY

THE FOLLOWING ITEMS ARE NOT REVIEWED OR ACCEPTED BY BROWARD COUNTY:

- 1. BROWARD COUNTY TRAFFIC ENGINEERING DIVISION'S REVIEW DOES NOT INCLUDE A REVIEW AND ACCEPTANCE OF THE PROJECT'S DESIGN OR OPERATION. THESE ITEMS ARE TO BE REVIEWED AND APPROVED BY THE CITY ENGINEER.
2. BROWARD COUNTY TRAFFIC ENGINEERING DIVISION DOES NOT REVIEW AND APPROVE, OR INSPECT AND ACCEPT THE FOLLOWING ITEMS FOR MAINTENANCE: PAVEMENT MARKINGS ON OR ADJACENT TO PAVED BRICKS, PAINTED ASPHALT, STAMPED ASPHALT OR PAVEMENT MARKINGS MADE OF PAVED BRICKS, BASED INTERSECTIONS AND RELATED MARKINGS AND SIGNING, UN-WARRANTED MID-BLOCK CROSSWALKS AND RELATED MARKINGS AND SIGNING, UN-WARRANTED CROSSWALKS AND RELATED MARKINGS AND SIGNING, PAINTED/DECORATIVE CROSSWALKS, BASED CROSSWALKS AND RELATED MARKINGS AND SIGNING, BLANKET SIGNS, RECTANGULAR RAPID FLASHER BEACONS AND RELATED MARKINGS AND SIGNING, ON-STREET PARKING AND RELATED MARKINGS AND SIGNING, IN-ROAD LIGHTING AND RELATED MARKINGS AND SIGNING, GREEN BIKE LANES, FLEXIBLE DELINEATORS, DECORATIVE SIGN POSTS, PLANTERS, ON-SITE PAVEMENT MARKINGS AND SIGNING, OFF-SITE PAVEMENT MARKINGS AND SIGNING IN RIGHT-OF-WAY THAT IS NOT DEDICATED FOR PUBLIC USE, SIDEWALK WORK OR ASPHALT WORK.
3. THE CITY ENGINEER IS RESPONSIBLE FOR THE REVIEW AND APPROVAL OF THE DESIGN AND OPERATION OF THE PROJECT, AND FOR THE INSPECTION AND ACCEPTANCE OF THE FOLLOWING ITEMS THAT WILL BE MAINTAINED BY THE CITY: PAVEMENT MARKINGS ON OR ADJACENT TO PAVED BRICKS, PAINTED ASPHALT, STAMPED ASPHALT OR PAVEMENT MARKINGS MADE OF PAVED BRICKS, BASED INTERSECTIONS AND RELATED MARKINGS AND SIGNING, UN-WARRANTED MID-BLOCK CROSSWALKS AND RELATED MARKINGS AND SIGNING, UN-WARRANTED CROSSWALKS AND RELATED MARKINGS AND SIGNING, PAINTED/DECORATIVE CROSSWALKS, BASED CROSSWALKS AND RELATED MARKINGS AND SIGNING, BLANKET SIGNS, RECTANGULAR RAPID FLASHER BEACONS AND RELATED MARKINGS AND SIGNING, ON-STREET PARKING AND RELATED MARKINGS AND SIGNING, IN-ROAD LIGHTING AND RELATED MARKINGS AND SIGNING, GREEN BIKE LANES, FLEXIBLE DELINEATORS, DECORATIVE SIGN POSTS, PLANTERS, ON-SITE PAVEMENT MARKINGS AND SIGNING, OFF-SITE PAVEMENT MARKINGS AND SIGNING IN RIGHT-OF-WAY THAT IS NOT DEDICATED FOR PUBLIC USE, SIDEWALK WORK OR ASPHALT WORK.

PERMIT SET

MUST BE ON JOBSITE AT ALL TIMES DURING CONSTRUCTION

ALL MATERIALS USED AND INSTALLATIONS WITHIN THE PUBLIC RIGHT OF WAY OR EASEMENTS SHALL BE IN ACCORDANCE WITH BROWARD COUNTY HIGHWAY CONSTRUCTION AND ENGINEERING MINIMUM STANDARDS.

NOTE: APPROVAL OF THIS PLAN DOES NOT CONSTITUTE A PERMIT FOR CONSTRUCTION. A PERMIT FOR CONSTRUCTION MUST BE OBTAINED FROM THE BROWARD COUNTY HIGHWAY CONSTRUCTION AND ENGINEERING DIVISION PRIOR TO COMMENCING CONSTRUCTION IN THE PUBLIC RIGHT OF WAY.

NOTICE: INSPECTION REQUIRED. 24 HRS. PRIOR TO COMMENCING ANY WORK IN THE PUBLIC RIGHT CONTACT THE BROWARD COUNTY HIGHWAY CONSTRUCTION AND ENGINEERING DIVISION AT 954-577-4600 FOR INSPECTION.



KEY MAP N.T.S.

BROWARD COUNTY TRAFFIC ENGINEERING DIVISION
APPROVED
BY: [Signature]
DATE: 5/10/18

BROWARD COUNTY HIGHWAY CONSTRUCTION AND ENGINEERING DIVISION
PLAN CONSISTENT WITH PLAT REQUIREMENTS
PUBLIC RIGHT OF WAY APPROVAL FOR PAVING, GRADING AND DRAINAGE
DATE: MAY - 9 2018

CONSTRUCTION DOCUMENTS
ELEVATIONS ARE NAVD 1988
NICHOLAS B. MAHON, P.E.
STATE OF FLORIDA PROFESSIONAL ENGINEER
LICENSE NO. 78361
DATE: MAY 4, 2018

Table with columns: NO, DATE, REVISION, BY, NO, DATE, REVISION, BY

DESIGNED DATE: 05/16
CHECKED DATE: 08/16
ISSUED FOR DATE: 08/16
NBM
QAQC
PHASE
Calvin, Giordano & Associates, Inc.
EXCEPTIONAL SOLUTIONS
1800 Eller Drive, Suite 600, Fort Lauderdale, Florida 33316
Phone: 954.921.7781 - Fax: 954.921.8807
Certificate of Authorization 514

ANDREWS AVENUE ROADWAY IMPROVEMENTS
(FROM OAKLAND PARK BLVD. TO PROSPECT ROAD)
OAKLAND PARK, FLORIDA

PAVEMENT MARKING AND SIGNAGE PLAN

SCALE: AS SHOWN
PROJECT NO: 114259.32
PURPOSE OF THIS SET: CONSTRUCTION
SHEET: PMS3

File Name: P:\Projects\2011\114259_City Of Oakland Park\cadd Files\Drawings\114259.32_Andrews Avenue Roadway Improvements\114259.32_PMS1 Thru PMS9.dwg (Plotted by: Katharine Kupsky on Friday, May 4, 2018 2:33:11 PM)

Limits of County Right-of-Way = [Red Box]
Limits of Revocable License Area = [Green Box]

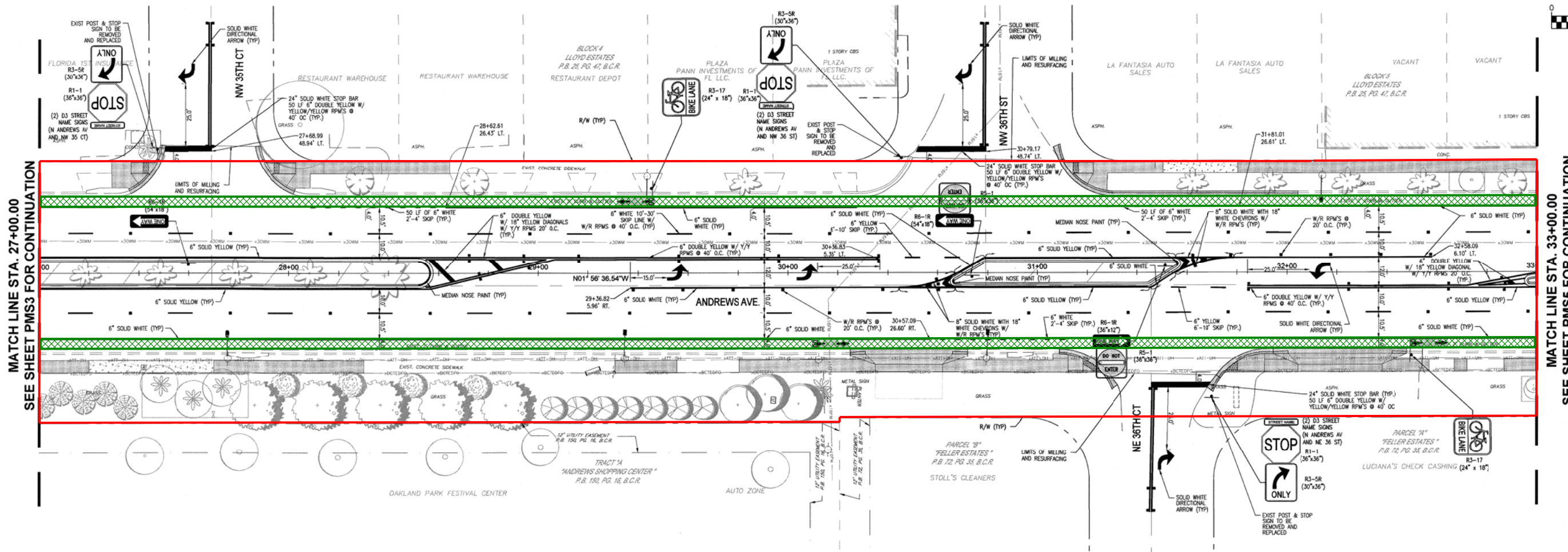
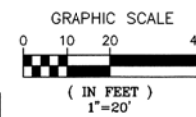

MATCH LINE STA. 27+00.00
SEE SHEET PMS3 FOR CONTINUATION

MATCH LINE STA. 33+00.00
SEE SHEET PMS5 FOR CONTINUATION

GENERAL NOTE:

- 1. BIKE LANE MARKINGS SHALL BE PER FOOT INDEX 17347. GREEN COLOR MARKING SHALL BE NON-REFLECTIVE AND SHALL MEET THE REQUIREMENTS PER FOOT SPECIFICATION 523, PATTERNED PAVEMENTS, AND PLANS PREPARATION MANUAL, VOL. 1 SECTION 8.4.2.2, GREEN COLOR BICYCLE LANES. REFER TO DETAILS PROVIDED ON PMS11 FOR MORE INFORMATION.

LEGEND:

CONCRETE RECONSTRUCTION BY COUNTY

THE FOLLOWING ITEMS ARE NOT REVIEWED OR ACCEPTED BY BROWARD COUNTY:

- 1. BROWARD COUNTY TRAFFIC ENGINEERING DIVISION'S REVIEW DOES NOT INCLUDE A REVIEW AND ACCEPTANCE OF THE PROJECT'S DESIGN OR OPERATION. THESE ITEMS ARE TO BE REVIEWED AND APPROVED BY THE CITY ENGINEER.
2. BROWARD COUNTY TRAFFIC ENGINEERING DIVISION DOES NOT REVIEW AND APPROVE, OR INSPECT AND ACCEPT THE FOLLOWING ITEMS FOR MAINTENANCE: PAVEMENT MARKINGS ON OR ADJACENT TO PAVED BRICKS, PAINTED ASPHALT, STAMPED ASPHALT OR PAVEMENT MARKINGS MADE OF PAVED BRICKS, RAISED INTERSECTIONS AND RELATED MARKINGS AND SIGNING, UN-WARRANTED MID-BLOCK CROSSWALKS AND RELATED MARKINGS AND SIGNING, UN-WARRANTED CROSSWALKS AND RELATED MARKINGS AND SIGNING, PAINTED/DECORATIVE CROSSWALKS AND RELATED MARKINGS AND SIGNING, BLINKER SIGNS, RECTANGULAR RAPID FLASHER BEACONS AND RELATED MARKINGS AND SIGNING, ON-STREET PARKING AND RELATED MARKINGS AND SIGNING, IN-ROAD LIGHTING AND RELATED MARKINGS AND SIGNING, GREEN BIKE LANES, FLEXIBLE DELINEATORS, DECORATIVE SIGNS AND DECORATIVE SIGN POSTS, PLANTERS, ON-SITE PAVEMENT MARKINGS AND SIGNING, OFF-SITE PAVEMENT MARKINGS AND SIGNING IN RIGHT-OF-WAY THAT IS NOT DEDICATED FOR PUBLIC USE, SIDEWALK WORK OR ASPHALT WORK.
3. THE CITY ENGINEER IS RESPONSIBLE FOR THE REVIEW AND APPROVAL OF THE DESIGN AND OPERATION OF THE PROJECT, AND FOR THE INSPECTION AND ACCEPTANCE OF THE FOLLOWING ITEMS THAT WILL BE MAINTAINED BY THE CITY: PAVEMENT MARKINGS ON OR ADJACENT TO PAVED BRICKS, PAINTED ASPHALT, STAMPED ASPHALT OR PAVEMENT MARKINGS MADE OF PAVED BRICKS, RAISED INTERSECTIONS AND RELATED MARKINGS AND SIGNING, UN-WARRANTED MID-BLOCK CROSSWALKS AND RELATED MARKINGS AND SIGNING, UN-WARRANTED CROSSWALKS AND RELATED MARKINGS AND SIGNING, PAINTED/DECORATIVE CROSSWALKS, RAISED CROSSWALKS AND RELATED MARKINGS AND SIGNING, BLINKER SIGNS, RECTANGULAR RAPID FLASHER BEACONS AND RELATED MARKINGS AND SIGNING, ON-STREET PARKING AND RELATED MARKINGS AND SIGNING, IN-ROAD LIGHTING AND RELATED MARKINGS AND SIGNING, GREEN BIKE LANES, FLEXIBLE DELINEATORS, DECORATIVE SIGN AND DECORATIVE SIGN POSTS, PLANTERS, ON-SITE PAVEMENT MARKINGS AND SIGNING, OFF-SITE PAVEMENT MARKINGS AND SIGNING IN RIGHT-OF-WAY THAT IS NOT DEDICATED FOR PUBLIC USE, SIDEWALK WORK AND ASPHALT WORK.

PERMIT SET

MUST BE ON JOBSITE AT ALL TIMES DURING CONSTRUCTION

ALL MATERIALS USED AND INSTALLATIONS WITHIN THE PUBLIC RIGHT OF WAY OR EASEMENTS SHALL BE IN ACCORDANCE WITH BROWARD COUNTY HIGHWAY CONSTRUCTION AND ENGINEERING MINIMUM STANDARDS.

NOTE: APPROVAL OF THIS PLAN DOES NOT CONSTITUTE A PERMIT FOR CONSTRUCTION. A PERMIT FOR CONSTRUCTION MUST BE OBTAINED FROM THE BROWARD COUNTY HIGHWAY CONSTRUCTION AND ENGINEERING DIVISION PRIOR TO COMMENCING CONSTRUCTION IN THE PUBLIC RIGHT OF WAY.

NOTICE: INSPECTION REQUIRED. 24 HRS. PRIOR TO COMMENCING ANY WORK IN THE PUBLIC RIGHT OF WAY CONTACT THE BROWARD COUNTY HIGHWAY CONSTRUCTION AND ENGINEERING DIVISION AT 954-677-4600 FOR INSPECTION.

BROWARD COUNTY TRAFFIC ENGINEERING DIVISION AND ENGINEERING DIVISION

APPROVED

DATE: 5/10/18

REMARKS: APPROVAL IS FOR THE PAVEMENT MARKINGS AND SIGNAGE ONLY AND IS LIMITED TO WORK IN PUBLIC RIGHT-OF-WAY AND DRIVEWAY CONNECTIONS THERE TO.

PLAN CONSISTENT WITH PLAT REQUIREMENTS

PUBLIC RIGHT OF WAY APPROVAL FOR PAVING, GRADING AND DRAINAGE

DATE: MAY - 9 2018



KEY MAP N.T.S.

Table with columns: NO, DATE, REVISION, BY, NO, DATE, REVISION, BY

DESIGNED DATE: NEM 05/16
CHECKED DATE: QAQC 08/16
ISSUED FOR DATE: PHASE 08/16
Calvin, Giordano & Associates, Inc.
EXCEPTIONAL SOLUTIONS
1800 Elzer Drive, Suite 600, Fort Lauderdale, Florida 33316
Phone: 954.921.7781 - Fax: 954.921.8807
Certificate of Authorization 514

ANDREWS AVENUE ROADWAY IMPROVEMENTS
(FROM OAKLAND PARK BLVD. TO PROSPECT ROAD)
OAKLAND PARK, FLORIDA

PAVEMENT MARKING AND SIGNAGE PLAN

NICHOLAS B. MAHON
STATE OF FLORIDA PROFESSIONAL ENGINEER
LICENSE No. 78361
DATE: MAY 4, 2018

SCALE: AS SHOWN
PROJECT No: 114259.32
PURPOSE OF THIS SET: CONSTRUCTION
SHEET: PMS4

File Name: P:\Projects\2011\114259_City Of Oakland Park\cadd Files\Drawings\114259_32_Andrews Avenue Roadway Improvements\114259_32_PMS1 Thru PMS9.dwg (Plotted by: Katherine Kupsky on Monday, May 7, 2018 10:43:38 AM)

Limits of County Right-of-Way = [Red Box]
Limits of Revocable License Area = [Green Box]

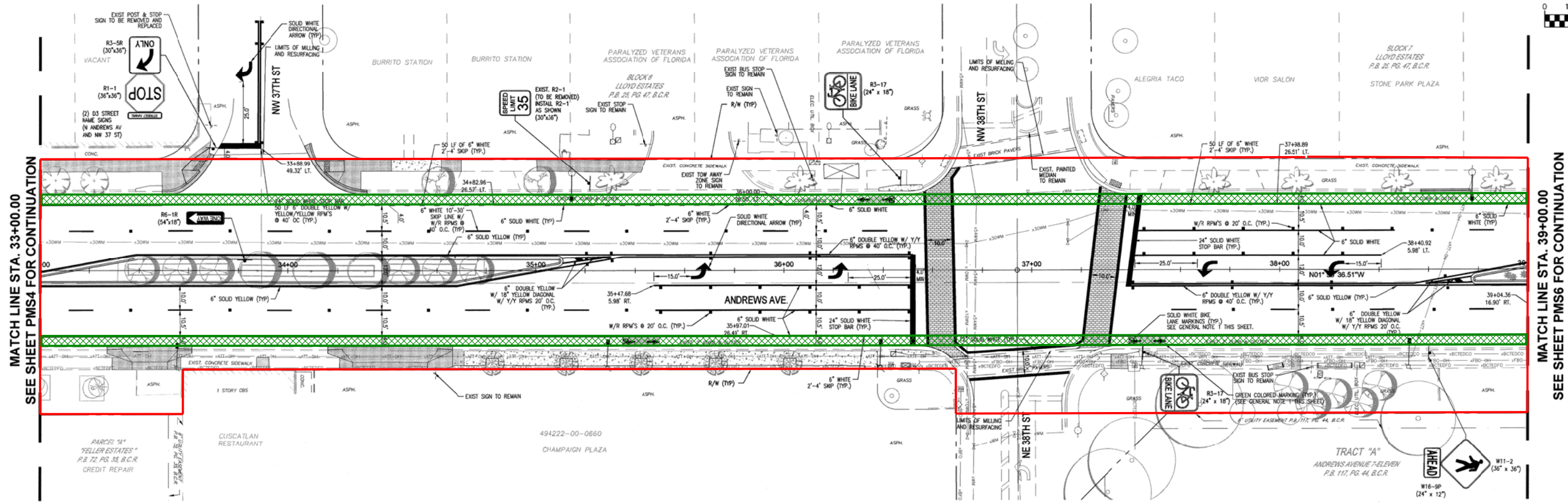
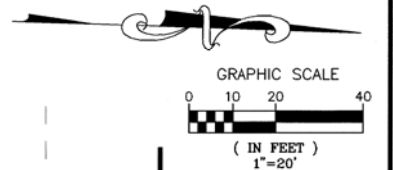

MATCH LINE STA. 33+00.00
SEE SHEET PMS4 FOR CONTINUATION

MATCH LINE STA. 39+00.00
SEE SHEET PMS6 FOR CONTINUATION

GENERAL NOTE:

- 1. BIKE LANE MARKINGS SHALL BE PER FOOT INDEX 17347. GREEN COLOR MARKING SHALL BE HIGH-REFLECTIVE AND SHALL MEET THE REQUIREMENTS PER FOOT SPECIFICATION 523, PATTERNED PAVEMENTS, AND PLANS PREPARATION MANUAL, VOL. 1 SECTION 8.4.2.2, GREEN COLOR BICYCLE LANES. REFER TO DETAILS PROVIDED ON PMS11 FOR MORE INFORMATION.

LEGEND:

CONCRETE RECONSTRUCTION BY COUNTY

THE FOLLOWING ITEMS ARE NOT REVIEWED OR ACCEPTED BY BROWARD COUNTY:

- 1. BROWARD COUNTY TRAFFIC ENGINEERING DIVISION'S REVIEW DOES NOT INCLUDE A REVIEW AND ACCEPTANCE OF THE PROJECT'S DESIGN OR OPERATION. THESE ITEMS ARE TO BE REVIEWED AND APPROVED BY THE CITY ENGINEER.
2. BROWARD COUNTY TRAFFIC ENGINEERING DIVISION DOES NOT REVIEW AND APPROVE, OR INSPECT AND ACCEPT THE FOLLOWING ITEMS FOR MAINTENANCE: PAVEMENT MARKINGS ON OR ADJACENT TO PAVER BRICKS, PAINTED ASPHALT, STAMPED ASPHALT OR PAVEMENT MARKINGS MADE OF PAVER BRICKS, RAISED INTERSECTIONS AND RELATED MARKINGS AND SIGNING, UN-WARRANTED MID-BLOCK CROSSWALKS AND RELATED MARKINGS AND SIGNING, UN-WARRANTED CROSSWALKS AND RELATED MARKINGS AND SIGNING, PAINTED/DECORATIVE CROSSWALKS, RAISED CROSSWALKS AND RELATED MARKINGS AND SIGNING, BLINKER SIGNS, RECTANGULAR RAPID FLASHER BEACONS AND RELATED MARKINGS AND SIGNING, ON-STREET PARKING AND RELATED MARKINGS AND SIGNING, IN-ROAD LIGHTING AND RELATED MARKINGS AND SIGNING, GREEN BIKE LANES, FLEXIBLE DELINEATORS, DECORATIVE SIGNS AND DECORATIVE SIGN POSTS, PLANTERS, ON-SITE PAVEMENT MARKINGS AND SIGNING, OFF-SITE PAVEMENT MARKINGS AND SIGNING IN RIGHT-OF-WAY THAT IS NOT DEDICATED FOR PUBLIC USE, SIDEWALK WORK OR ASPHALT WORK.
3. THE CITY ENGINEER IS RESPONSIBLE FOR THE REVIEW AND APPROVAL OF THE DESIGN AND OPERATION OF THE PROJECT, AND FOR THE INSPECTION AND ACCEPTANCE OF THE FOLLOWING ITEMS THAT WILL BE MAINTAINED BY THE CITY: PAVEMENT MARKINGS ON OR ADJACENT TO PAVER BRICKS, PAINTED ASPHALT, STAMPED ASPHALT OR PAVEMENT MARKINGS MADE OF PAVER BRICKS, RAISED INTERSECTIONS AND RELATED MARKINGS AND SIGNING, UN-WARRANTED MID-BLOCK CROSSWALKS AND RELATED MARKINGS AND SIGNING, UN-WARRANTED CROSSWALKS AND RELATED MARKINGS AND SIGNING, PAINTED/DECORATIVE CROSSWALKS, RAISED CROSSWALKS AND RELATED MARKINGS AND SIGNING, BLINKER SIGNS, RECTANGULAR RAPID FLASHER BEACONS AND RELATED MARKINGS AND SIGNING, ON-STREET PARKING AND RELATED MARKINGS AND SIGNING, IN-ROAD LIGHTING AND RELATED MARKINGS AND SIGNING, GREEN BIKE LANES, FLEXIBLE DELINEATORS, DECORATIVE SIGNS AND DECORATIVE SIGN POSTS, PLANTERS, ON-SITE PAVEMENT MARKINGS AND SIGNING, OFF-SITE PAVEMENT MARKINGS AND SIGNING IN RIGHT-OF-WAY THAT IS NOT DEDICATED FOR PUBLIC USE, SIDEWALK WORK OR ASPHALT WORK.

PERMIT SET

MUST BE ON JOBSITE AT ALL TIMES DURING CONSTRUCTION
ALL MATERIALS USED AND INSTALLATIONS WITHIN THE PUBLIC RIGHT OF WAY OR EASEMENTS SHALL BE IN ACCORDANCE WITH BROWARD COUNTY HIGHWAY CONSTRUCTION AND ENGINEERING MINIMUM STANDARDS.
NOTE: APPROVAL OF THIS PLAN DOES NOT CONSTITUTE A PERMIT FOR CONSTRUCTION. A PERMIT FOR CONSTRUCTION MUST BE OBTAINED FROM THE BROWARD COUNTY HIGHWAY CONSTRUCTION AND ENGINEERING DIVISION PRIOR TO COMMENCING CONSTRUCTION IN THE PUBLIC RIGHT OF WAY.
NOTICE: INSPECTION REQUIRED 24 HRS. PRIOR TO COMMENCING ANY WORK IN THE PUBLIC RW CONTACT THE BROWARD COUNTY HIGHWAY CONSTRUCTION AND ENGINEERING DIVISION AT 954-577-4600 FOR INSPECTION.

BROWARD COUNTY TRAFFIC ENGINEERING DIVISION
APPROVED
BY: [Signature]
DATE: 5/10/18
REMARKS:
APPROVAL IS FOR THE PAVEMENT MARKINGS AND SIGNAGE ONLY AND IS LIMITED TO WORK IN PUBLIC RIGHT-OF-WAY AND DRIVEWAY CONNECTIONS THERETO

BROWARD COUNTY HIGHWAY CONSTRUCTION AND ENGINEERING DIVISION
PLAN CONSISTENT WITH ALL REQUIREMENTS
PUBLIC RIGHT OF WAY APPROVAL FOR PAVING, GRADING AND DRAINAGE
BY: [Signature] DATE: MAY - 9 2018

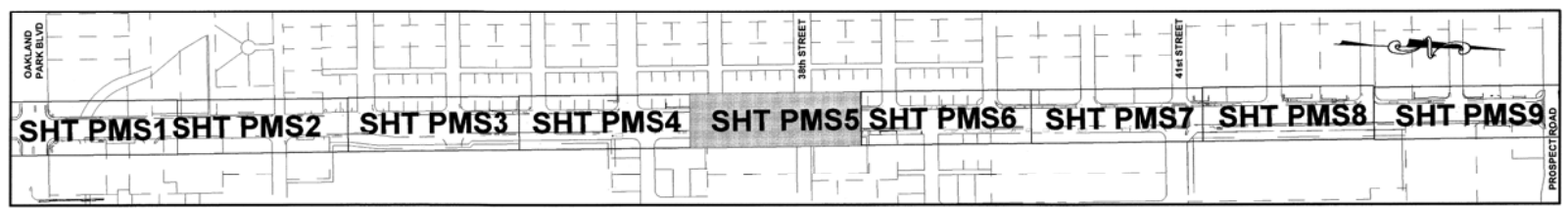

KEY MAP N.T.S.

CONSTRUCTION DOCUMENTS
ELEVATIONS ARE NAVD 1988

Table with columns: NO, DATE, REVISION, BY, NO, DATE, REVISION, BY

DESIGNED DATE: NBM 05/16
CHECKED DATE: JAQC 08/16
ISSUED FOR DATE: PHASE 08/16
Calvin, Giordano & Associates, Inc.
EXCEPTIONAL SOLUTIONS
1800 Eler Drive, Suite 600, Fort Lauderdale, Florida 33316
Phone: 954.921.7781 - Fax: 954.921.8807
Certificate of Authorization 514

ANDREWS AVENUE ROADWAY IMPROVEMENTS
(FROM OAKLAND PARK BLVD. TO PROSPECT ROAD)
OAKLAND PARK, FLORIDA

PAVEMENT MARKING AND SIGNAGE PLAN

NICHOLAS B. MAHON, P.E.
STATE OF FLORIDA PROFESSIONAL ENGINEER
LICENSE NO. 78361
DATE: MAY 4, 2018

SCALE: AS SHOWN
PROJECT NO: 114259.32
PURPOSE OF THIS SET: CONSTRUCTION
SHEET: PMS5

File Name: P:\Projects\2011\114259_City Of Oakland Park\cadd Files\Drawings\114259_32_Andrews Avenue Roadway Improvements\114259_32_PMS1 Thru PMS9.dwg (Plotted by: Katharine Kupsky on Friday, May 4, 2018 2:33:25 PM)

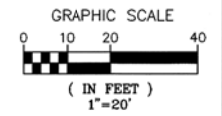

MATCH LINE STA. 39+00.00
SEE SHEET PMS5 FOR CONTINUATION

MATCH LINE STA. 45+00.00
SEE SHEET PMS7 FOR CONTINUATION

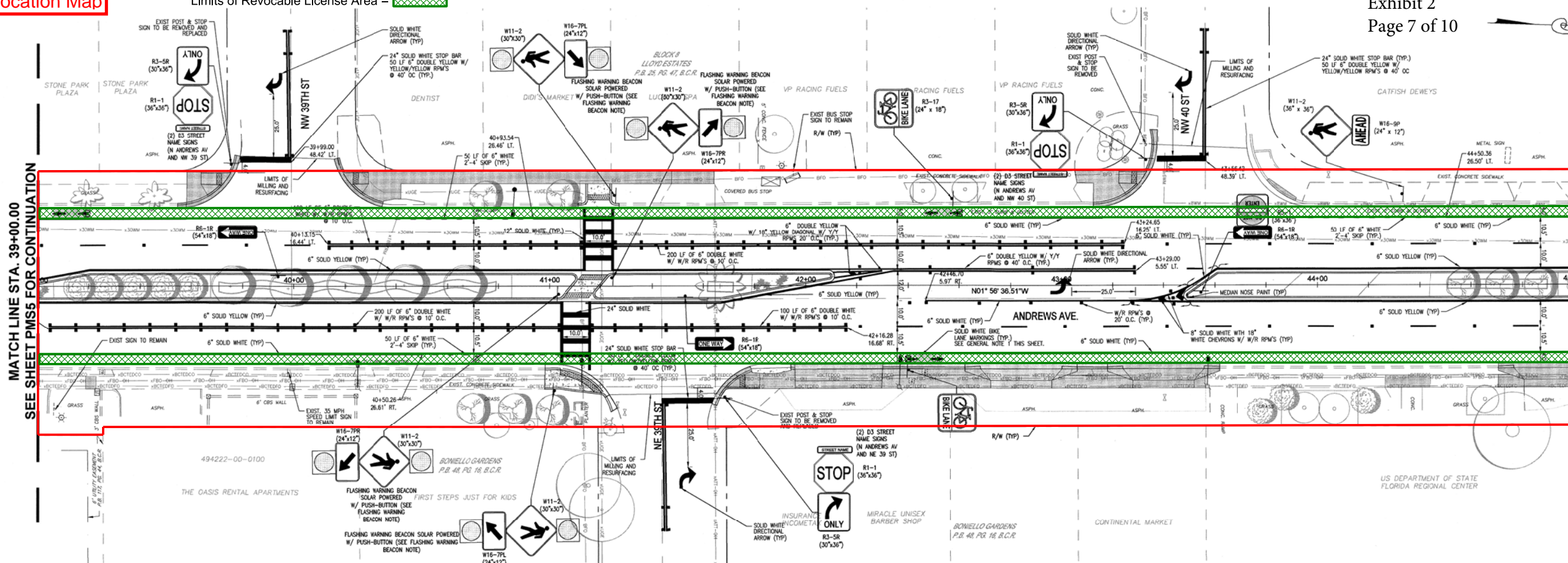

GENERAL NOTE:

- 1. BIKE LANE MARKINGS SHALL BE PER FOOT INDEX 17347. GREEN COLOR MARKING SHALL BE NON-REFLECTIVE AND SHALL MEET THE REQUIREMENTS PER FOOT SPECIFICATION 523, PATTERNED PAVEMENTS, AND PLANS PREPARATION MANUAL, VOL. 1, SECTION 4.2.2, GREEN COLOR BIKE LANE. REFER TO DETAILS PROVIDED ON PMS11 FOR MORE INFORMATION.

LEGEND:

CONCRETE RECONSTRUCTION BY COUNTY

FLASHING WARNING BEACON NOTE:

CONTRACTOR SHALL FAB FLASHING WARNING BEACON SOLAR POWERED WITH PUSH-BUTTON PER FOOT INDEX 11862. CONTRACTOR SHALL SUBMIT SHOP DRAWINGS FOR EOR AND COUNTY APPROVAL PRIOR TO FABRICATION.

THE FOLLOWING ITEMS ARE NOT REVIEWED OR ACCEPTED BY BROWARD COUNTY:

- 1. BROWARD COUNTY TRAFFIC ENGINEERING DIVISION'S REVIEW DOES NOT INCLUDE A REVIEW AND ACCEPTANCE OF THE PROJECT'S DESIGN OR OPERATION. THESE ITEMS ARE TO BE REVIEWED AND APPROVED BY THE CITY ENGINEER.
2. BROWARD COUNTY TRAFFIC ENGINEERING DIVISION DOES NOT REVIEW AND APPROVE, OR INSPECT AND ACCEPT THE FOLLOWING ITEMS FOR MAINTENANCE: PAVEMENT MARKINGS ON OR ADJACENT TO PAVER BRICKS, PAINTED ASPHALT, STAMPED ASPHALT OR PAVEMENT MARKINGS MADE OF PAVER BRICKS, RAISED INTERSECTIONS AND RELATED MARKINGS AND SIGNING, UN-WARRANTED MID-BLOCK CROSSWALKS AND RELATED MARKINGS AND SIGNING, UN-WARRANTED CROSSWALKS AND RELATED MARKINGS AND SIGNING, PAINTED/DECORATIVE CROSSWALKS, RAISED CROSSWALKS AND RELATED MARKINGS AND SIGNING, BLINKER SIGNS, RECTANGULAR RAPID FLASHER BEACONS AND RELATED MARKINGS AND SIGNING, ON-STREET PARKING AND RELATED MARKINGS AND SIGNING, IN-WARRANTED MID-BLOCK CROSSWALKS AND RELATED MARKINGS AND SIGNING, UN-WARRANTED CROSSWALKS AND RELATED MARKINGS AND SIGNING, PAINTED/DECORATIVE CROSSWALKS, RAISED CROSSWALKS AND RELATED MARKINGS AND SIGNING, BLINKER SIGNS, RECTANGULAR RAPID FLASHER BEACONS AND RELATED MARKINGS AND SIGNING, ON-STREET PARKING AND RELATED MARKINGS AND SIGNING, IN-WARRANTED MID-BLOCK CROSSWALKS AND RELATED MARKINGS AND SIGNING, GREEN BIKE LANES, FLEXIBLE DELINEATORS, DECORATIVE SIGNS AND DECORATIVE SIGN POSTS, PLANTERS, ON-SITE PAVEMENT MARKINGS AND SIGNING, OFF-SITE PAVEMENT MARKINGS AND SIGNING IN RIGHT-OF-WAY THAT IS NOT DEDICATED FOR PUBLIC USE, SIDEWALK WORK OR ASPHALT WORK.
3. THE CITY ENGINEER IS RESPONSIBLE FOR THE REVIEW AND APPROVAL OF THE DESIGN AND OPERATION OF THE PROJECT, AND FOR THE INSPECTION AND ACCEPTANCE OF THE FOLLOWING ITEMS THAT WILL BE MAINTAINED BY THE CITY: PAVEMENT MARKINGS ON OR ADJACENT TO PAVER BRICKS, PAINTED ASPHALT, STAMPED ASPHALT OR PAVEMENT MARKINGS MADE OF PAVER BRICKS, RAISED INTERSECTIONS AND RELATED MARKINGS AND SIGNING, UN-WARRANTED MID-BLOCK CROSSWALKS AND RELATED MARKINGS AND SIGNING, UN-WARRANTED CROSSWALKS AND RELATED MARKINGS AND SIGNING, PAINTED/DECORATIVE CROSSWALKS, RAISED CROSSWALKS AND RELATED MARKINGS AND SIGNING, BLINKER SIGNS, RECTANGULAR RAPID FLASHER BEACONS AND RELATED MARKINGS AND SIGNING, ON-STREET PARKING AND RELATED MARKINGS AND SIGNING, IN-WARRANTED MID-BLOCK CROSSWALKS AND RELATED MARKINGS AND SIGNING, UN-WARRANTED CROSSWALKS AND RELATED MARKINGS AND SIGNING, PAINTED/DECORATIVE CROSSWALKS, RAISED CROSSWALKS AND RELATED MARKINGS AND SIGNING, BLINKER SIGNS, RECTANGULAR RAPID FLASHER BEACONS AND RELATED MARKINGS AND SIGNING, ON-STREET PARKING AND RELATED MARKINGS AND SIGNING, IN-WARRANTED MID-BLOCK CROSSWALKS AND RELATED MARKINGS AND SIGNING, GREEN BIKE LANES, FLEXIBLE DELINEATORS, DECORATIVE SIGNS AND DECORATIVE SIGN POSTS, PLANTERS, ON-SITE PAVEMENT MARKINGS AND SIGNING, OFF-SITE PAVEMENT MARKINGS AND SIGNING IN RIGHT-OF-WAY THAT IS NOT DEDICATED FOR PUBLIC USE, SIDEWALK WORK OR ASPHALT WORK.

PERMIT SET

MUST BE ON JOBSITE AT ALL TIMES DURING CONSTRUCTION
ALL MATERIALS USED AND INSTALLATIONS WITHIN THE PUBLIC RIGHT OF WAY OR EASEMENTS SHALL BE IN ACCORDANCE WITH BROWARD COUNTY HIGHWAY CONSTRUCTION AND ENGINEERING MINIMUM STANDARDS.

NOTE: APPROVAL OF THIS PLAN DOES NOT CONSTITUTE A PERMIT FOR CONSTRUCTION. A PERMIT FOR CONSTRUCTION MUST BE OBTAINED FROM THE BROWARD COUNTY HIGHWAY CONSTRUCTION AND ENGINEERING DIVISION PRIOR TO COMMENCING CONSTRUCTION IN THE PUBLIC RIGHT OF WAY.

NOTICE INSPECTION REQUIRED
24 HRS. PRIOR TO COMMENCING ANY WORK IN THE PUBLIC RIGHT OF WAY CONTACT THE BROWARD COUNTY HIGHWAY CONSTRUCTION AND ENGINEERING DIVISION AT 954-577-4600 FOR INSPECTION

BROWARD COUNTY TRAFFIC ENGINEERING DIVISION

APPROVED

BY: [Signature] DATE: 5/10/18

REMARKS:

APPROVAL IS FOR THE PAVEMENT MARKINGS AND SIGNAGE ONLY AND IS LIMITED TO WORK IN PUBLIC RIGHT-OF-WAY AND DRIVEWAY CONNECTIONS THEREIN.

BROWARD COUNTY HIGHWAY CONSTRUCTION AND ENGINEERING DIVISION

PLAN CONSISTENT WITH PLAT REQUIREMENTS

PUBLIC RIGHT OF WAY APPROVAL FOR PAVING, GRADING AND DRAINAGE

DATE: MAY - 9 2018

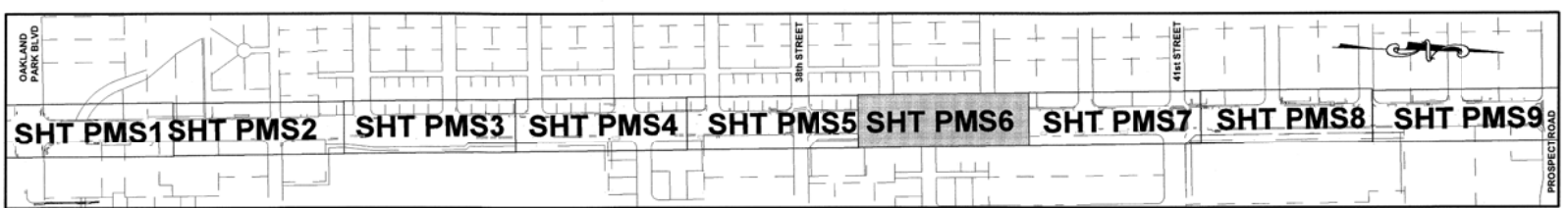

KEY MAP N.T.S.

Table with columns: NO, DATE, REVISION, BY, NO, DATE, REVISION, BY

Table with columns: DESIGNED DATE, CHECKED DATE, ISSUED FOR DATE, NBM 05/16, QJQC 08/16, PHASE 06/16

Calvin, Giordano & Associates, Inc. EXCEPTIONAL SOLUTIONS 1800 Eller Drive, Suite 600, Fort Lauderdale, Florida 33316 Phone: 954.921.7781 - Fax: 954.921.8807 Certificate of Authorization 514

ANDREWS AVENUE ROADWAY IMPROVEMENTS (FROM OAKLAND PARK BLVD. TO PROSPECT ROAD) OAKLAND PARK, FLORIDA

PAVEMENT MARKING AND SIGNAGE PLAN

CONSTRUCTION DOCUMENTS ELEVATIONS ARE NAVD 1988
NICHOLAS B. MANACCA STATE OF FLORIDA PROFESSIONAL ENGINEER LICENSE No. 76291 DATE: MAY 4, 2018

SCALE AS SHOWN PROJECT No 114259.32 PURPOSE OF THIS SET CONSTRUCTION SHEET: PMS6

File Name: P:\Projects\2011\114259_City Of Oakland Park\cadd Files\Drawings\114259_32_Andrews Avenue Roadway Improvements\114259_32_PMS1 Thru PMS9.dwg (Plotted by: Katharine Kupsky on Friday, May 4, 2018 2:33:46 PM)

Limits of County Right-of-Way = [Red Box]
Limits of Revocable License Area = [Green Box]

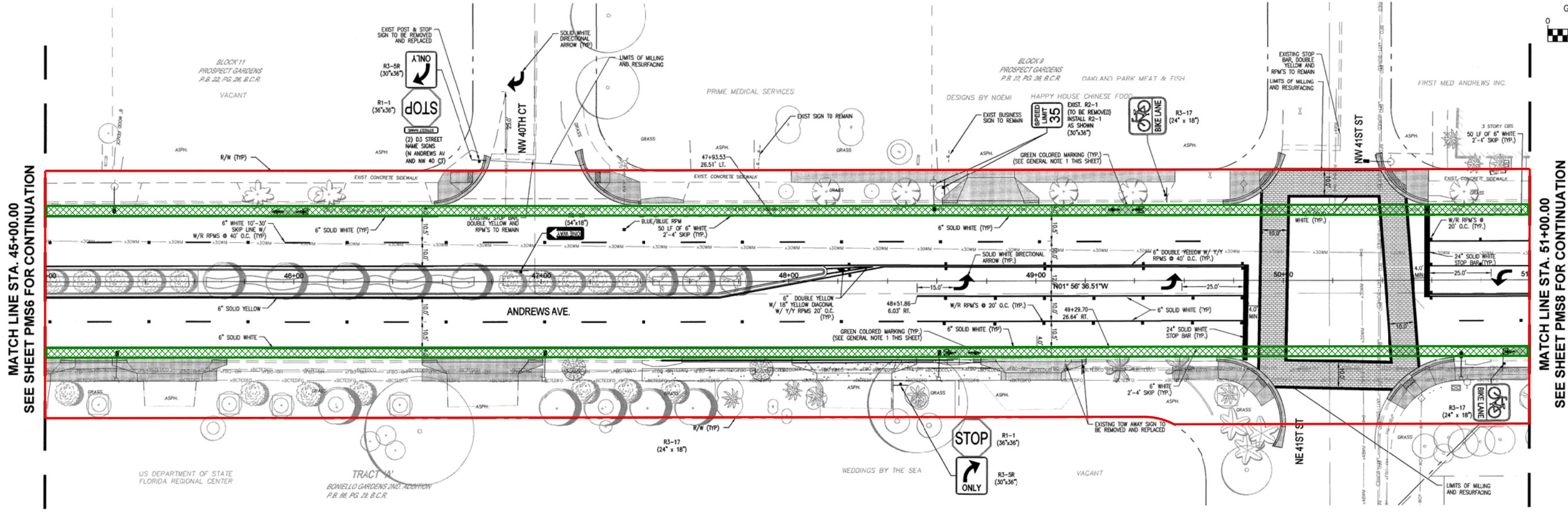
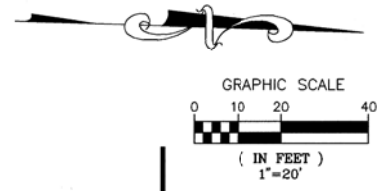

MATCH LINE STA. 45+00.00
SEE SHEET PMS6 FOR CONTINUATION

MATCH LINE STA. 51+00.00
SEE SHEET PMS8 FOR CONTINUATION

GENERAL NOTE:

- 1. BIKE LANE MARKINGS SHALL BE PER FDOT INDEX 17347. GREEN COLOR MARKING SHALL BE NON-REFLECTIVE AND SHALL MEET THE REQUIREMENTS FOR FOOT SPECIFICATION 523, PATTERNED PAVEMENTS, AND PLANS PREPARATION MANUAL, VOL. 1 SECTION 8.4.2.2, GREEN COLOR BICYCLE LANES. REFER TO DETAILS PROVIDED ON PMS11 FOR MORE INFORMATION.

LEGEND:

CONCRETE RECONSTRUCTION BY COUNTY

THE FOLLOWING ITEMS ARE NOT REVIEWED OR ACCEPTED BY BROWARD COUNTY:

- 1. BROWARD COUNTY TRAFFIC ENGINEERING DIVISION'S REVIEW DOES NOT INCLUDE A REVIEW AND ACCEPTANCE OF THE PROJECT'S DESIGN OR OPERATION. THESE ITEMS ARE TO BE REVIEWED AND APPROVED BY THE CITY ENGINEER.
2. BROWARD COUNTY TRAFFIC ENGINEERING DIVISION DOES NOT REVIEW AND APPROVE, OR INSPECT AND ACCEPT THE FOLLOWING ITEMS FOR MAINTENANCE: PAVEMENT MARKINGS ON OR ADJACENT TO PAVED BRICKS, PAINTED ASPHALT, STAMPED ASPHALT OR PAVEMENT MARKINGS MADE OF PAVED BRICKS, RAISED INTERSECTIONS AND RELATED MARKINGS AND SIGNING, UN-WARRANTED MID-BLOCK CROSSWALKS AND RELATED MARKINGS AND SIGNING, UN-WARRANTED CROSSWALKS AND RELATED MARKINGS AND SIGNING, PAINTED/DECORATIVE CROSSWALKS AND RELATED MARKINGS AND SIGNING, BLINKER SIGNS, RECTANGULAR RAPID FLASHER BEACONS AND RELATED MARKINGS AND SIGNING, ON-STREET PARKING AND RELATED MARKINGS AND SIGNING, IN-ROAD LIGHTING AND RELATED MARKINGS AND SIGNING, GREEN BIKE LANES, FLEXIBLE DELINEATORS, DECORATIVE SIGN POSTS, PLANTERS, ON-SITE PAVEMENT MARKINGS AND SIGNING, OFF-SITE PAVEMENT MARKINGS AND SIGNING IN RIGHT-OF-WAY THAT IS NOT DEDICATED FOR PUBLIC USE, SIDEWALK WORK OR ASPHALT WORK.
3. THE CITY ENGINEER IS RESPONSIBLE FOR THE REVIEW AND APPROVAL OF THE DESIGN AND OPERATION OF THE PROJECT, AND FOR THE INSPECTION AND ACCEPTANCE OF THE FOLLOWING ITEMS THAT WILL BE MAINTAINED BY THE CITY: PAVEMENT MARKINGS ON OR ADJACENT TO PAVED BRICKS, PAINTED ASPHALT, STAMPED ASPHALT OR PAVEMENT MARKINGS MADE OF PAVED BRICKS, RAISED INTERSECTIONS AND RELATED MARKINGS AND SIGNING, UN-WARRANTED MID-BLOCK CROSSWALKS AND RELATED MARKINGS AND SIGNING, UN-WARRANTED CROSSWALKS AND RELATED MARKINGS AND SIGNING, PAINTED/DECORATIVE CROSSWALKS, RAISED CROSSWALKS AND RELATED MARKINGS AND SIGNING, BLINKER SIGNS, RECTANGULAR RAPID FLASHER BEACONS AND RELATED MARKINGS AND SIGNING, ON-STREET PARKING AND RELATED MARKINGS AND SIGNING, IN-ROAD LIGHTING AND RELATED MARKINGS AND SIGNING, GREEN BIKE LANES, FLEXIBLE DELINEATORS, DECORATIVE SIGN POSTS, PLANTERS, ON-SITE PAVEMENT MARKINGS AND SIGNING, OFF-SITE PAVEMENT MARKINGS AND SIGNING IN RIGHT-OF-WAY THAT IS NOT DEDICATED FOR PUBLIC USE, SIDEWALK WORK AND ASPHALT WORK.

PERMIT SET

MUST BE ON JOBSITE AT ALL TIMES DURING CONSTRUCTION
ALL MATERIALS USED AND INSTALLATIONS WITHIN THE PUBLIC RIGHT OF WAY OR EASEMENTS SHALL BE IN ACCORDANCE WITH BROWARD COUNTY HIGHWAY CONSTRUCTION AND ENGINEERING MINIMUM STANDARDS.
NOTE: APPROVAL OF THIS PLAN DOES NOT CONSTITUTE A PERMIT FOR CONSTRUCTION. A PERMIT FOR CONSTRUCTION MUST BE OBTAINED FROM THE BROWARD COUNTY HIGHWAY CONSTRUCTION AND ENGINEERING DIVISION PRIOR TO COMMENCING CONSTRUCTION IN THE PUBLIC RIGHT OF WAY.

NOTICE OF INSPECTION REQUIRED

24 HRS. PRIOR TO COMMENCING ANY WORK IN THE PUBLIC RIGHT OF WAY CONTACT THE BROWARD COUNTY HIGHWAY CONSTRUCTION AND ENGINEERING DIVISION AT 954-577-4600 FOR INSPECTION

BROWARD COUNTY TRAFFIC ENGINEERING DIVISION
APPROVED
DATE: 5/16/18

BROWARD COUNTY HIGHWAY CONSTRUCTION AND ENGINEERING DIVISION
PLAN CONSISTENT WITH PLAT REQUIREMENTS
PUBLIC RIGHT OF WAY APPROVAL FOR PAVING, GRADING AND DRAINAGE

APPROVAL IS FOR THE PAVEMENT MARKINGS AND SIGNAGE ONLY AND IS LIMITED TO WORK IN PUBLIC RIGHT-OF-WAY AND DRIVEWAY CONNECTIONS THERE TO

DATE: MAY - 9 2018

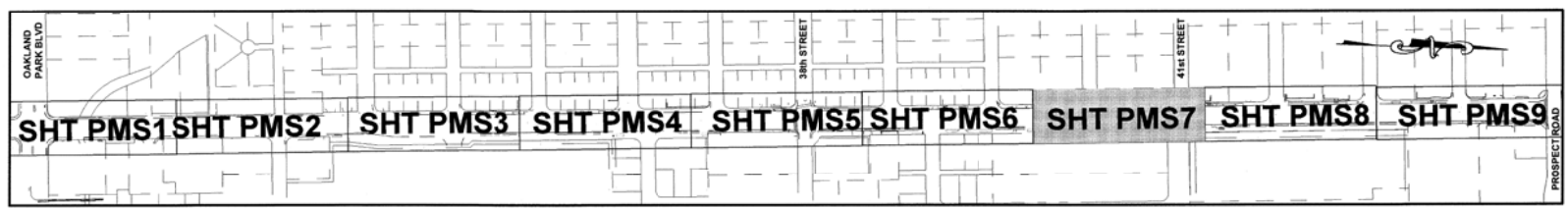

KEY MAP N.T.S.

Table with columns: NO, DATE, REVISION, BY, NO, DATE, REVISION, BY

DESIGNED DATE: NEM 05/16
CHECKED DATE: QAQC 08/16
ISSUED FOR DATE: PHASE 08/16
Calvin, Giordano & Associates, Inc.
EXCEPTIONAL SOLUTIONS
1800 Elcor Drive, Suite 600, Fort Lauderdale, Florida 33316
Phone: 954.921.7781 - Fax: 954.921.8807
Certificate of Authorization 514

ANDREWS AVENUE ROADWAY IMPROVEMENTS
(FROM OAKLAND PARK BLVD. TO PROSPECT ROAD)
OAKLAND PARK, FLORIDA

PAVEMENT MARKING AND SIGNAGE PLAN

NICHOLAS B. WATSON P.E.
STATE OF FLORIDA PROFESSIONAL ENGINEER
LICENSE NO. 78361
DATE: MAY 4 2018

SCALE: AS SHOWN
PROJECT NO: 114259.32
PURPOSE OF THIS SET: CONSTRUCTION
SHEET: PMS7

File Name: P:\Projects\2011\114259 City Of Oakland Park\cadd Files\Drawings\114259.32_PMS1 Thru PMS9.dwg - (Plotted by: Katharine Kupsky on Friday, May 4, 2018 2:34:06 PM)

Limits of County Right-of-Way = [Red Box]
Limits of Revocable License Area = [Green Box]

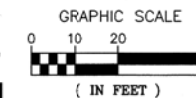

MATCH LINE STA. 51+00.00
SEE SHEET PMS7 FOR CONTINUATION

MATCH LINE STA. 57+00.00
SEE SHEET PMS9 FOR CONTINUATION

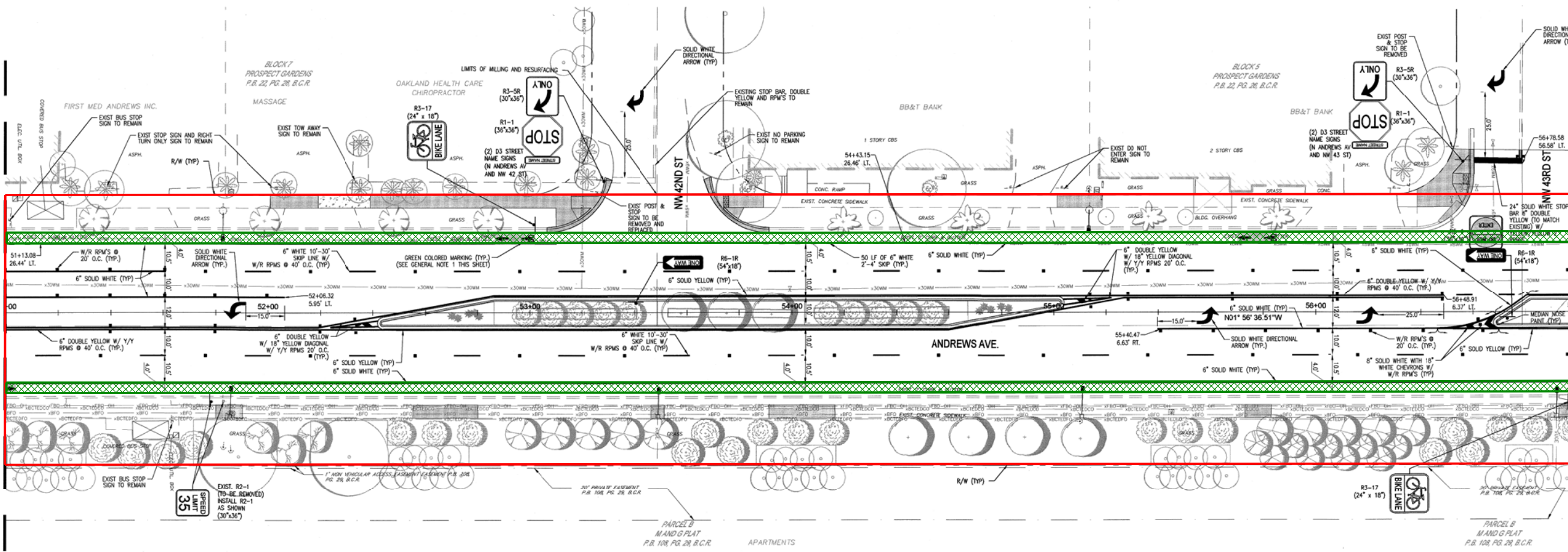

GENERAL NOTE:

- 1. BIKE LANE MARKINGS SHALL BE PER FOOT INDEX 17347. GREEN COLOR MARKING SHALL BE NON-REFLECTIVE AND SHALL MEET THE REQUIREMENTS PER FOOT SPECIFICATION S23, PATTERNED PAVEMENTS, AND PLANS PREPARATION MANUAL, VOL 1 SECTION 8.4.2.2 GREEN COLOR BICYCLE LANES. REFER TO DETAILS PROVIDED ON PMS1 FOR MORE INFORMATION.

LEGEND:



THE FOLLOWING ITEMS ARE NOT REVIEWED OR ACCEPTED BY BROWARD COUNTY:

- 1. BROWARD COUNTY TRAFFIC ENGINEERING DIVISION'S REVIEW DOES NOT INCLUDE A REVIEW AND ACCEPTANCE OF THE PROJECT'S DESIGN OR OPERATION. THESE ITEMS ARE TO BE REVIEWED AND APPROVED BY THE CITY ENGINEER.
2. BROWARD COUNTY TRAFFIC ENGINEERING DIVISION DOES NOT REVIEW AND APPROVE, OR INSPECT AND ACCEPT THE FOLLOWING ITEMS FOR MAINTENANCE: PAVEMENT MARKINGS ON OR ADJACENT TO PAVER BRICKS, PAINTED ASPHALT, STAMPED ASPHALT OR PAVEMENT MARKINGS MADE OF PAVER BRICKS, RAISED INTERSECTIONS AND RELATED MARKINGS AND SIGNING, UN-WARRANTED MID-BLOCK CROSSWALKS AND RELATED MARKINGS AND SIGNING, UN-WARRANTED CROSSWALKS AND RELATED MARKINGS AND SIGNING, PAINTED/DECORATIVE CROSSWALKS AND RELATED MARKINGS AND SIGNING, BUNKER SIGNS, RECTANGULAR RAPID FLASHER BEACONS AND RELATED MARKINGS AND SIGNING, ON-STREET PARKING AND RELATED MARKINGS AND SIGNING, IN-ROAD LIGHTING AND RELATED MARKINGS AND SIGNING, GREEN CROSSWALKS AND RELATED MARKINGS AND SIGNING, BUNKER SIGNS, RECTANGULAR RAPID FLASHER BEACONS AND RELATED MARKINGS AND SIGNING, ON-STREET PARKING AND RELATED MARKINGS AND SIGNING, IN-ROAD LIGHTING AND RELATED MARKINGS AND SIGNING, GREEN DIE LANES, FLEXIBLE DELINEATORS, DECORATIVE SIGNS AND DECORATIVE SIGN POSTS, PLANTERS, ON-SITE PAVEMENT MARKINGS AND SIGNING, OFF-SITE PAVEMENT MARKINGS AND SIGNING IN RIGHT-OF-WAY THAT IS NOT DEDICATED FOR PUBLIC USE, SIDEWALK WORK OR ASPHALT WORK.
3. THE CITY ENGINEER IS RESPONSIBLE FOR THE REVIEW AND APPROVAL OF THE DESIGN AND OPERATION OF THE PROJECT, AND FOR THE INSPECTION AND ACCEPTANCE OF THE FOLLOWING ITEMS THAT WILL BE MAINTAINED BY THE CITY: PAVEMENT MARKINGS ON OR ADJACENT TO PAVER BRICKS, PAINTED ASPHALT, STAMPED ASPHALT OR PAVEMENT MARKINGS MADE OF PAVER BRICKS, RAISED INTERSECTIONS AND RELATED MARKINGS AND SIGNING, UN-WARRANTED MID-BLOCK CROSSWALKS AND RELATED MARKINGS AND SIGNING, UN-WARRANTED CROSSWALKS AND RELATED MARKINGS AND SIGNING, PAINTED/DECORATIVE CROSSWALKS AND RELATED MARKINGS AND SIGNING, BUNKER SIGNS, RECTANGULAR RAPID FLASHER BEACONS AND RELATED MARKINGS AND SIGNING, ON-STREET PARKING AND RELATED MARKINGS AND SIGNING, IN-ROAD LIGHTING AND RELATED MARKINGS AND SIGNING, GREEN DIE LANES, FLEXIBLE DELINEATORS, DECORATIVE SIGNS AND DECORATIVE SIGN POSTS, PLANTERS, ON-SITE PAVEMENT MARKINGS AND SIGNING, OFF-SITE PAVEMENT MARKINGS AND SIGNING IN RIGHT-OF-WAY THAT IS NOT DEDICATED FOR PUBLIC USE, SIDEWALK WORK OR ASPHALT WORK.

PERMIT SET

MUST BE ON JOBSITE AT ALL TIMES DURING CONSTRUCTION

ALL MATERIALS USED AND INSTALLATIONS WITHIN THE PUBLIC RIGHT OF WAY OR EASEMENTS SHALL BE IN ACCORDANCE WITH BROWARD COUNTY HIGHWAY CONSTRUCTION AND ENGINEERING MINIMUM STANDARDS.

NOTE: APPROVAL OF THIS PLAN DOES NOT CONSTITUTE A PERMIT FOR CONSTRUCTION. A PERMIT FOR CONSTRUCTION MUST BE OBTAINED FROM THE BROWARD COUNTY HIGHWAY CONSTRUCTION AND ENGINEERING DIVISION PRIOR TO COMMENCING CONSTRUCTION IN THE PUBLIC RIGHT OF WAY.

NOTICE: INSPECTION REQUIRED 24 HRS. PRIOR TO COMMENCING ANY WORK IN THE PUBLIC RIGHT OF WAY CONTACT THE BROWARD COUNTY HIGHWAY CONSTRUCTION AND ENGINEERING DIVISION AT 954-577-4600 FOR INSPECTION

BROWARD COUNTY TRAFFIC ENGINEERING DIVISION
APPROVED
BY: [Signature]
DATE: 5/10/18
REMARKS:
APPROVAL IS FOR THE PAVEMENT MARKINGS AND SIGNAGE ONLY AND IS LIMITED TO WORK IN PUBLIC RIGHT-OF-WAY AND DRIVEWAY CONNECTIONS THERE TO

BROWARD COUNTY HIGHWAY CONSTRUCTION AND ENGINEERING DIVISION
PLAN CONSISTENT WITH PLAT REQUIREMENTS
PUBLIC RIGHT OF WAY APPROVAL FOR PAVING, GRADING AND DRAINAGE
BY: [Signature] DATE: MAY - 9 2018



Table with columns: NO, DATE, REVISION, BY, NO, DATE, REVISION, BY, DESIGNED DATE, CHECKED DATE, ISSUED FOR DATE, NEM 05/15, QAQC 08/15, PHASE 08/15

Calvin, Giordano & Associates, Inc.
EXCEPTIONAL SOLUTIONS
1800 Elzer Drive, Suite 600, Fort Lauderdale, Florida 33316
Phone: 954.921.7781 - Fax: 954.921.8807
Certificate of Authorization 514

ANDREWS AVENUE ROADWAY IMPROVEMENTS
(FROM OAKLAND PARK BLVD. TO PROSPECT ROAD)
OAKLAND PARK, FLORIDA

PAVEMENT MARKING AND SIGNAGE PLAN

NICHOLAS B. WATSON, P.E.
STATE OF FLORIDA PROFESSIONAL ENGINEER
LICENSE No. 78365
DATE: MAY 4 2018

SCALE: AS SHOWN
PROJECT No: 114259.32
PURPOSE OF THIS SET: CONSTRUCTION
SHEET: PMS8

File Name: P:\Projects\2011\114259 City Of Oakland Park\cadd Files\Drawings\114259.32_PMS1 Thru PMS9.dwg (Plotted by: Katharine Kupsky on Monday, May 7, 2018 10:43:56 AM)

Location Map

Limits of County Right-of-Way = [Red Box]
Limits of Revocable License Area = [Green Box]

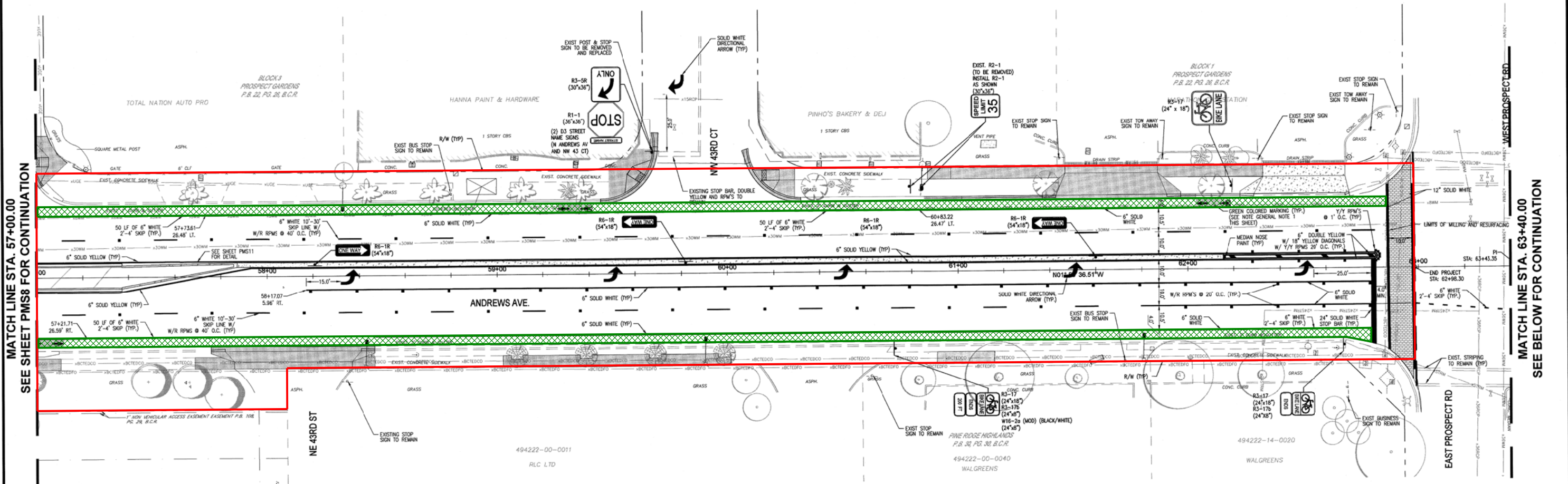
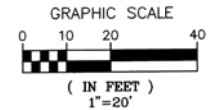

MATCH LINE STA. 57+00.00
SEE SHEET PMS8 FOR CONTINUATION

MATCH LINE STA. 63+40.00
SEE BELOW FOR CONTINUATION

GENERAL NOTE:

- 1. BIKE LANE MARKINGS SHALL BE PER FOOT INDEX 17347. GREEN COLOR MARKING SHALL BE NON-REFLECTIVE AND SHALL MEET THE REQUIREMENTS PER FOOT SPECIFICATION 523, PATTERNED PAVEMENTS, AND PLANS PREPARATION MANUAL, VOL.1 SECTION 8.2.2. GREEN COLOR BICYCLE LANES. REFER TO DETAILS PROVIDED ON PMS11 FOR MORE INFORMATION.

LEGEND:

CONCRETE RECONSTRUCTION BY COUNTY

THE FOLLOWING ITEMS ARE NOT REVIEWED OR ACCEPTED BY BROWARD COUNTY:

- 1. BROWARD COUNTY TRAFFIC ENGINEERING DIVISION'S REVIEW DOES NOT INCLUDE A REVIEW AND ACCEPTANCE OF THE PROJECT'S DESIGN OR OPERATION. THESE ITEMS ARE TO BE REVIEWED AND APPROVED BY THE CITY ENGINEER.
2. BROWARD COUNTY TRAFFIC ENGINEERING DIVISION DOES NOT REVIEW AND APPROVE, OR INSPECT AND ACCEPT THE FOLLOWING ITEMS FOR MAINTENANCE: PAVEMENT MARKINGS ON OR ADJACENT TO PAVER BRICKS, PAINTED ASPHALT, STAMPED ASPHALT OR PAVEMENT MARKINGS MADE OF PAVER BRICKS, RAISED INTERSECTIONS AND RELATED MARKINGS AND SIGNING, UN-WARRANTED MID-BLOCK CROSSWALKS AND RELATED MARKINGS AND SIGNING, UN-WARRANTED CROSSWALKS AND RELATED MARKINGS AND SIGNING, PAINTED/DECORATIVE CROSSWALKS, RAISED CROSSWALKS AND RELATED MARKINGS AND SIGNING, BLANKER SIGNS, RECTANGULAR RAPID FLASHER BEACONS AND RELATED MARKINGS AND SIGNING, ON-STREET PARKING AND RELATED MARKINGS AND SIGNING, IN-ROAD LIGHTING AND RELATED MARKINGS AND SIGNING, GREEN BIKE LANES, FLEXIBLE DELINEATORS, DECORATIVE SIGNS AND DECORATIVE SIGN POSTS, PLANTERS, ON-SITE PAVEMENT MARKINGS AND SIGNING, OFF-SITE PAVEMENT MARKINGS AND SIGNING IN RIGHT-OF-WAY THAT IS NOT DEDICATED FOR PUBLIC USE, SIDEWALK WORK OR ASPHALT WORK.
3. THE CITY ENGINEER IS RESPONSIBLE FOR THE REVIEW AND APPROVAL OF THE DESIGN AND OPERATION OF THE PROJECT, AND FOR THE INSPECTION AND ACCEPTANCE OF THE FOLLOWING ITEMS THAT WILL BE MAINTAINED BY THE CITY: PAVEMENT MARKINGS ON OR ADJACENT TO PAVER BRICKS, PAINTED ASPHALT, STAMPED ASPHALT OR PAVEMENT MARKINGS MADE OF PAVER BRICKS, RAISED INTERSECTIONS AND RELATED MARKINGS AND SIGNING, UN-WARRANTED MID-BLOCK CROSSWALKS AND RELATED MARKINGS AND SIGNING, UN-WARRANTED CROSSWALKS AND RELATED MARKINGS AND SIGNING, PAINTED/DECORATIVE CROSSWALKS, RAISED CROSSWALKS AND RELATED MARKINGS AND SIGNING, BLANKER SIGNS, RECTANGULAR RAPID FLASHER BEACONS AND RELATED MARKINGS AND SIGNING, ON-STREET PARKING AND RELATED MARKINGS AND SIGNING, IN-ROAD LIGHTING AND RELATED MARKINGS AND SIGNING, GREEN BIKE LANES, FLEXIBLE DELINEATORS, DECORATIVE SIGNS AND DECORATIVE SIGN POSTS, PLANTERS, ON-SITE PAVEMENT MARKINGS AND SIGNING, OFF-SITE PAVEMENT MARKINGS AND SIGNING IN RIGHT-OF-WAY THAT IS NOT DEDICATED FOR PUBLIC USE, SIDEWALK WORK AND ASPHALT WORK.

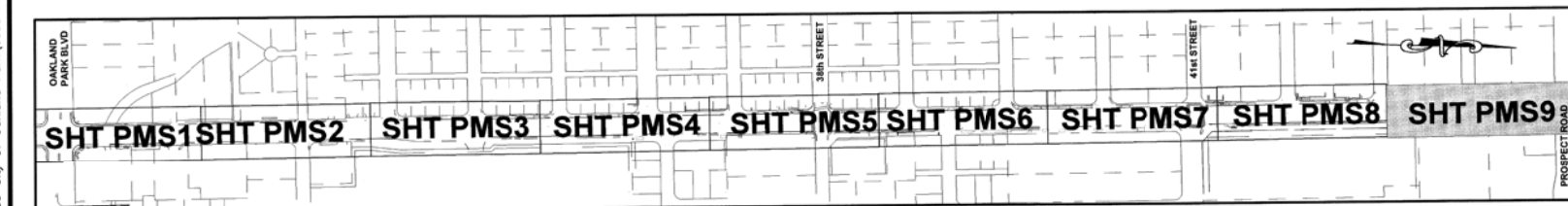

KEY MAP N.T.S.

MATCH LINE STA. 63+40.00
SEE ABOVE FOR CONTINUATION

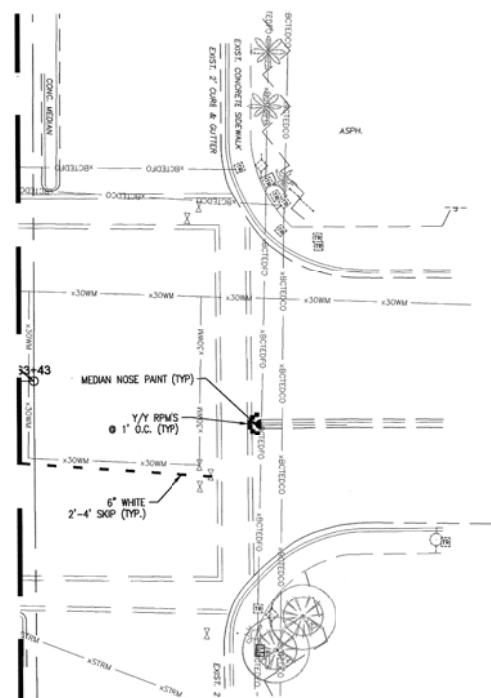

PERMIT SET

MUST BE ON JOBSITE AT ALL TIMES DURING CONSTRUCTION

ALL MATERIALS USED AND INSTALLATIONS WITHIN THE PUBLIC RIGHT OF WAY OR EASEMENTS SHALL BE IN ACCORDANCE WITH BROWARD COUNTY HIGHWAY CONSTRUCTION AND ENGINEERING MINIMUM STANDARDS.

NOTE: APPROVAL OF THIS PLAN DOES NOT CONSTITUTE A PERMIT FOR CONSTRUCTION. A PERMIT FOR CONSTRUCTION MUST BE OBTAINED FROM THE BROWARD COUNTY HIGHWAY CONSTRUCTION AND ENGINEERING DIVISION PRIOR TO COMMENCING CONSTRUCTION IN THE PUBLIC RIGHT OF WAY.

NOTICE INSPECTION REQUIRED 24 HRS. PRIOR TO COMMENCING ANY WORK IN THE PUBLIC R/W CONTACT THE BROWARD COUNTY HIGHWAY CONSTRUCTION AND ENGINEERING DIVISION AT 954-577-4800 FOR INSPECTION

BROWARD COUNTY TRAFFIC ENGINEERING DIVISION

APPROVED

BY: [Signature] DATE: 5/9/18

REMARKS: APPROVAL IS FOR THE PAVEMENT MARKINGS AND SIGNAGE ONLY AND IS LIMITED TO WORK IN PUBLIC RIGHT-OF-WAY AND DRIVEWAY CONNECTIONS THERETO

BROWARD COUNTY HIGHWAY CONSTRUCTION AND ENGINEERING DIVISION

PLAN CONSIST WITH PLAT REQUIREMENTS

PUBLIC RIGHT OF WAY APPROVAL FOR PAVING, GRADING AND DRAINAGE

BY: [Signature] DATE: MAY - 9 2018

CONSTRUCTION DOCUMENTS ELEVATIONS ARE NAVD 1988

NICHOLAS B. MAHON, P.E. STATE OF FLORIDA PROFESSIONAL ENGINEER LICENSE No. 78366 DATE: MAY 4, 2018

SCALE AS SHOWN PROJECT No 114259.32 PURPOSE OF THIS SET CONSTRUCTION SHEET: PMS9

Table with columns: NO, DATE, REVISION, BY, NO, DATE, REVISION, BY. Includes a revision history section.

Calvin, Giordano & Associates, Inc. EXCEPTIONAL SOLUTIONS 1800 Eller Drive, Suite 600, Fort Lauderdale, Florida 33316 Phone: 954.921.7781 - Fax: 954.921.8807 Certificate of Authorization 514

ANDREWS AVENUE ROADWAY IMPROVEMENTS (FROM OAKLAND PARK BLVD. TO PROSPECT ROAD) OAKLAND PARK, FLORIDA

PAVEMENT MARKING AND SIGNAGE PLAN

CONSTRUCTION DOCUMENTS ELEVATIONS ARE NAVD 1988 SHEET: PMS9

File Name: P:\Projects\2011\114259 City of Oakland Park\cadd Files\Drawings\114259.32 Andrews Avenue Roadway Improvements\114259.32_PMS1 Thru PMS9.dwg - (Plotted by: Katherine Kupsky on Monday, May 7, 2018 10:44:23 AM)