



DEPARTMENT OF PLANNING AND ENVIRONMENTAL PROTECTION - Biological Resources Division
218 S.W. 1st Avenue • Fort Lauderdale, Florida 33301 • 954-519-1230 • FAX 954-519-1412

June 21, 2002

Philip Jimrusti
Philip R. Jimrusti & Associates, Inc.
12730 SW 12 Court
Davie, FL 33325

Re: Miramar Park of Commerce - Phase V
DPEP License #DF 01-1072 Modification

Dear Mr. Jimrusti:

This letter is to inform you that your request to modify the above referenced license is hereby granted. This modification allows for the relocation of the 5.12 acres of multi-habitat wetlands from its originally licensed location. The mitigation will be installed in an existing lake directly adjacent to and south of the mitigation for Phase III, licensed under DPEP License No. DF 96-1018. The attached drawings, stamped June 21, 2002 by this Department, and showing the details of the work, serve to replace drawings 3 of 5 and cross-section C-C on drawing 5 of 5, attached to the originally issued license.

The scope and all other conditions of the License remain the same. Attach this letter and drawings, stamped June 21, 2002 by this Department, to the original License as they become a part thereof.

I have read the terms, conditions, requirements, limitations and restrictions set forth herein. I accept and agree to abide by all such provisions.

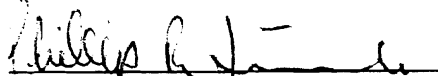

Signature of Applicant

6/14/02
Date

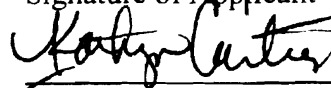

for Eric T. Myers, Director
kc Biological Resources Division

cc: Sunbeam Development Corporation

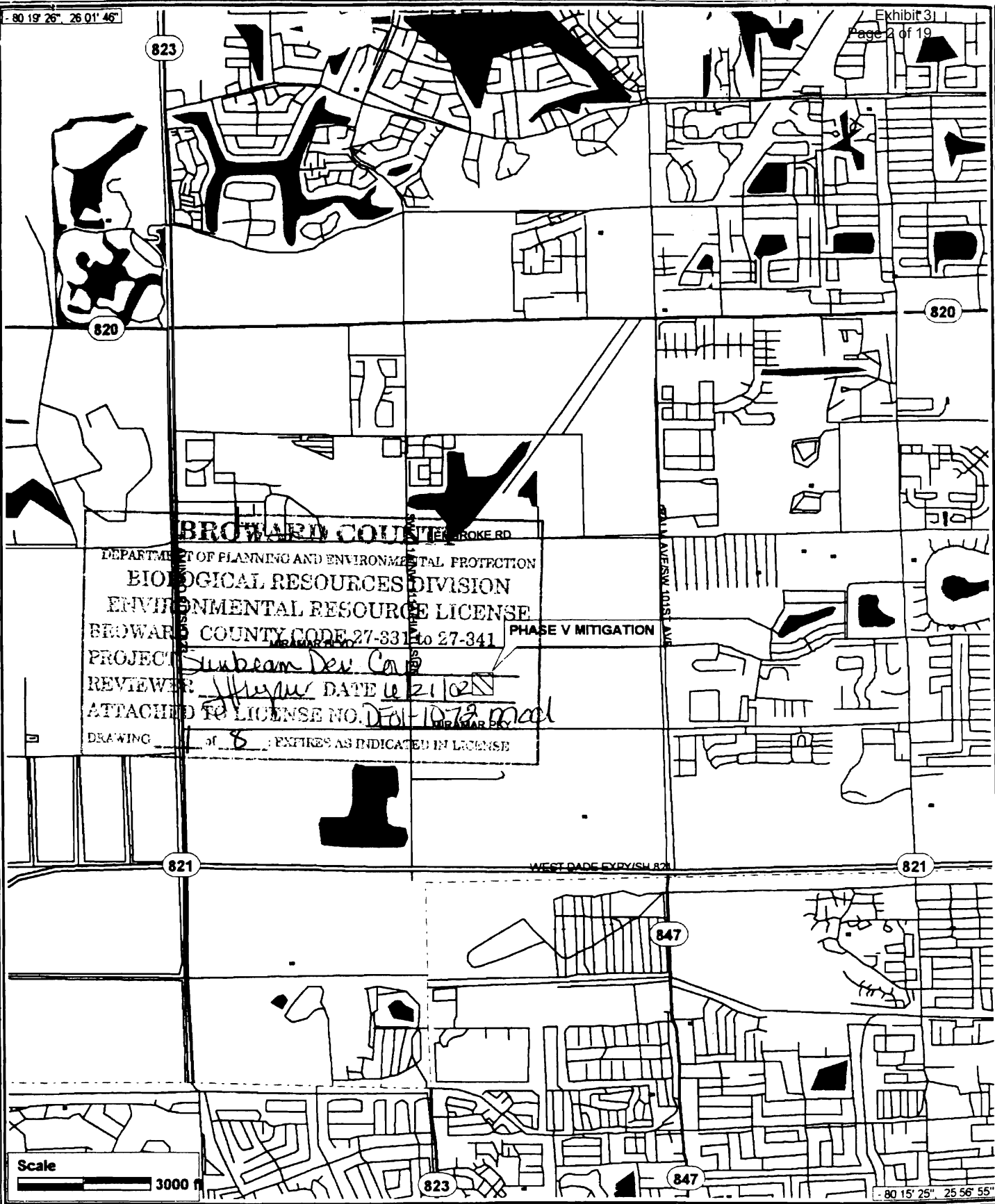

Map created using Precision Mapping 3.0

Copyright 1997, Chicago Map Corporation & TRIUS, Inc.

LOCATION MAP

MIRAMAR PARK OF COMMERCE
 PHASE V MITIGATION
 FOR:
 SUNBEAM PROPERTIES, INC
 MIRAMAR, FLORIDA



PHILLIP R. JIMRUSTI
 & ASSOCIATES, INC.
 ECOLOGICAL ENGINEERS
 ENVIRONMENTAL CONSULTANTS
 12730 S.W. 12th Court
 DAVIE, FLORIDA 33325
 (954) 370-6670

PROJECT No.	102-6
COMP. NAME	PHASE V MOD
FILE NAME	LOC MAP
DATE	12/3/01
SHEET 1 OF 5	

NORTH
1" = 500'



BROWARD COUNTY
DEPARTMENT OF PLANNING AND ENVIRONMENTAL PROTECTION
BIOLOGICAL RESOURCES DIVISION
ENVIRONMENTAL RESOURCE LICENSE
BROWARD COUNTY CODE 27-331 to 27-341
PROJECT 27-1111 (MPOCV) 10/2/00
REVIEWER 5/1/03 DATE 4/23/03
ATTACHED TO LICENSE NO. 102-11
DRAWING 1 EXPIRES AS INDICATED IN LICENSE

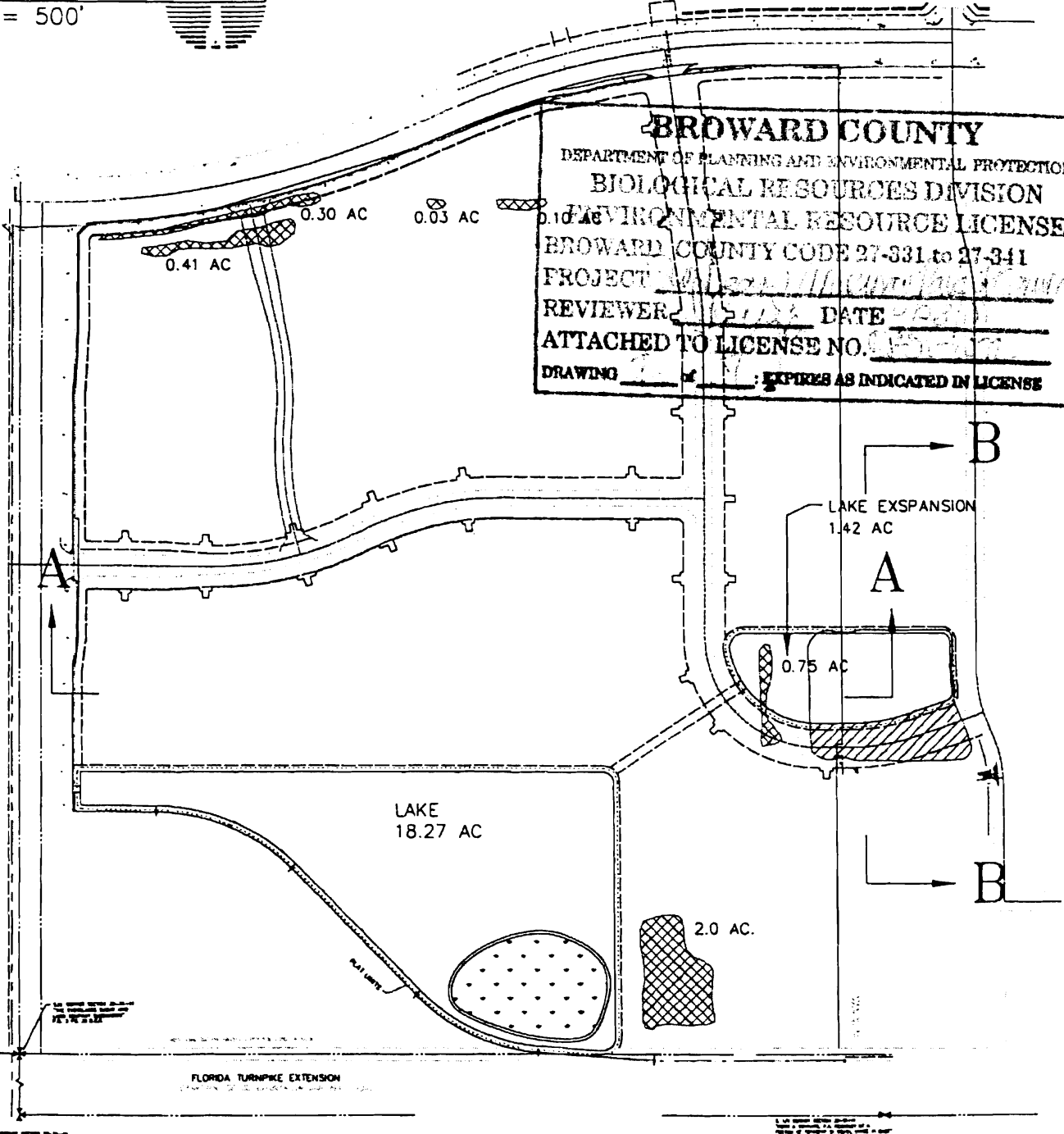

LEGEND

- JURISDICTIONAL WETLANDS 2.75 AC.
- PROPOSED MITIGATION 5.12 AC.
- FILLED OTHER WATERS 1.16 AC.
- TOTAL ACREAGE APPROX. ±144.0 AC

SFWMD

NO. 2	REV.	BY A.S.	TYPE GENERAL	DATE 11/13/00
NO. 1	REV.	BY	TYPE GENERAL	DATE 10/2/00

JURISDICTIONAL WETLANDS

MPOC PHASE V
FOR:
SUNBEAM PROPERTIES
PEMBROKE PINES, FLORIDA
BROWARD COUNTY S30, T51, R41



PHILLIP R. JIMRUSTI
& ASSOCIATES, INC.
ECOLOGICAL ENGINEERS
ENVIRONMENTAL CONSULTANTS
12730 S.W. 12th Court
DAVIE, FLORIDA 33325
(954) 370-8870

PROJECT No. 102-11
COMP. NAME MPOCV
FILE NAME JDSITE
DATE 2/3/00
SHEET 2 OF 5

THIS AREA PREVIOUSLY PERMITTED

SFWMD ON 9/26/96
06-02302-P
BCDNRP ON 10/30/96
DF96-1018
USACOE ON 11/22/96
199100552 (IP-EJ)

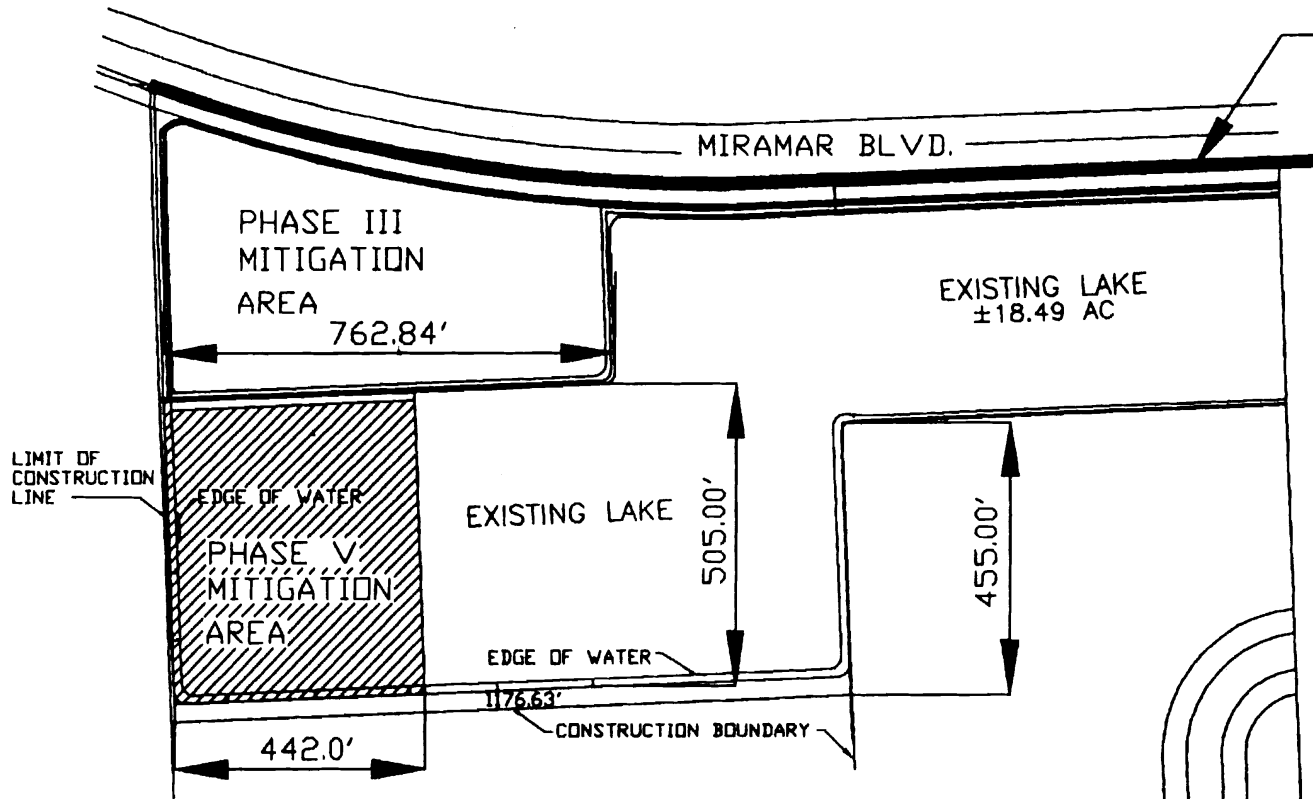

PLAN



LAKE FILL AREA
5.12 ACRES, 80,000 CUBIC YARDS

NORTH



DEPARTMENT OF PLANNING AND ENVIRONMENTAL PROTECTION
BROWARD COUNTY
 BIOLOGICAL RESOURCES DIVISION
 ENVIRONMENTAL RESOURCE LICENSING
 BROWARD COUNTY CODE 27-331 to 27-34
 PROJECT *Sunbeam Dev Corp*
 REVIEWER *Phillip Jimrus* DATE *12/1/02*
 ATTACHED TO LICENSE NO. *DF01-1022100*
 DRAWING *2* of *8* ENTRIES AS INDICATED IN LICENSE

SITE PLAN
MIRAMAR PARK OF COMMERCE
PHASE V MITIGATION
FOR:
SUNBEAM PROPERTIES, INC
MIRAMAR, FLORIDA





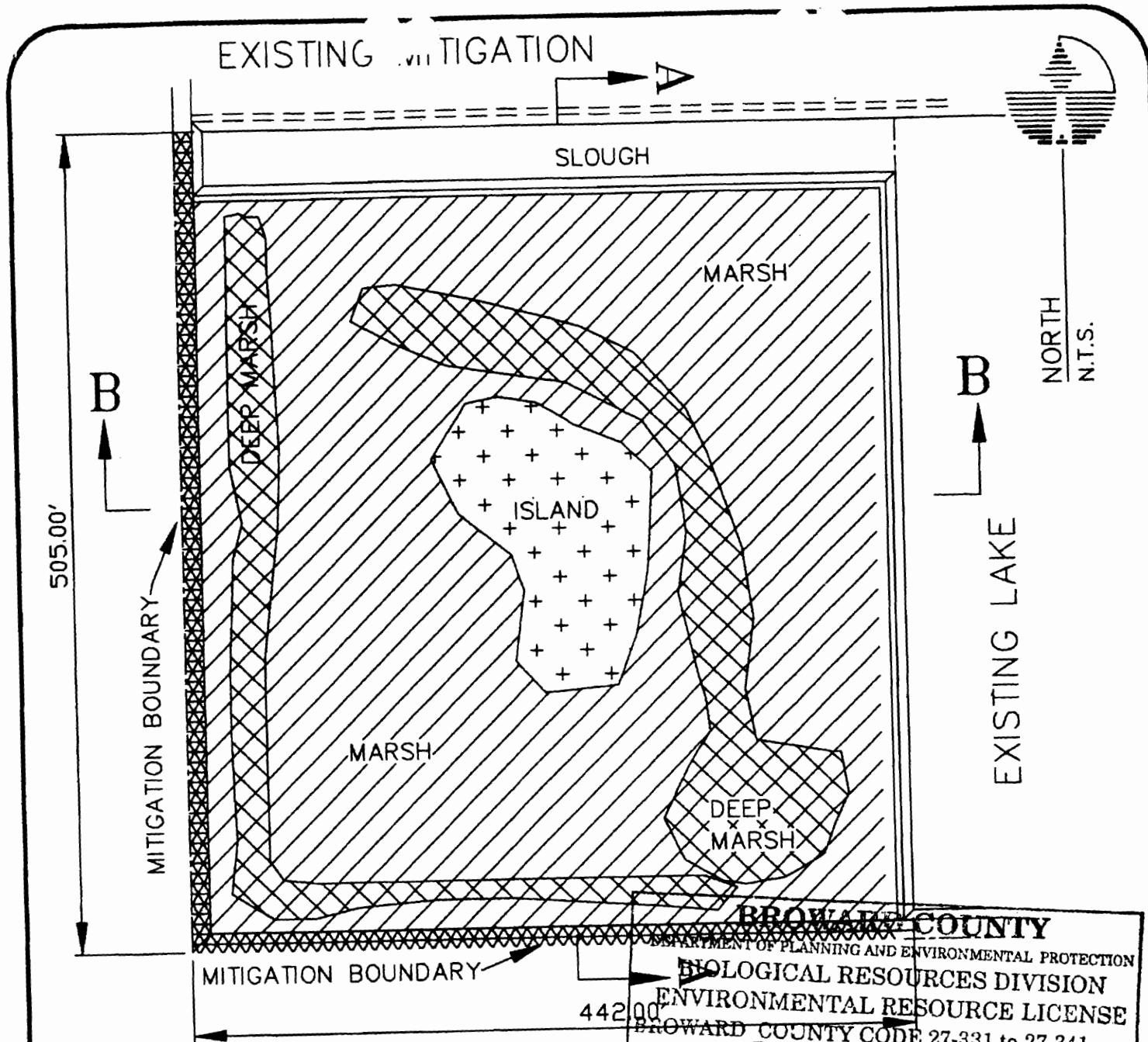

PHILLIP JIMRUS
& ASSOCIATES, INC
ECOLOGICAL ENGINEERS
ENVIRONMENTAL CONSULTANTS
12730 S.W. 12th Court
DAVIE, FLORIDA 33325
(954) 370-8870

PROJECT No.	102-6
COMP. NAME	PHASE V MOD
FILE NAME	SITE
DATE	12/3/01
SHEET	2 OF 5



BROWARD COUNTY
 DEPARTMENT OF PLANNING AND ENVIRONMENTAL PROTECTION
BIOLOGICAL RESOURCES DIVISION
 ENVIRONMENTAL RESOURCE LICENSE
 BROWARD COUNTY CODE 27-331 to 27-341
 PROJECT *Sunbeam Dev. Corp.*
 REVIEWER *[Signature]* DATE *6/21/02*
 ATTACHED TO LICENSE NO. *DF01-1072 Mod*
 DRAWING *3* of *8*; EXPIRES AS INDICATED IN LICENSE

-  MARSH - 3.35 AC.
-  TRANSITIONAL SLOPE - 0.26 AC.
-  DEEP MARSH - 0.83 AC.
-  SLOUGH - 0.32 AC.
-  ISLAND - 0.36 AC.
- TOTAL MITIGATION - 5.12 AC.

MITIGATION PLAN
 MIRAMAR PARK OF COMMERCE
 PHASE V MITIGATION
 FOR:
 SUNBEAM PROPERTIES, INC
 MIRAMAR, FLORIDA



PHILLIP R. JIMRUSTI
 & ASSOCIATES, INC.
 ECOLOGICAL ENGINEERS
 ENVIRONMENTAL CONSULTANTS
 12730 S.W. 12th Court
 DAVIE, FLORIDA 33325
 (954) 370-8870

PROJECT No. 102-6
COMP. NAME PHASE V MOD
FILE NAME SITE
DATE 12/3/01
SHEET 3 OF 5

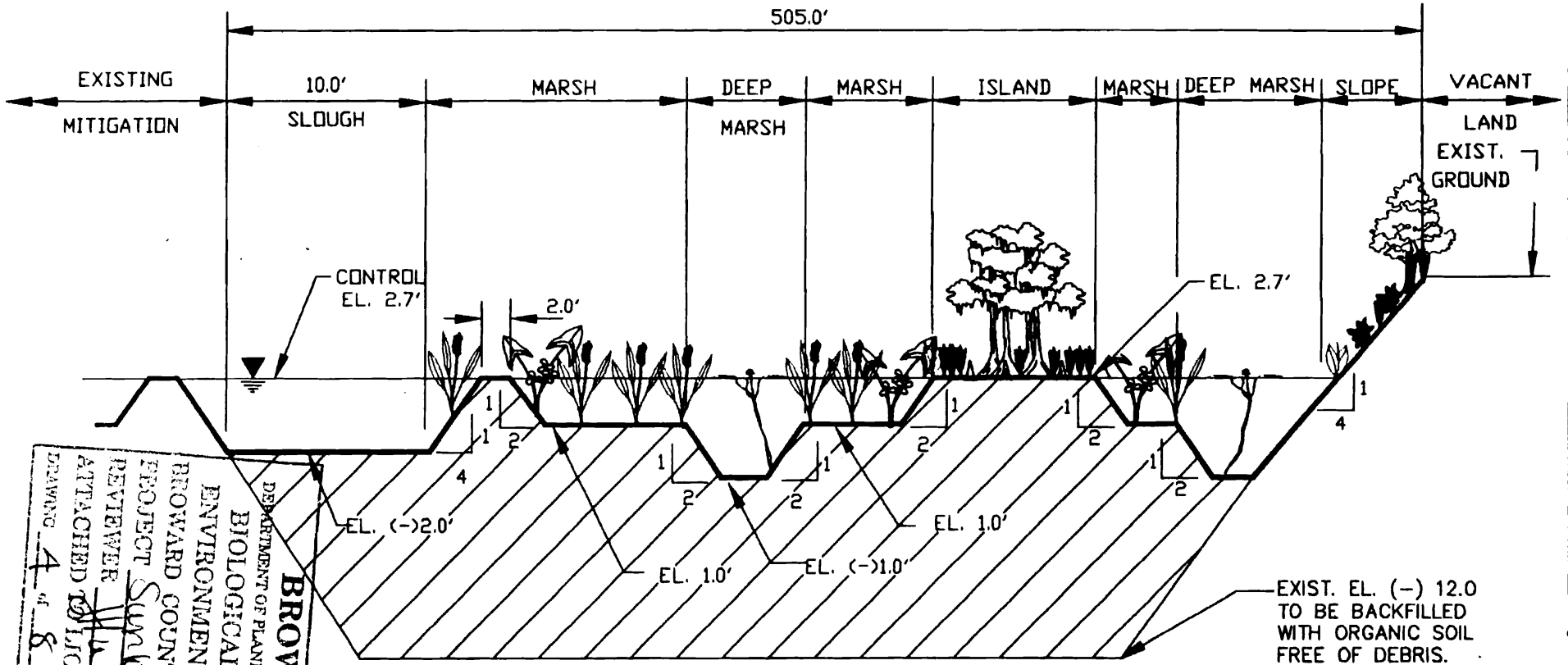

SECTION A-A

BROWARD COUNTY
 DEPARTMENT OF PLANNING AND ENVIRONMENTAL PROTECTION
 BIOLOGICAL RESOURCES DIVISION
 ENVIRONMENTAL RESOURCES DIVISION
 BROWARD COUNTY CODE 27-331 to 27-341
 PROJECT Sunbeam Dam, Dav. Prop.
 REVIEWER [Signature] DATE 12/1/02
 ATTACHED TO LICENSE NO. DEP-1672
 DRAWING 4 of 8 ENGINEERS AS INDICATED IN LICENSE

SECTION A-A
 MIRAMAR PARK OF COMMERCE
 PHASE V MITIGATION
 FOR:
 SUNBEAM PROPERTIES, INC
 MIRAMAR, FLORIDA



PHILLIP R. JIMRUSTI
 & ASSOCIATES, INC.
 ECOLOGICAL ENGINEERS
 ENVIRONMENTAL CONSULTANTS
 12730 S.W. 12th Court
 DAVIE, FLORIDA 33325
 (954) 370-8670

PROJECT No.	102-6
COMP. NAME	PHASE V MOD
FILE NAME	X-SECT
DATE	12/3/01
SHEET	4 OF 5

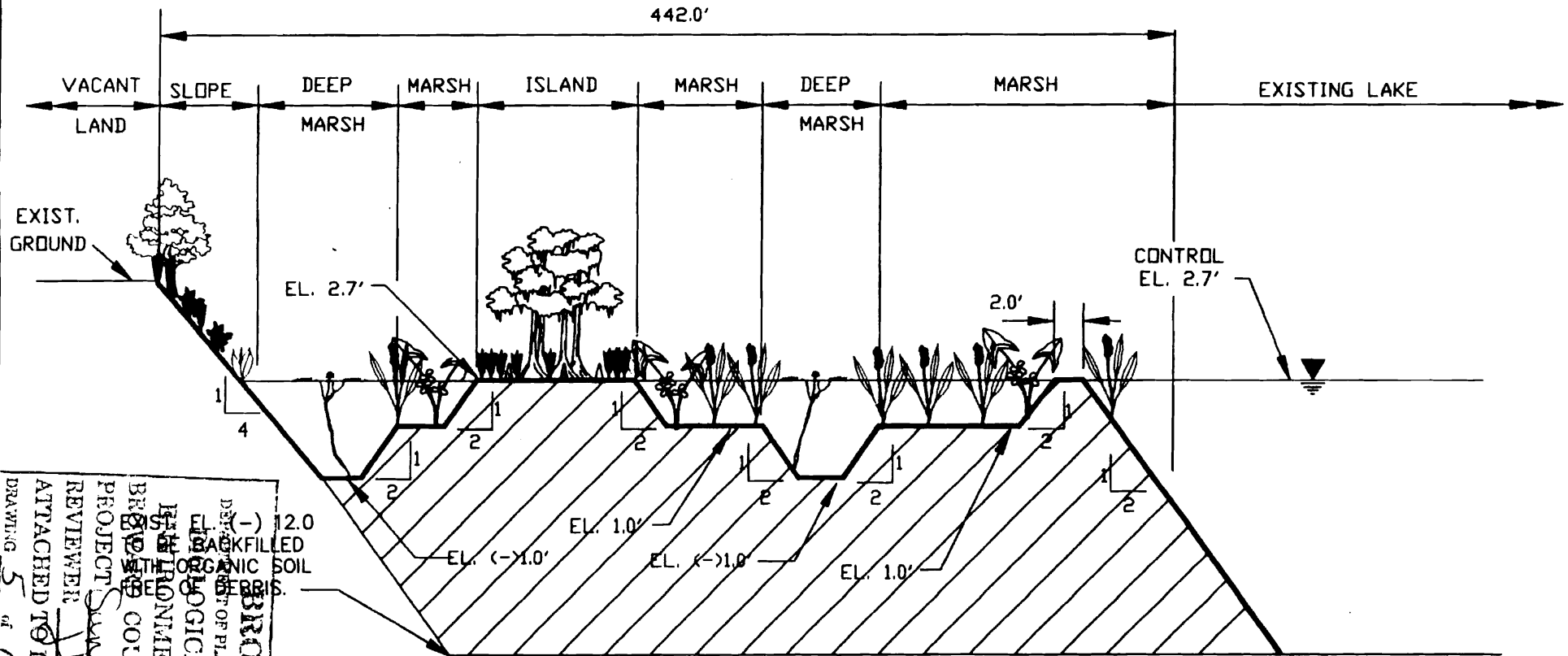

SECTION B-B

DRAWING 5 of 8
 REVIEWER: *[Signature]* DATE: 12/21/02
 PROJECT: *[Signature]*
 BRONX COUNTY CODE 27-331 to 27-341
 ATTACHED TO LICENSE NO. *[Signature]*
 BRONX COUNTY DEPT. OF PLANNING AND ENVIRONMENTAL PROTECTION
 ECOLOGICAL RESOURCES DIVISION
 ENVIRONMENTAL RESOURCE LICENSE

SECTION B-B
 MIRAMAR PARK OF COMMERCE
 PHASE V MITIGATION
 FOR:
 SUNBEAM PROPERTIES, INC
 MIRAMAR, FLORIDA



PHILLIP R. JIMRUSTI
 & ASSOCIATES, INC.
 ECOLOGICAL ENGINEERS
 ENVIRONMENTAL CONSULTANTS
 12730 S.W. 12th Court
 DAVIE, FLORIDA 33325
 (954) 370-8870

PROJECT No. 102-6
 COMP. NAME PHASE V MOD
 FILE NAME X-SECT
 DATE 12/3/01
 SHEET 5 OF 5

MIRAMAR PARK OF COMMERCE - PHASE V

VEGETATION LIST

Select 3 Species Minimum

BROWARD COUNTY	
DEPARTMENT OF PLANNING AND ENVIRONMENTAL PROTECTION	
BIOLOGICAL RESOURCES DIVISION	
ENVIRONMENTAL RESOURCE LICENSE	
BROWARD COUNTY CODE 27-331 to 27-341	
PROJECT	<u>Sumlam Du Cove</u>
REVIEWER	<u>H. W. W.</u> DATE <u>10/21/02</u>
ATTACHED TO LICENSE NO.	<u>DF01-1072 mod</u>
(POND APPLE) 8	EXPIRES AS INDICATED IN LICENSE

Trees: **Elevation - 2.7' NGVD**

- Acer rubrum
- Annona glabra
- Bursera simaruba
- Celtis laevigata
- Chrysophyllum oliviforme
- Coccoloba diversifolia
- Conocarpus erectus
- Ilex cassine
- Magnolia virginiana
- Mastichodendron foetidissimum
- Nyssa sylvatica
- Persea borbonia
- Persea palustris
- Pinus elliotii
- Quercus laurifolia
- Quercus virginiana
- Swietenia mahagoni
- Taxodium distichum

- (GUMBO LIMBO)
- (SUGARBERRY)
- (SATIN LEAF)
- (PIGEON PLUM)
- (GREEN BUTTONWOOD)
- (DAHOON HOLLY)
- (SWEET BAY)
- (MASTIC)
- (BLACK GUM)
- (RED BAY)
- (SWAMP BAY)
- (SLASH PINE)
- (LAUREL OAK)
- (LIVE OAK)
- (MAHOGANY)
- (BALD CYPRESS)

Palms: **Elevation - 2.7' NGVD**

- Acoelorrhaphae (Paurotis) wrightii
- Sabal palmetto
- Serenoa repens
- Thrinax radiata

- (PAUROTIS PALM)
- (CABBAGE PALM)
- (SAW PALMETTO)
- (THATCH PALM)

Shrubs: **Elevation - 2.7' NGVD**

- Baccharis halimifolia
- Bumelia salicifolia
- Callicarpa americana
- Capparis cynophallophora
- Cephalanthus occidentalis
- Chrysobalanus icaco
- Conocarpus erectus var. sericeus
- Eugenia foetida
- Hamelia patens
- Itea virginica
- Myrcianthes fragrans
- Myrica cerifera
- Myrsine floridana
- Psychotria nervosa
- Salix floridana
- Sambucus simpsonii

- (SALT BUSH)
- (WILLOW BUSTIC)
- (BEAUTYBERRY)
- (JAMAICAN CAPER)
- (BUTTON BUSH)
- (COCOPLUM)
- (SILVER BUTTONWOOD)
- (SPANISH STOPPER)
- (FIREBUSH)
- (VIRGINIA WILLOW)
- (SIMPSON STOPPER)
- (WAX MYRTLE)
- (MYRSINE)
- (WILD COFFEE)
- (WILLOW)
- (ELDERBERRY)

MIRAMAR PARK OF COMMERCE - PHASE V

VEGETATION LIST

Page - 2 -

Select 3 Species Minimum

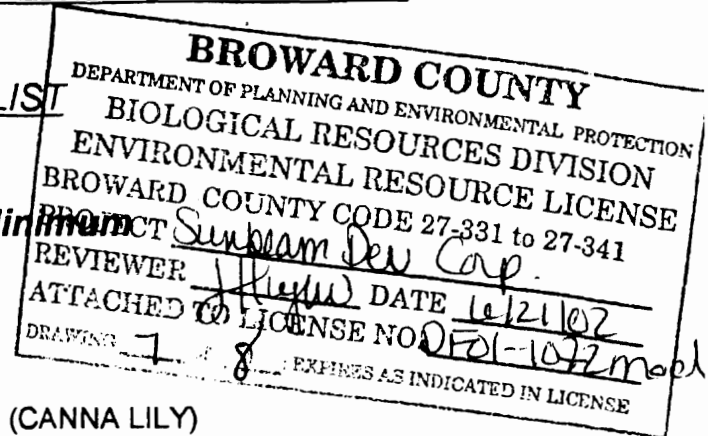

Aquatics: Elevation - 0.0' NGVD to 2.7' NGVD

- | | |
|---------------------------------|-----------------------------|
| <u>Canna flaccida</u> | (CANNA LILY) |
| <u>Cladium jamaicense</u> | (SAWGRASS) |
| <u>Crinum americanum</u> | (SWAMP LILY) |
| <u>Eleocharis cellulosa</u> | (SPIKERUSH) |
| <u>Eleocharis geniculata</u> | (SPIKERUSH) |
| <u>Eleocharis interstincta</u> | (SPIKERUSH) |
| <u>Hymenocallis spp.</u> | (SPIDER LILY) |
| <u>Iris virginica</u> | (BLUE FLAG IRIS) |
| <u>Juncus effusus</u> | (SOFT RUSH) |
| <u>Lachnanthes caroliniana</u> | (RED ROOT) |
| <u>Nymphaea odorata</u> | (FRAGRANT WHITE WATER LILY) |
| <u>Peltandra sagittifolia</u> | (SPOONFLOWER) |
| <u>Peltandra virginica</u> | (ARROW-ARUM) |
| <u>Pontederia cordata</u> | (PICKERELWEED) |
| <u>Sagittaria lancifolia</u> | (ARROWHEAD/DUCK POTATO) |
| <u>Sagittaria latifolia</u> | (COMMON ARROWHEAD) |
| <u>Sagittaria montevidensis</u> | (ARROWHEAD) |
| <u>Sagittaria subulata</u> | (DWARF ARROWHEAD) |
| <u>Scirpus californicus</u> | (GIANT BULRUSH) |
| <u>Scirpus validus</u> | (BULRUSH) |
| <u>Scirpus tabernaemontani</u> | (SOFT-STEM BULRUSH) |

Groundcovers: Elevation - 2.7' NGVD

- | | |
|---------------------------------|----------------------|
| <u>Acrostichum danaeifolium</u> | (LEATHERFERN) |
| <u>Blechnum serrulatum</u> | (SWAMP FERN) |
| <u>Hypericum fasciculatum</u> | (ST. JOHN'S WORT) |
| <u>Kosteletzkya spp.</u> | (MARSH-MALLOW) |
| <u>Muhlenbergia capillaris</u> | (MUHLY GRASS) |
| <u>Nephrolepis biserrata</u> | (SWORD FERN) |
| <u>Nephrolepis exaltata</u> | (BOSTON FERN) |
| <u>Osmunda regalis</u> | (ROYAL FERN) |
| <u>Saururus cernuus</u> | (LIZARD'S TAIL) |
| <u>Spartina alterniflora</u> | (SMOOTH CORDGRASS) |
| <u>Spartina bakeri</u> | (SAND CORDGRASS) |
| <u>Thalia geniculata</u> | (FIREFLAG) |
| <u>Tripsacum dactyloides</u> | (FAKAHATCHEE GRASS) |
| <u>Tripsacum floridanum</u> | (FLORIDA GAMA GRASS) |
| <u>Woodwardia virginica</u> | (CHAIN FERN) |
| <u>Zamia pumila</u> | (COONTIE) |

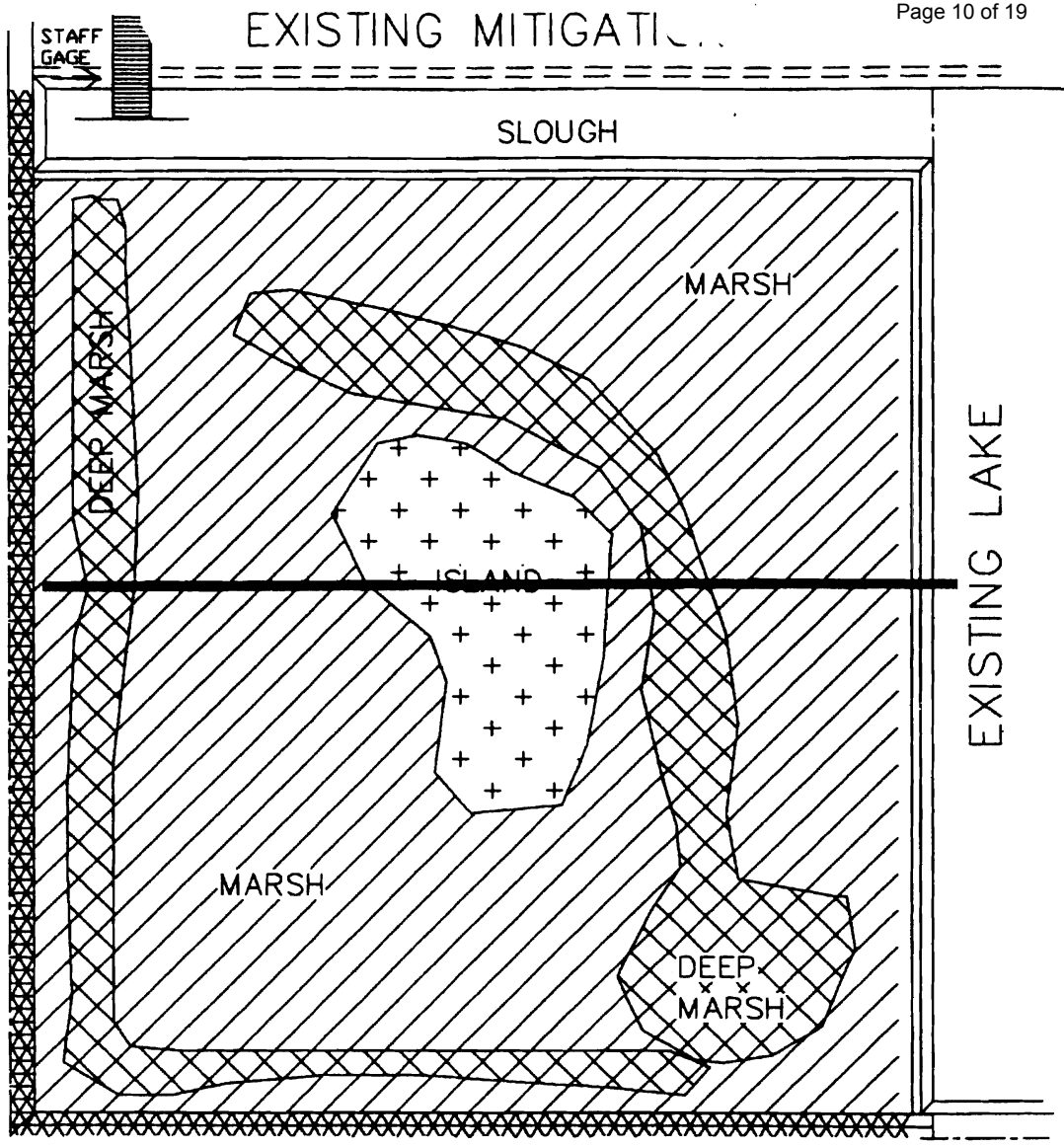

NORTH
N.T.S.

PLAN

BROWARD COUNTY
DEPARTMENT OF PLANNING AND ENVIRONMENTAL PROTECTION
BIOLOGICAL RESOURCES DIVISION
ENVIRONMENTAL RESOURCE LICENSE
BROWARD COUNTY CODE 27-331 to 27-341
PROJECT *Sunbeam Dev. Corp.*
REVIEWER *[Signature]* DATE *12/21/02*
ATTACHED TO LICENSE NO. *DR01-1072 mod*
DRAWING *8* of *8* : EXPIRES AS INDICATED IN LICENSE

LEGEND

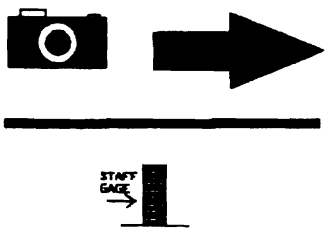



PHOTO POINT
TRANSECT
STAFF GAGE

<p>PHOTO LOCATION MAP MIRAMAR PARK OF COMMERCE PHASE V MITIGATION FOR: SUNBEAM PROPERTIES, INC MIRAMAR, FLORIDA</p>	 <p>PHILLIP R. JIMRUSTI & ASSOCIATES, INC. ECOLOGICAL ENGINEERS ENVIRONMENTAL CONSULTANTS 12730 S.W. 12th Court DAVIE, FLORIDA 33325 (954) 370-8870</p>	<p>PROJECT No. 102-15 COMP. NAME PHASE V MOD FILE NAME PHOTOLOC DATE 12/3/01 SHEET 1 OF 1</p>
---	---	---



Department of Planning and Environmental Protection

Biological Resources Division
218 S.W. 1st Avenue
Fort Lauderdale, FL 33301

(954) 519-1230 • FAX (954) 519-1412

ENVIRONMENTAL RESOURCE LICENSE

LICENSEE:

**SUNBEAM DEVELOPMENT CORPORATION
1401 79TH STREET CAUSEWAY
MIAMI, FLORIDA 33141**

LICENSE NO.: DF01-1072

**PROJECT: MIRAMAR PARK OF
COMMERCE - PHASE V
LAKE EXCAVATION/FILL
WETLAND IMPACT
WETLAND MITIGATION**

This license is issued under the provision of Chapter 27 of the Broward County Code of Ordinances also cited as Broward County Natural Resource Protection Code hereinafter called the Code. The above-named applicant, hereinafter called licensee, is hereby authorized to perform the work or operate the facility shown on the approved drawing(s), plans, documents, and specifications as submitted by applicant, and made a part hereof and specifically described as follows:

Description of Work: The project shall consist of the creation of a 18.27 acre lake by the excavation of 117,902 cubic yards and expansion of a 1.29 acre lakes by the excavation of 91,637 cubic yards of fill material; the filling 1.67 acres of an existing lake; and the filling of 2.52 acres of wetlands with clean fill from the on-site excavation. The lakes shall be excavated to a maximum depth of (-) 40 feet and lake slopes shall be as per attached plans in accordance with Section 27-337(b)(13).

Compensation for impacts to 2.52 acres of herbaceous wetlands shall be in the form of creation of 5.12 acres of multi-habitat wetlands by backfilling the larger lake with on-site muck soils to appropriate wetland elevations per attached drawings.

Location of Work: The project is located east of Red Road, south of Miramar Parkway, City of Miramar, Broward County, Florida, Section 30, Township 51 South, Range 41 East.

Construction shall be in accordance with Application SFWMD Form 0917 and DPEP Addendum both dated 5-25-00; and associated information, all of which is designated as DPEP File No. 00 17475; plans stamped by the Department on 4-23-01 (attached); and with all General and Specific Conditions of this license.

ENVIRONMENTAL RESOURCE LICENSE

GENERAL CONDITIONS

1. The terms, conditions, requirements, limitations and restrictions set forth herein are accepted and must be completed by the licensee and enforceable by the Department of Planning and Environmental Protection (DPEP) pursuant to Chapter 27 of the Broward County Code of Ordinances. The DPEP will review this license periodically and may revoke or suspend the license, and initiate administrative and/or judicial action for any violation of the conditions by the licensee, its agents, employees, servants or representatives.
2. This license is valid only for the specific uses set forth in the license application and any deviation from the approved uses may constitute grounds for revocation, suspension and/or enforcement action by the DPEP.
3. In the event the licensee is temporarily unable to comply with any of the conditions of the license or with the Code, the licensee shall notify the DPEP within eight (8) hours or as stated in the specific section of the Code. Within three (3) working days of the event, the licensee shall submit a written report to the DPEP that describes the incident, its cause, the measures being taken to correct the problem and prevent its reoccurrence, the owner's intention toward repair, replacement, and reconstruction of destroyed facilities, and a schedule of action leading toward operation within the license conditions.
4. The issuance of this license does not convey any vested rights or exclusive privileges, or does it authorize any injury to public or private property or any invasion of personal rights, or any violations of federal, state or local laws or regulations.
5. This license must be available for inspection on licensee's premises during the entire life of the license.
6. By accepting this license, the licensee understands and agrees that all records, notes, monitoring data and other information relating to the construction or operation of this licensed facility or activity that are submitted to the County, may be used by the County as evidence in any enforcement proceeding arising under Chapter 27 of the Broward County Code of Ordinances, except where such use is prohibited by Section 403.111, Florida Statutes.
7. The licensee agrees to comply and shall comply with all provisions of the most current version of the Code.
8. Any new owner of a licensed facility shall apply by letter for a transfer of license within thirty (30) days after the sale or legal transfer. The transferor shall remain liable for performance in accordance with the license until the transferee applies for, and is granted a transfer of license. The transferee shall be liable for any violation of the Code that results from the transferee's activities. The transferee shall comply with the transferor's original license conditions when the transferee has failed to obtain its own license.
9. The licensee, by acceptance of this license, specifically agrees to allow access and shall allow access to the license source at reasonable times by DPEP personnel for the purposes of inspection and testing to determine compliance with this license and Chapter 27, Broward County Code of Ordinances.
10. This license does not constitute a waiver or approval of any other license, approval or regulatory requirement by this or any other governmental agency that may be required.
11. If the licensee wishes to renew the license or extend its term, the licensee shall make application sixty (60) days prior to its expiration including payment of all appropriate fees. Expired licenses are not renewable.

LICENSE NO. DF01-1072
LICENSEE: SUNBEAM DEVELOPMENT CORPORATION
PROJECT: MIRAMAR PARK OF COMMERCE - PHASE V

SPECIFIC CONDITIONS:

A. Standard

1. **Notify the Department in writing a minimum of 48 hours prior to project commencement and a maximum of 48 hours after project completion. Failure to comply with this condition will result in enforcement action.**
2. Any project caused environmental problem(s) shall be reported immediately to the DPEP Environmental Response Line at 954-519-1499.
3. All project generated solid waste and/or spoil material must be disposed of in a suitable approved manner at an upland location.
4. Turbidity screens or equivalent shall be properly employed and maintained as necessary during construction activities so that turbidity levels do not exceed 29 NTU's above natural background 50 feet downstream of point of discharge. If turbidity levels exceed these limits, project activities shall immediately cease, and work shall not resume until turbidity levels drop to within these limits [62-302.530(70) FAC].
5. Any water bodies or wetlands to be filled pursuant to this license must be filled only with rock, soil or muck, as appropriate and depicted on the attached drawings dated 4-23-01 by the Department. Fill material which includes clean debris as defined in Section 27-214 is not authorized by this license. Use as fill of any materials other than rock, soil or muck shall constitute a violation of this license.
6. Notify the Department in writing within 48 hours from completion of final grading of the lake excavations.
7. Within thirty (30) days after the final grading of the lake slopes and before receiving a Certificate of Occupancy for any structure adjacent to the licensed lake, the licensee shall submit to the Department a letter, sealed by a Florida-licensed professional engineer, certifying that the slopes have been surveyed and noting whether they are in compliance with the licensed plans.

B. Compensatory Mitigation (Area)

1. Construction and installation of the Area shall be in accordance with plans dated 4-23-01 by the Department (attached) and associated information. The Area shall be installed concurrently with licensed construction.
2. Upon completion of the Area, the following documentation shall be submitted to the Department: (a) certification of elevations in relation to design, (b) verification of actual acreage, and (c) the time-zero monitoring report. This documentation is required within 30 days of completion of the Area and prior to any Certificate of Occupancy being received for any structure on the site.
3. A viable wetland system shall be established that replicates a natural reference wetland in basic structure and function. In order to assure that the Area becomes self-sustaining, the following criteria shall be met:
 - a) A minimum of 80% coverage by desirable wetland species after a two (2) year period and demonstration of persistence for three (3) additional years.
 - b) Less than 2% coverage by invasive exotic and undesirable species is allowable if plants are dispersed and not concentrated in any particular area. Exotic and undesirable species include, but are not limited to, melaleuca, Australian pine, Brazilian pepper, bischofia, torpedo grass, primrose-willow, and cattail. Treatment efforts must be tailored to prevent these species from becoming reproductively mature.

LICENSE NO. DF01-1072
LICENSEE: SUNBEAM DEVELOPMENT CORPORATION
PROJECT: MIRAMAR PARK OF COMMERCE - PHASE V

- c) A minimum of 80% survival of each planted species. This rate shall be maintained each quarter except where species composition, density of planted and recruitment species and overall wetland condition, growth rates and viability of the Area are of higher quality, as determined by the Department.
- d) Hydrologic conditions and soil characteristics are in general conformity to those specified in plans. Data from the permanent surveyed staff gauges must be collected every two weeks and submitted with the quarterly monitoring reports.
- e) Any preserved or planted species shall be maintained as to exhibit new growth and/or propagation, viability, and overall health.

The Area shall be monitored and reports submitted quarterly for five (5) years describing in detail the condition of the Area relative to the reference wetland and the criteria listed above (B. 3.a-e).

- 4. Should the Department determine that the Area is not achieving the listed criteria during some portion of the monitoring period, the licensee shall prepare plans that demonstrate clearly how the problem(s) will be corrected and submit such plans immediately to the Department for approval. Those plans shall then be implemented within thirty (30) days of the Department's written approval.
- 5. A Conservation Easement and a Surety Bond (SB) for \$64,746 have been submitted by the applicant. Should either of these documents be unacceptable to the County Attorney's Office or the County Commission, a replacement document shall be submitted in a form acceptable to the Department, the County Attorney's Office and the Commission within thirty (30) days of the Department's written notification that the document was unacceptable.
- 6. The SB includes construction, planting, monitoring and maintenance costs. Upon DPEP review and approval of all information required in Specific Condition B. 2, the licensee may request the release of the construction and planting portion of the SB, which totals \$37,246. After the five year maintenance and monitoring period has elapsed and upon demonstration that the licensee has met the intent and all information requested in Specific Conditions B.3 and 4 and if necessary B.5, the licensee may request the release of the monitoring and maintenance portion of the SB, which totals \$27,500. All requests shall be made in writing to the Wetlands Resources Section of DPEP.

C. A COPY OF THIS LICENSE SHALL BE KEPT ON SITE DURING ALL PHASES OF LICENSED CONSTRUCTION.

Recommended for approval by:

Reviewed by:

License Processor

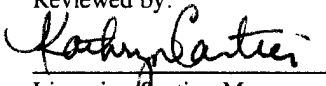
Licensing Section Manager

I have read the terms, conditions, requirements, limitations and restrictions set forth herein. I accept and agree to abide by all such provisions.

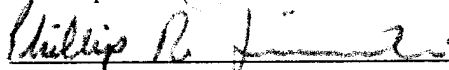

Signature (Licensee or authorized agent)



Date

Issued this 24 day of July, 2001

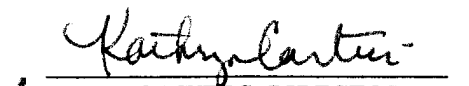
Expiration Date: 7/24/2006

BROWARD COUNTY DEPARTMENT OF PLANNING AND ENVIRONMENTAL PROTECTION

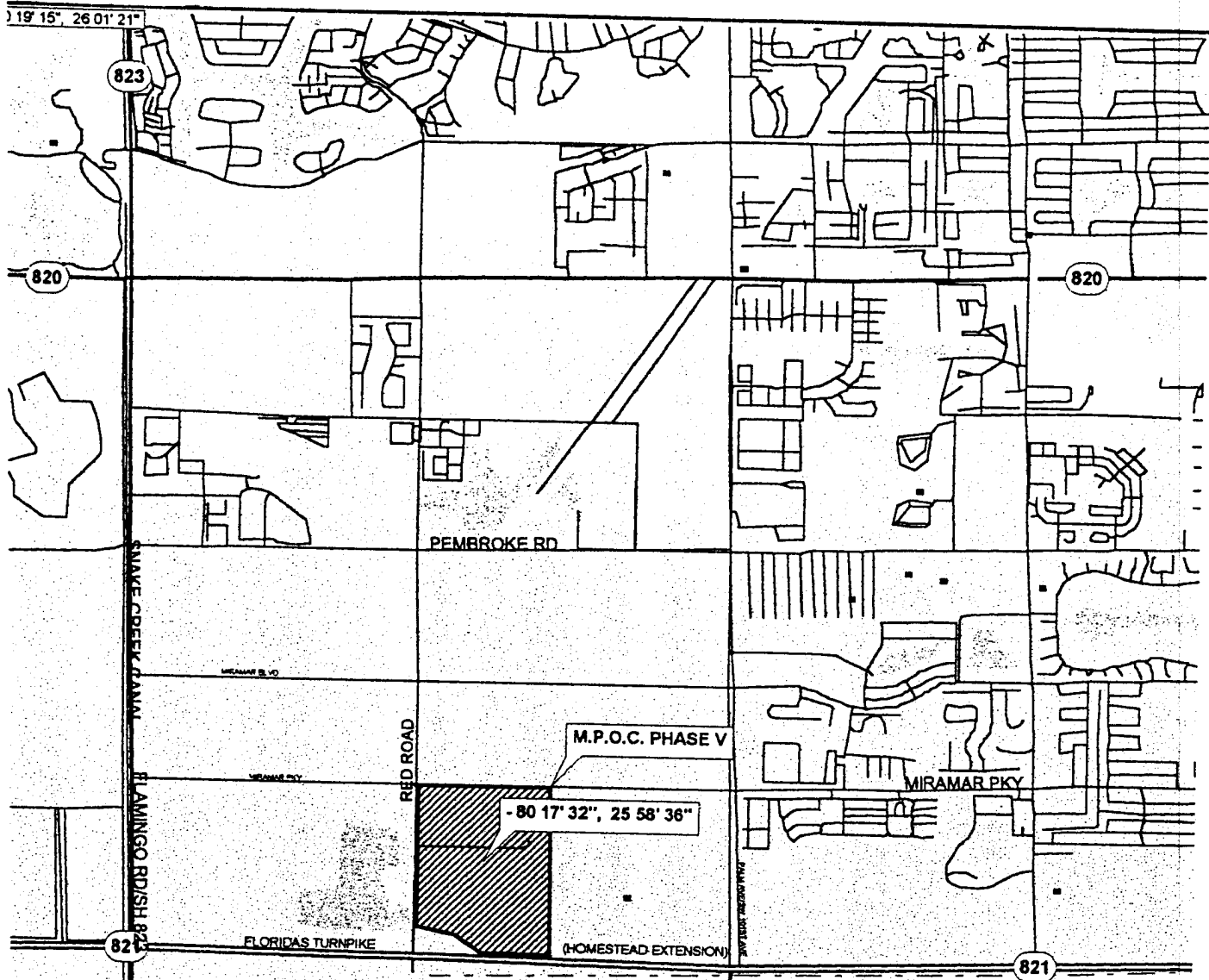
ERIC MYERS, DIRECTOR
BIOLOGICAL RESOURCES DIVISION



BROWARD COUNTY
 DEPARTMENT OF PLANNING AND ENVIRONMENTAL PROTECTION
 BIOLOGICAL RESOURCES DIVISION
 ENVIRONMENTAL RESOURCE LICENSE
 BROWARD COUNTY CODE 27-331 to 27-341
 PROJECT SUNBEAM PROPERTIES
 REVIEWER [Signature] DATE 11/2/00
 ATTACHED TO LICENSE NO. 27-017
 DRAWING 1 of 1 EXPIRES AS INDICATED IN LICENSE

NORTH



AREA LOCATION MAP

MPOC PHASE V
 FOR:
 SUNBEAM PROPERTIES
 PEMBROKE PINES, FLORIDA
 BROWARD COUNTY S30, T51, R41



PHILLIP R. JIMRUSTI
 & ASSOCIATES, INC.
 ECOLOGICAL ENGINEERS
 ENVIRONMENTAL CONSULTANTS
 12730 S.W. 12th Court
 DAVIE, FLORIDA 33325
 (954) 370-8870

PROJECT No.	102-11
COMP. NAME	MPOCV
FILE NAME	LOC MAP
DATE	2/3/00
SHEET 1 OF 5	

NORTH
1" = 500'



BROWARD COUNTY
DEPARTMENT OF PLANNING AND ENVIRONMENTAL PROTECTION
BIOLOGICAL RESOURCES DIVISION
ENVIRONMENTAL RESOURCE LICENSE
BROWARD COUNTY CODE 27-331 to 27-341
PROJECT SUNBEAM/110 CUMULATIVE IMPACT STUDY
REVIEWER [Signature] DATE 4/23/00
ATTACHED TO LICENSE NO. 075-1077
DRAWING 2 OF 2; EXPIRES AS INDICATED IN LICENSE

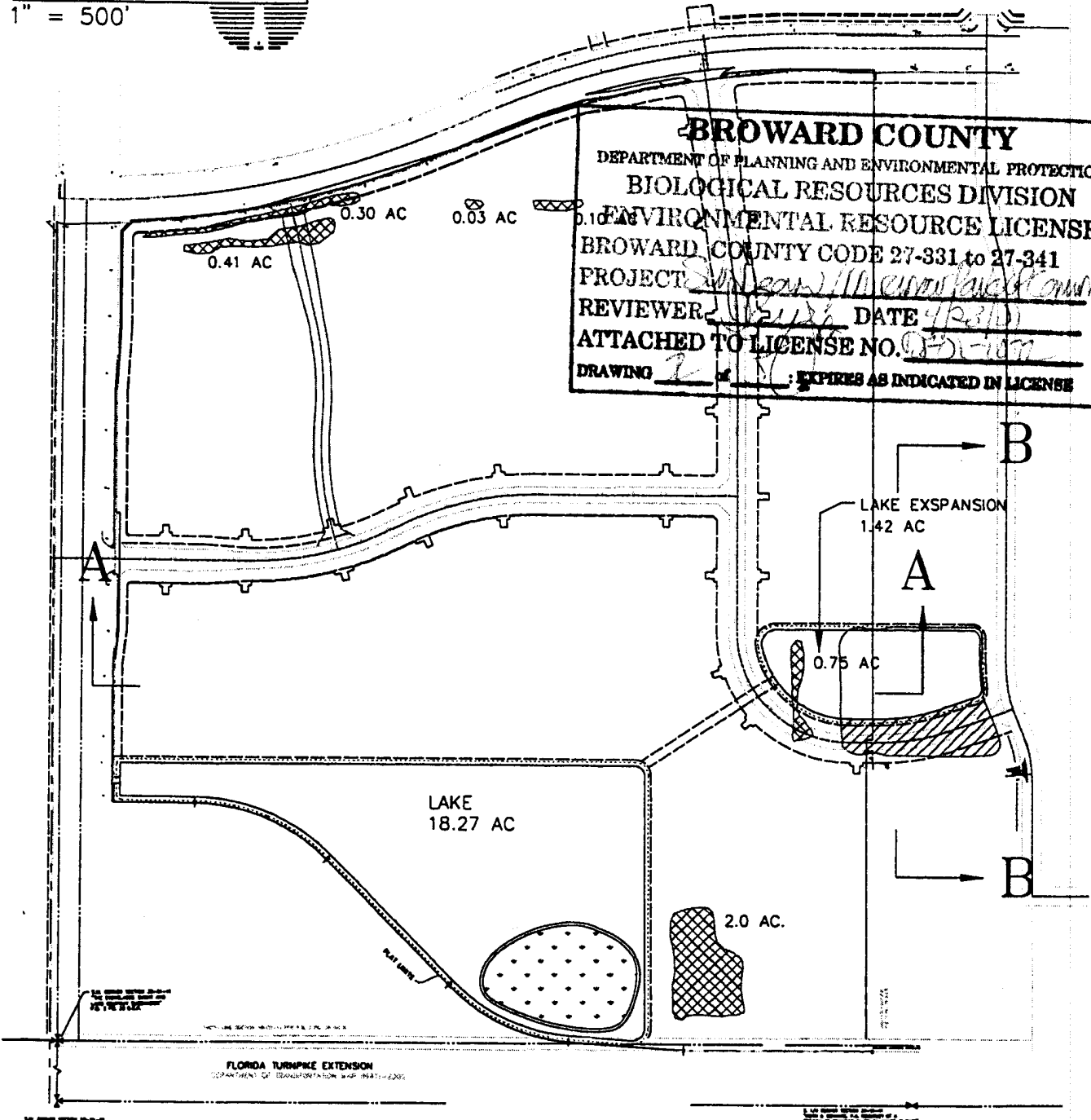

LEGEND

- JURISDICTIONAL WETLANDS 2.75 AC.
- PROPOSED MITIGATION 5.12 AC.
- FILLED OTHER WATERS 1.16 AC.
- TOTAL ACREAGE APPROX. ±144.0 AC

SFWMD

JURISDICTIONAL WETLANDS
MPOC PHASE V
FOR:
SUNBEAM PROPERTIES
PEMBROKE PINES, FLORIDA
BROWARD COUNTY S30, T51, R41



PHILLIP R. JIMRUSTI
& ASSOCIATES, INC.
ECOLOGICAL ENGINEERS
ENVIRONMENTAL CONSULTANTS
12730 S.W. 12th Court
DAVIE, FLORIDA 33325
(954) 370-8870



NO. 2	REV.	BY A.S.	TYPE GENERAL	DATE 11/13/00
NO. 1	REV.	BY	TYPE GENERAL	DATE 10/2/00

PROJECT No. 102-11
COMP. NAME MPOCV
FILE NAME JDSITE
DATE 2/3/00
SHEET 2 OF 5

BROWARD COUNTY
 DEPARTMENT OF PLANNING AND ENVIRONMENTAL PROTECTION
 BIOLOGICAL RESOURCES DIVISION
 ENVIRONMENTAL RESOURCE LICENSE
~~BROWARD COUNTY CODES 27-321 TO 27-323~~
 PROJECT 102-11 MPOCV
 REVIEWER [Signature] DATE 11/9/00
 ATTACHED TO LICENSE NO. 270-107
 DRAWING 3 of 3; EXPIRES AS INDICATED IN LICENSE

LAKE ±18.27 AC.

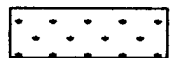
LEGEND

-  ISLAND EL. 2.7' .45 AC
-  MARSH EL. 1.5' 4.23 AC
-  SLOUGH EL. 0.0' .44 AC
- TOTAL 5.12 AC

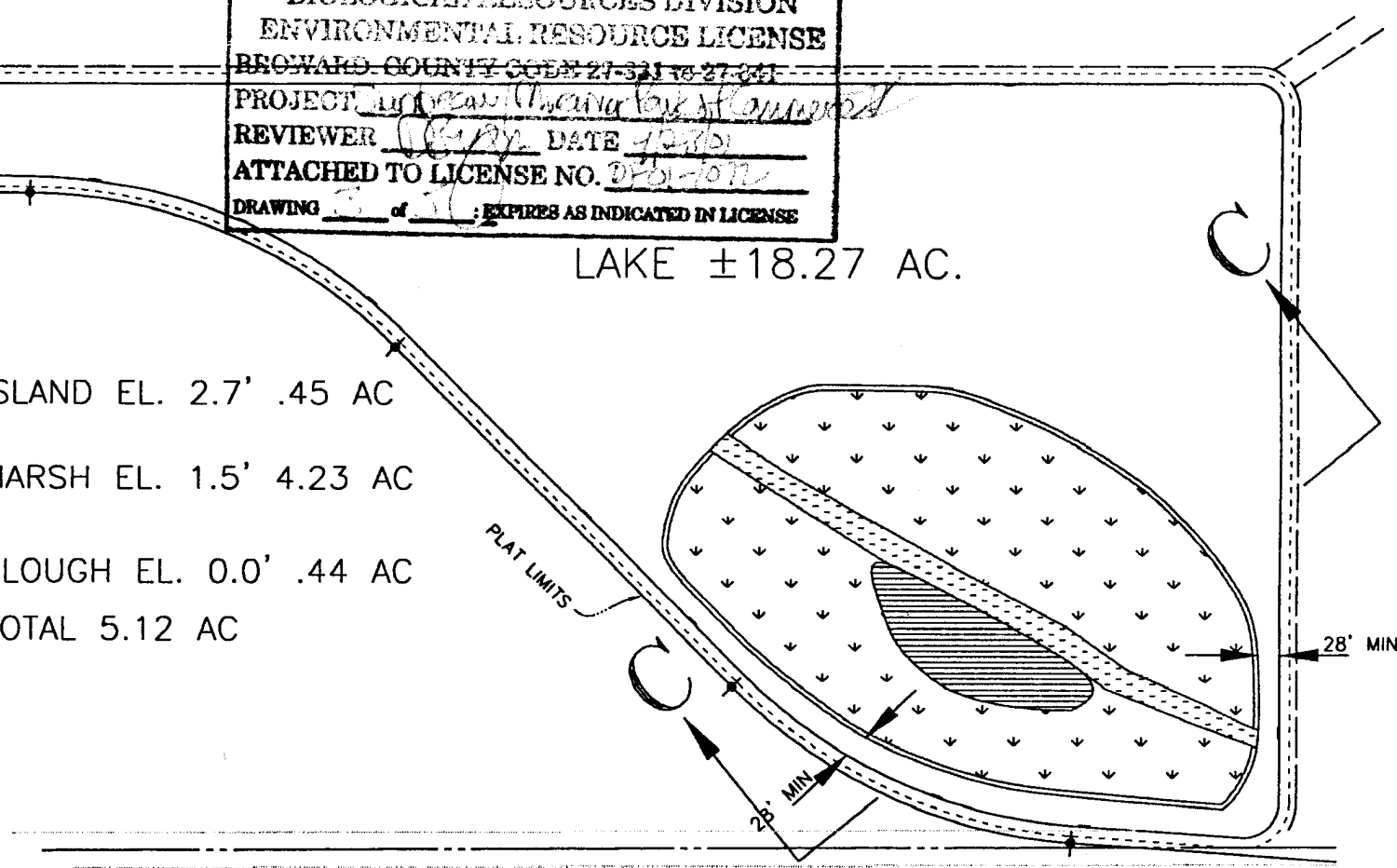

NORTH
1" = 200'



NO. 3	REV.	TYPE MIT.	DATE 11/9/00	BY A.S.	NO. 2	REV.	TYPE GENERAL	DATE 10/30/00
					NO. 1	REV.	TYPE GENERAL	DATE 10/2/00

PROPOSED MITIGATION
 MPOC PHASE V
 FOR:
SUNBEAM PROPERTIES
 PEMBROKE PINES, FLORIDA
 BROWARD COUNTY S30, T51, R41

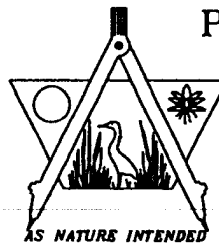



PHILLIP R. JIMRUSTI
 & ASSOCIATES, INC.
 ECOLOGICAL ENGINEERS
 ENVIRONMENTAL CONSULTANTS
 12730 S.W. 12th Court
 DAVIE, FLORIDA 33325
 (954) 370-8870

PROJECT No. 102-11
COMP. NAME MPOCV
FILE NAME MITPLAN
DATE 2/3/00
SHEET 3 OF 5

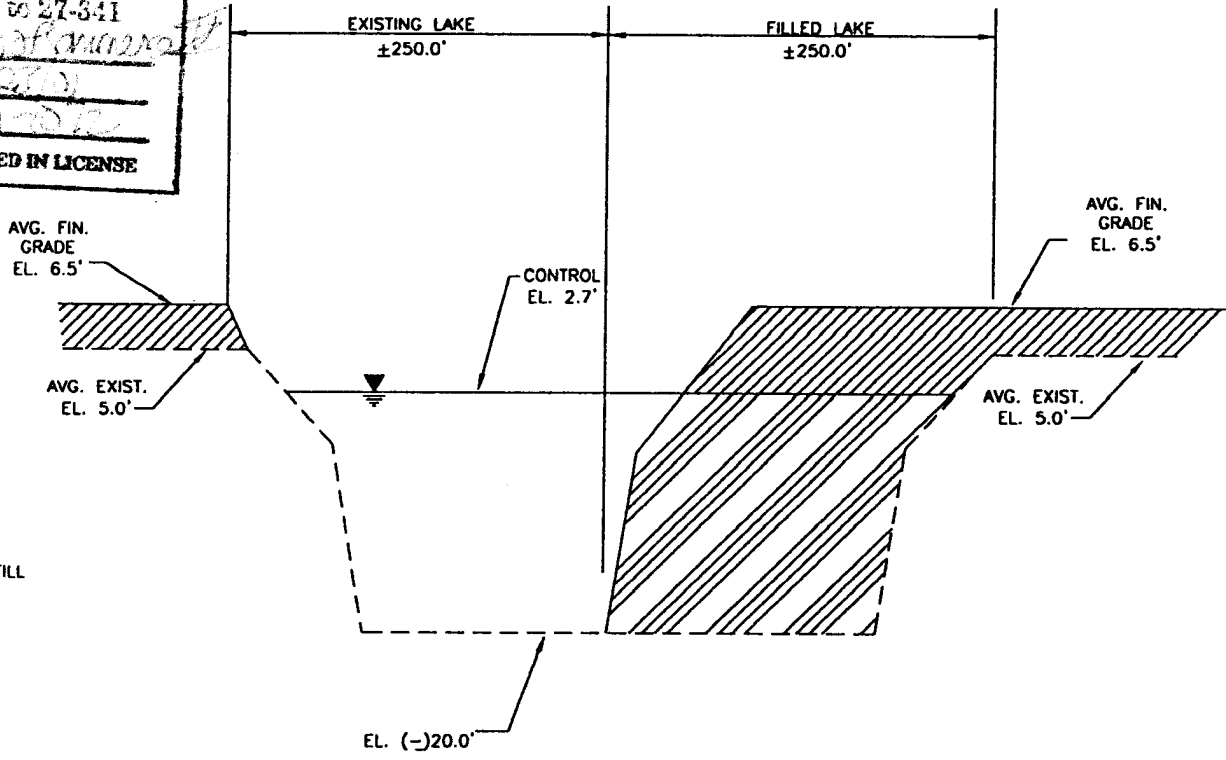
BROWARD COUNTY
 DEPARTMENT OF PLANNING AND ENVIRONMENTAL PROTECTION
 BIOLOGICAL RESOURCES DIVISION
 ENVIRONMENTAL RESOURCE LICENSE
 BROWARD COUNTY CODE 27-131 to 27-341
 PROJECT Sunbeam Properties of MPOCV
 REVIEWER [Signature] DATE 9/23/00
 ATTACHED TO LICENSE NO. 102-11
 DRAWING 2 of 2; EXPIRES AS INDICATED IN LICENSE



LEGEND

-  NON-JURISDICTIONAL FILL
-  FILL OTHER WATERS

CROSS SECTION B-B
N.T.S.

CROSS SECTION MPOCV PHASE V FOR: SUNBEAM PROPERTIES PEMBROKE PINES, FLORIDA BROWARD COUNTY S30, T51, R41		PHILLIP R. JIMRUSTI & ASSOCIATES, INC. ECOLOGICAL ENGINEERS ENVIRONMENTAL CONSULTANTS 12730 S.W. 12th Court DAVIE, FLORIDA 33325 (954) 370-8870	PROJECT No. 102-11
		COMP. NAME MPOCV	
		FILE NAME XSEC	
		DATE 2/10/00	
		SHEET 4 OF 5	

BROWARD COUNTY
 DEPARTMENT OF PLANNING AND ENVIRONMENTAL PROTECTION
BIOLOGICAL RESOURCES DIVISION
ENVIRONMENTAL RESOURCE LICENSE
 BROWARD COUNTY CODE 27-331 to 27-341
 PROJECT Sunbeam / Pembroke Pines / R41
 REVIEWER [Signature] DATE 4/23/00
 ATTACHED TO LICENSE NO. DES 4570
 DRAWING 5 of 5 EXPIRES AS INDICATED IN LICENSE

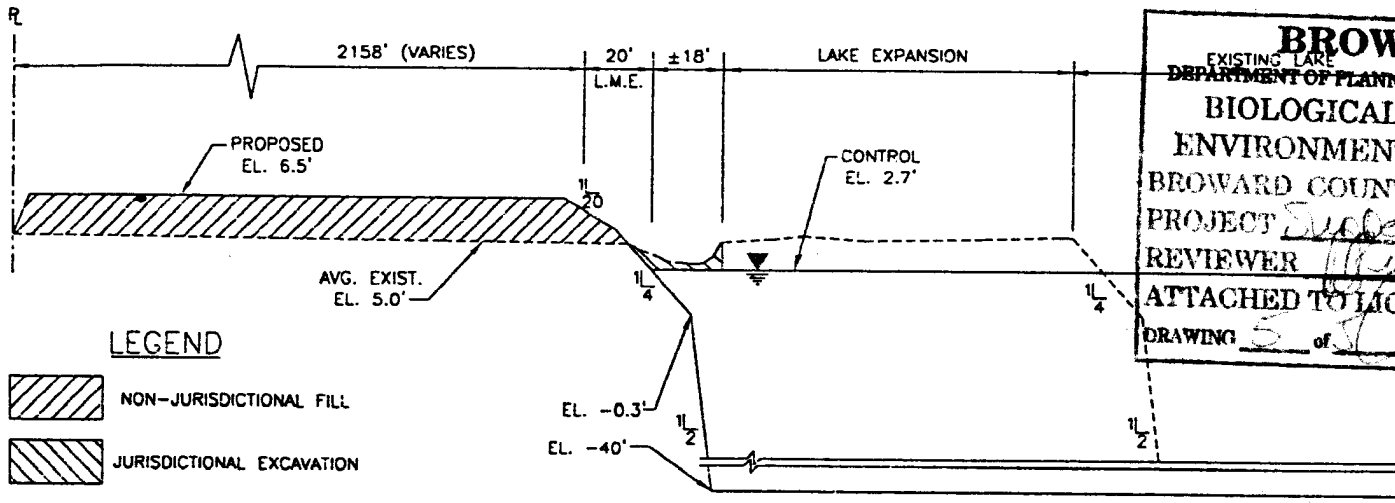

LEGEND

- NON-JURISDICTIONAL FILL
- JURISDICTIONAL EXCAVATION

CROSS SECTION A-A
N.T.S.

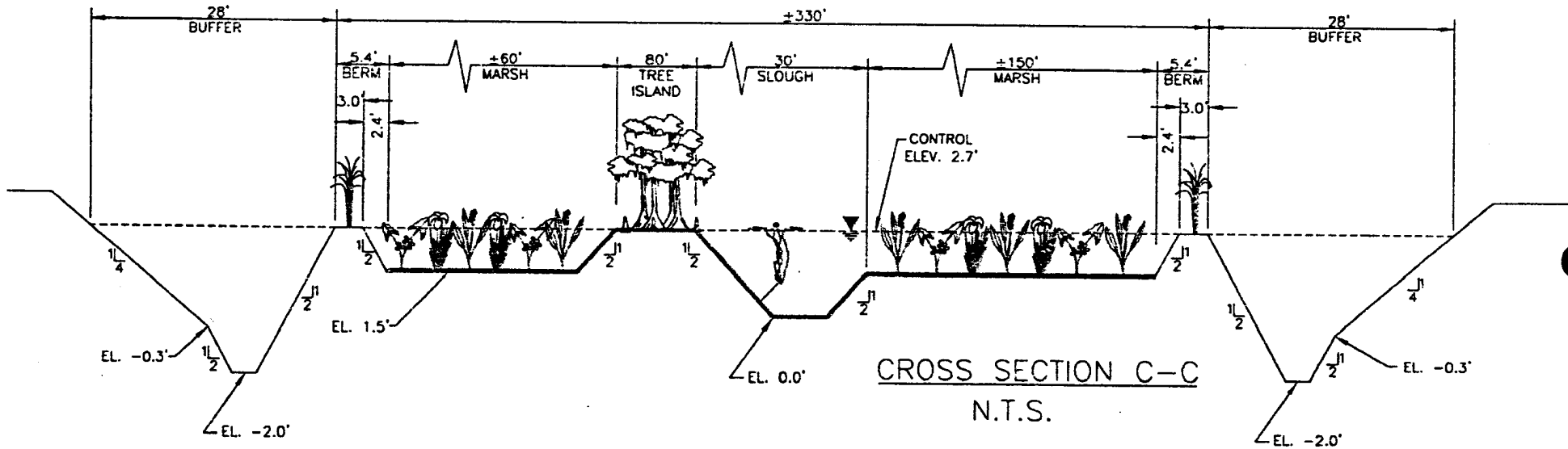

CROSS SECTION C-C
N.T.S.

CROSS SECTION
MPOC PHASE V
 FOR:
SUNBEAM PROPERTIES
 PEMBROKE PINES, FLORIDA
 BROWARD COUNTY S30, T51, R41

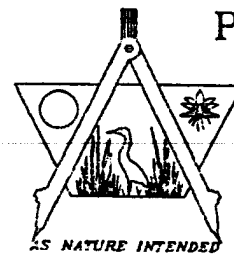

PHILLIP R. JIMRUSTI
 & ASSOCIATES, INC.
 ECOLOGICAL ENGINEERS
 ENVIRONMENTAL CONSULTANTS
 12730 S.W. 12th Court
 DAVIE, FLORIDA 33325
 (954) 370-8870

PROJECT NO.	102-11
COMP. NAME	MPOCV
FILE NAME	XSEC
DATE	2/10/00
SHEET	5 OF 5