



**Department of Planning and Environmental Protection**

Biological Resources Division  
218 S.W. 1st Avenue  
Fort Lauderdale, FL 33301

(954) 519-1230 • FAX (954) 519-1412

**ENVIRONMENTAL RESOURCE LICENSE**

**LICENSEE:**

Sharon Gardens LTD Partnership  
6800 West Oakland Park Boulevard  
Ft. Lauderdale, FL 33313

**LICENSE NO.:DF00-1090**

**PROJECT: Menorah Gardens,  
Wetland Fill, Mitigation**

This license is issued under the provision of Chapter 27 of the Broward County Code of Ordinances also cited as Broward County Natural Resource Protection Code hereinafter called the Code. The above-named applicant, hereinafter called licensee, is hereby authorized to perform the work or operate the facility shown on the approved drawing(s), plans, documents, and specifications as submitted by applicant, and made a part hereof and specifically described as follows:

**Description of Work:** This license is the relicensing of DF93-1134 which was an after-the-fact license for filling 4.4 acres of wetlands. In addition to the relicense, subsequently, an additional 1.25 acres of wetlands was filled without a license and subject to Notice of Violation numbers 99-30438 and 99-30456. This work was completed for the construction of a cemetery.

Compensation for the 5.65 acres of impacts shall be 4.05 acres of mixed marsh, flushing channels, and hydric islands as per plans.

**Location of Work:** This project is located south of Griffin Road and east of US Highway 27 in Section 34, Township 50S, Range 39E in unincorporated Broward County.

**Conditions:** Construction shall be in accordance with Application SFWMD Form 0971 and DPEP Addendum each dated 6/14/99, and associated information, all of which is designated as DPEP File No. 99-14563; with the attached plans stamped by the Department on 5/23/00; and with all General and Specific Conditions of this license.

## **ENVIRONMENTAL RESOURCE LICENSE**

### **GENERAL CONDITIONS**

1. The terms, conditions, requirements, limitations and restrictions set forth herein are accepted and must be completed by the licensee and enforceable by the Department of Planning and Environmental Protection (DPEP) pursuant to Chapter 27 of the Broward County Code of Ordinances. The DPEP will review this license periodically and may revoke or suspend the license, and initiate administrative and/or judicial action for any violation of the conditions by the licensee, its agents, employees, servants or representatives.
2. This license is valid only for the specific uses set forth in the license application and any deviation from the approved uses may constitute grounds for revocation, suspension and/or enforcement action by the DPEP.
3. In the event the licensee is temporarily unable to comply with any of the conditions of the license or with the Code, the licensee shall notify the DPEP within eight (8) hours or as stated in the specific section of the Code. Within three (3) working days of the event, the licensee shall submit a written report to the DPEP that describes the incident, its cause, the measures being taken to correct the problem and prevent its reoccurrence, the owner's intention toward repair, replacement, and reconstruction of destroyed facilities, and a schedule of action leading toward operation within the license conditions.
4. The issuance of this license does not convey any vested rights or exclusive privileges, or does it authorize any injury to public or private property or any invasion of personal rights, or any violations of federal, state or local laws or regulations.
5. This license must be available for inspection on licensee's premises during the entire life of the license.
6. By accepting this license, the licensee understands and agrees that all records, notes, monitoring data and other information relating to the construction or operation of this licensed facility or activity that are submitted to the County, may be used by the County as evidence in any enforcement proceeding arising under Chapter 27 of the Broward County Code of Ordinances, except where such use is prohibited by Section 403.111, Florida Statutes.
7. The licensee agrees to comply and shall comply with all provisions of the most current version of the Code.
8. Any new owner of a licensed facility shall apply by letter for a transfer of license within thirty (30) days after the sale or legal transfer. The transferor shall remain liable for performance in accordance with the license until the transferee applies for, and is granted a transfer of license. The transferee shall be liable for any violation of the Code that results from the transferee's activities. The transferee shall comply with the transferor's original license conditions when the transferee has failed to obtain its own license.
9. The licensee, by acceptance of this license, specifically agrees to allow access and shall allow access to the license source at reasonable times by DPEP personnel for the purposes of inspection and testing to determine compliance with this license and Chapter 27, Broward County Code of Ordinances.
10. This license does not constitute a waiver or approval of any other license, approval or regulatory requirement by this or any other governmental agency that may be required.
11. If the licensee wishes to renew the license or extend its term, the licensee shall make application sixty (60) days prior to its expiration including payment of all appropriate fees. Expired licenses are not renewable.

SPECIFIC CONDITIONS:

A. Standard

1. Notify the Department in writing a minimum of 48 hours prior to project commencement and a maximum of 48 hours after project completion. Failure to comply with this condition will result in enforcement action.
2. Any project caused environmental problem(s) shall be reported immediately to the DPEP Environmental Response Line at 954-519-1499.
3. All project generated solid waste must be disposed of in a suitable approved manner at an upland location.
4. Turbidity screens or equivalent shall be properly employed and maintained as necessary during construction activities so that turbidity levels do not exceed 29 NTU's above natural background 50 feet downstream of project. If turbidity levels exceed these limits, project activities shall immediately cease, and work shall not resume until turbidity levels drop to within the standards set forth in Rule 62-302.530(70) of the FAC.
5. Any water bodies or wetlands to be filled pursuant to this license must be filled only with rock, soil, or muck, as appropriate and depicted on the attached drawings dated 5/23/00 by the Department. Fill material which includes clean debris as defined in Section 27-214 is not authorized by this license. Use as fill of any materials other than rock, soil, or muck shall constitute a violation of this license.

B. Compensatory Mitigation (Area)

1. Construction and installation of the Area shall be in accordance with plans dated 5/23/00 by the Department (attached) and associated information. The Area shall be installed within 180 days from the issue date of this license.
2. Upon completion of the Area, the following documentation shall be submitted to the Department: (a) certification of elevations in relation to design, (b) verification of actual acreage, and (c) the time-zero monitoring report. This documentation is required within 210 days from the issue date of this license.
3. All exotic and nuisance vegetation shall be treated or removed from the Area. Less than 2% coverage will be allowed if dispersed throughout the Area and not concentrated in any particular location. Exotic and nuisance species include but are not limited to: melaleuca, Australian pine, Brazilian pepper, bischofia, torpedo grass, primrose willow, cattail, air potato, and syngonium.
4. In order to assure that the Area becomes self-sustaining, the following criteria shall be met:
  - a) A minimum of 80% coverage by desirable wetland species after a two (2) year period and demonstration of persistence for three (3) additional years.
  - b) Less than 2% coverage by invasive exotic and undesirable species is allowable if plants are dispersed and not concentrated in any particular area. Exotic and undesirable species include, but are not limited to, melaleuca, Australian pine, Brazilian pepper, bischofia, torpedo grass, primrose willow, cattail, air potato, and syngonium. Treatment efforts should be tailored to prevent these species from becoming reproductively mature.
  - c) A minimum of 80% survival of each planted species. This rate shall be maintained each quarter except where species composition, density of planted and recruitment species and overall wetland condition, growth rates and viability of the Area are of higher quality, as determined by the Department.

License No. DF00-1090  
LICENSEE: Sharon Gardens LTD Partnership

- d) Hydrologic conditions and soil characteristics are in general conformity to those specified in plans. Data from the permanent surveyed staff gauges must be collected every two weeks and submitted with the quarterly monitoring reports.
- e) Any preserved or planted species shall be maintained as to exhibit new growth and/or propagation, viability, and overall health.
- f) Existing desirable wetland plant species shall not be injured or killed. Any plants killed will be replaced on a plant-for-plant basis for shrubs and groundcovers and on an inch-for-inch basis for trees

The Area shall be monitored and reports submitted quarterly for five (5) years describing in detail the condition of the Area relative to the reference wetland and the criteria listed above (B. 4.a-f).

- 5. Should the Department determine that the Area is not achieving the listed criteria during some portion of the monitoring period, the licensee shall determine the reasons for failure and prepare plans that demonstrate clearly how the problem(s) will be corrected and submit such plans immediately to the Department for approval. Those plans shall be implemented within 30 days from the Departments written approval.
- 6. A Conservation Easement and a Surety Bond for \$120,200 have been submitted by the applicant. Should either of these documents be unacceptable to the County Attorney's Office or the County Commission, a replacement document shall be submitted in a form acceptable to the Department, the County Attorney's Office and the Commission within thirty (30) days of the Department's written notification that the document was unacceptable.
- 7. The Surety Bond includes construction, planting, monitoring and maintenance costs. Upon Department review and approval of all information required in Specific Condition B. 2, the licensee may request the release of the construction and planting portion of the Surety Bond, which totals \$45,200. After the five year maintenance and monitoring period has elapsed and upon demonstration that the licensee has met the intent and all information requested in Specific Conditions B.3 and 4 and if necessary B.5, the licensee may request the release of the monitoring and maintenance portion of the Surety Bond, which totals \$75,000. All requests shall be made in writing to the Wetlands Resources Section of the Department.

**C. A COPY OF THIS LICENSE SHALL BE KEPT ON SITE DURING ALL PHASES OF LICENSED CONSTRUCTION.**

Recommended for approval by:

  
License Processor

Reviewed by:

  
Licensing/Section Manager

I have read the terms, conditions, requirements, limitations and restrictions set forth herein. I accept and agree to abide by all such provisions.

  
Signature (Licensee or authorized agent)



5/25/00  
Date

Issued this 25 day of May 2000

Expiration Date: May 25, 2005

**BROWARD COUNTY DEPARTMENT OF PLANNING AND ENVIRONMENTAL PROTECTION**

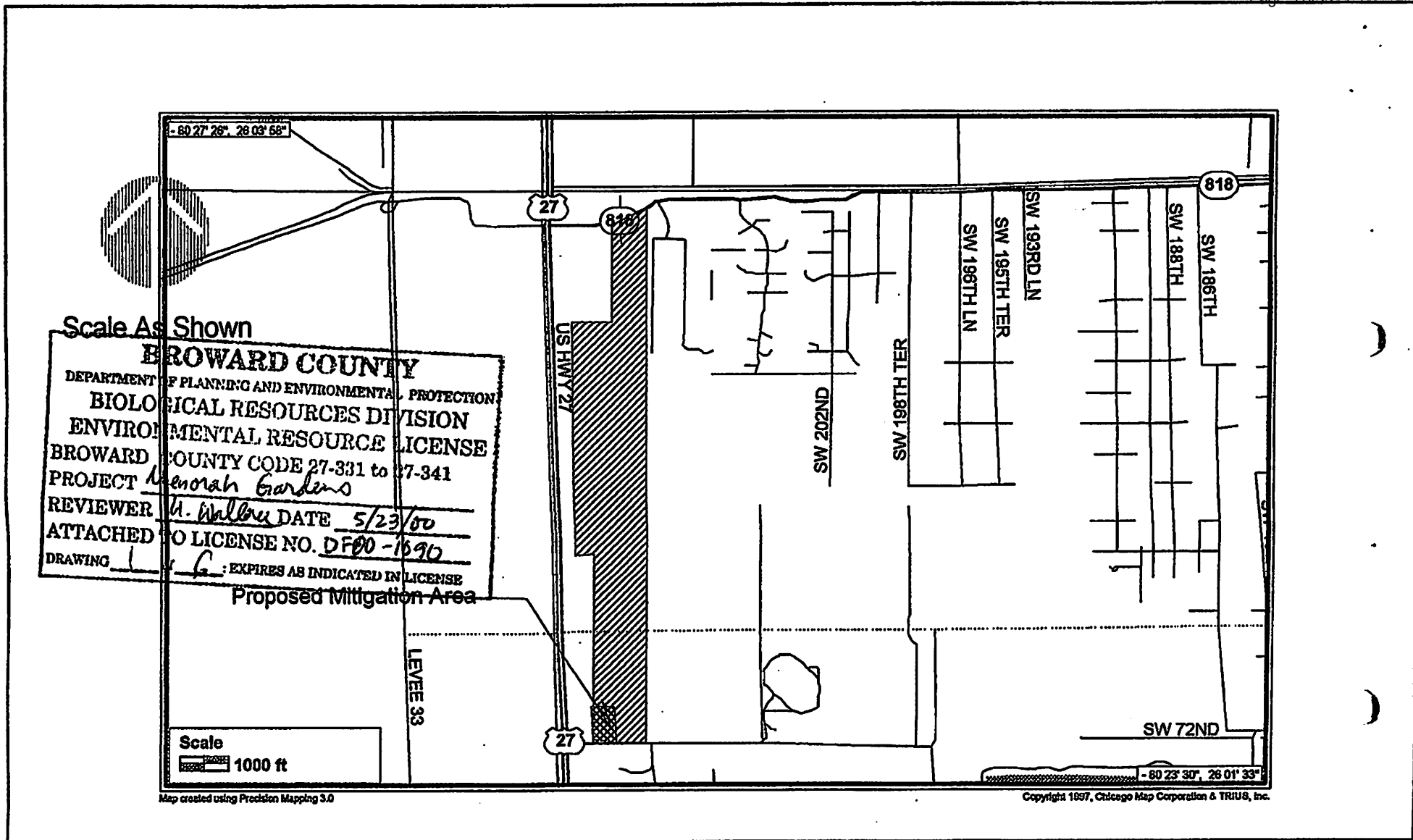
  
ERIC T. MYERS, DIRECTOR  
BIOLOGICAL RESOURCES DIVISION





Professional Wetland Scientists  
 Environmental Consultation & Permitting

**Sharon Gardens LTD (SCI)**

Menorah Gardens Location Map  
 Griffin Road & US 27  
 Broward County, Florida

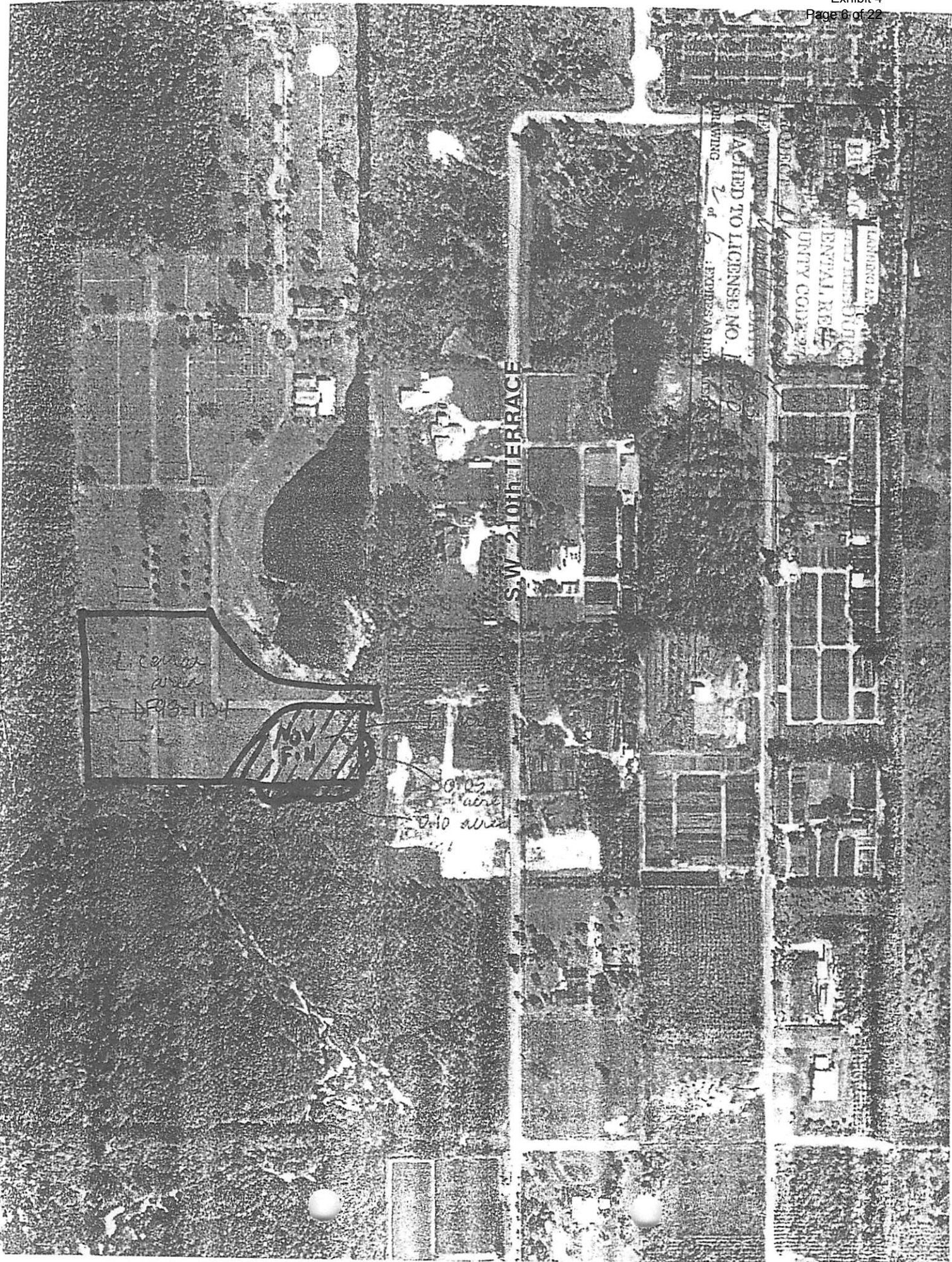
Date	Revision		Sheet
	2-12-00	Revise Mitigation Location	
April 29, 1999			1 OF 4
<p><b>J. J. Goldasich &amp; Associates, Incorporated</b>                  (561) 883-9555 FAX (561) 883-0054</p>			



ACHIEVED TO LICENSE NO. 1  
DRAWING 2 of 6

MENTAL HEALTH UNIT/CLINIC  
UNIT/CLINIC

S.W. 210th TERRACE

Licence area  
DFPS-1134

Nov 5-11

0125  
0110 area

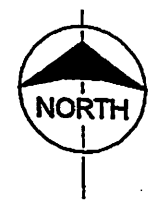

Area of Previous Impacts

Existing Melaleuca forest

~2900'

Existing residential development  
and small agricultural activities

**Note:**

The proposed mitigation will be conducted immediately following issuance of all permits and licenses for the proposed mitigation. The mitigation will consist of the physical removal of the Melaleuca trees and other invasive exotic vegetation and lowering of the soil to approximately 3.25 NGVD. The wetland area will have a minimum of one (1) foot of suitable wetland soils on the surface. Suitable wetland plants will be installed according to the attached mitigation plan and associates drawings.

See Sheet 3 of 4 for proposed mitigation plan elements and specific details of the 4.05 acre wetland mitigation area

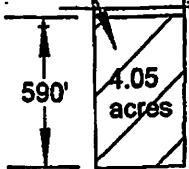

**BROWARD COUNTY**  
DEPARTMENT OF PLANNING AND ENVIRONMENTAL PROTECTION  
BIOLOGICAL RESOURCES DIVISION  
ENVIRONMENTAL RESOURCE LICENSING  
PROJECT *Menorah Gardens*  
REVIEWER *M. Walker* DATE *5/23/09*  
ATTACHED TO LICENSE NO. *D-06-1090*  
DRAWING *2* of *4*; REVISIONS AS INDICATED IN LICENSE

Mitigation Based Upon:  
WBI of 0.48  
Impact of 1.25 Acres  
Original M.R. 2.9 Acres  
Total = 4.05 Acres



Environmental Consultation & Permitting  
Professional Wetland Scientists

# SCI NOV Mitigation

Menorah Gardens Site  
Griffen Road and US 27  
Approximate Proposed Site Conditions  
Broward County, Florida

Date	Revision	1a <sup>of</sup> 4
8/27/99	Revise Mitigation Area	
Apr 27, 1999	Revise Mitigation Area	
11/15/99	Revise Mitigation Area	
<b>J. J. Goldasich and Associates, Incorporated</b> (561) 883-9555 FAX (561) 883-0054		

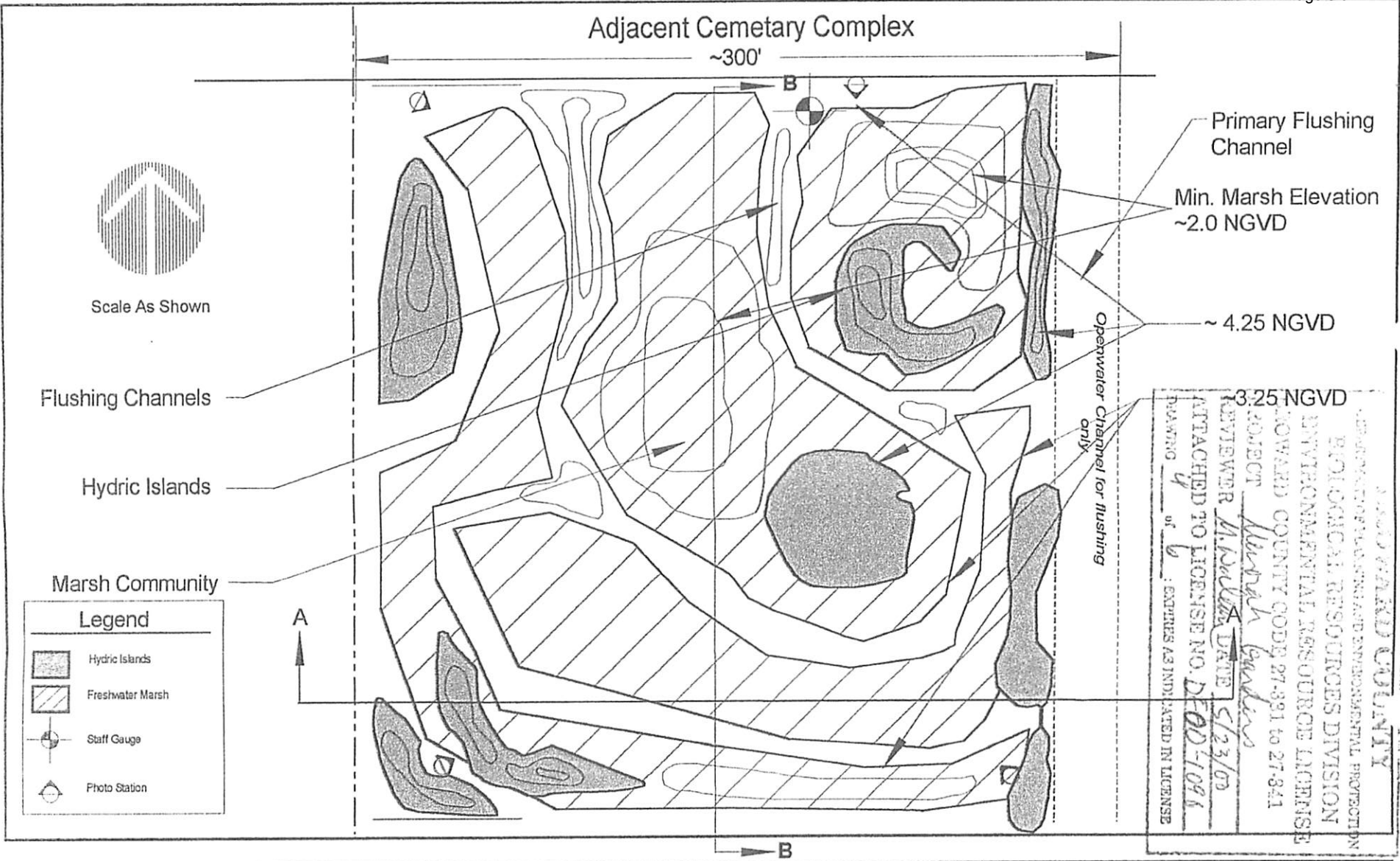

Professional Wetland Scientists  
Environmental Consultation & Permitting

## Sharon Gardens LTD (SCI)

Menorah Gardens Typical Plan-View  
Wetland Mitigation Area  
Griffin Road & US 27  
Broward County, Florida

Date	Revision	Sheet
April 29, 1999	June 30, 1999 Modify mitigation location	3 OF 4
	May 19, 2000 Add Section B-B per DREP	
<p><b>J. J. Goldasich &amp; Associates, Incorporated</b>                      (561) 883-9555 FAX (561) 883-0054</p>		



### Typical Cross-Section A-A

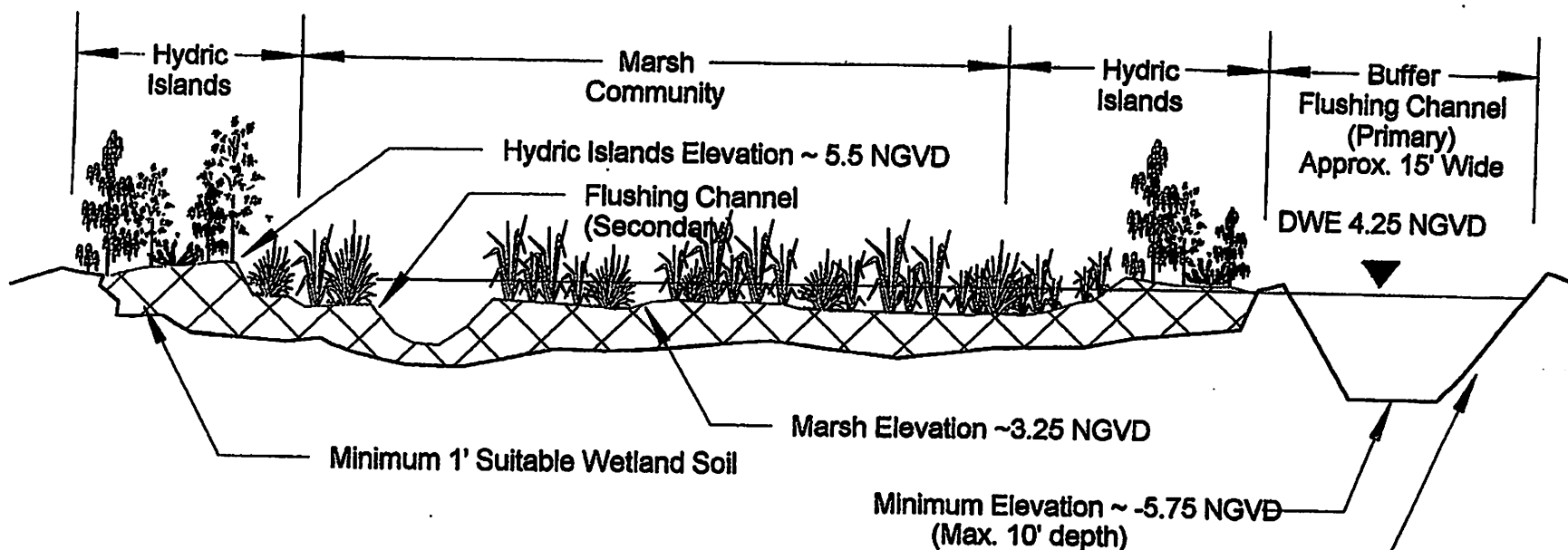

**Notes:** Mitigation Area to be planted with 4,840 herbaceous plants per acre of marsh and 400 woody plants per acre of hydric island.

Mitigation Area to be a total of 4.05 acres in size.

Soils to be a minimum of 1 foot of suitable wetland soils throughout mitigation area.

Total openwater area to be equal to or less than 15% of total mitigation area.

**BROWARD COUNTY**  
Slope 3:1

DEPARTMENT OF PLANNING AND ENVIRONMENTAL PROTECTION  
BIOLOGICAL RESOURCES DIVISION  
ENVIRONMENTAL RESOURCE LICENSE  
BROWARD COUNTY CODE 27-331 to 27-341  
PROJECT Menorah Gardens  
REVIEWER L. Walker DATE 5/23/00  
ATTACHED TO LICENSE NO. DF00-1090  
DRAWING 5 of 6 : EXPIRES AS INDICATED IN LICENSE



Professional Wetland Scientists  
Environmental Consultation & Permitting

**SCI Funeral Services of Fla., Inc.**  
**Menorah Gardens**

Mitigation Cross-Section  
Section 34, Township 50, Range 39  
Broward County, Florida

Date	Revision	Sheet
May 2000		4 OF 4

**J. J. Goldasich & Associates, Incorporated**  
(561) 883-9555 FAX (561) 883-0054

## Typical Cross-Section B-B

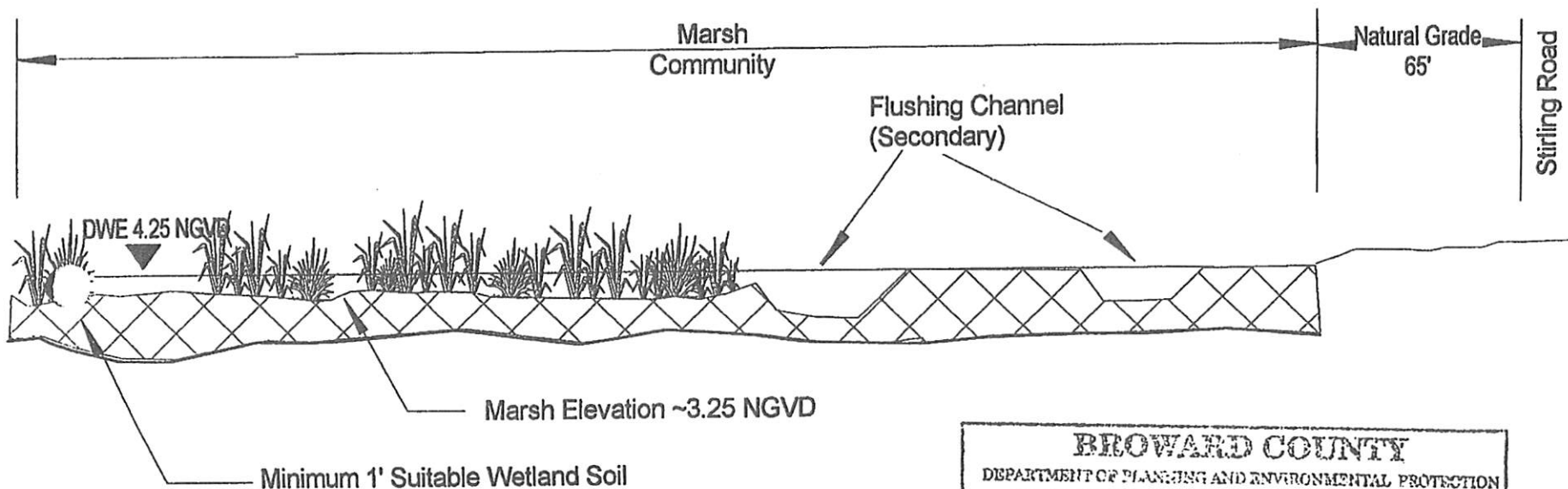

**Notes:** Mitigation Area to be planted with 4,840 herbaceous plants per acre of marsh and 400 woody plants per acre of hydric island.

Soils to be a minimum of 1 foot of suitable wetland soils throughout mitigation area.

Total openwater area to be equal to or less than 15% of total mitigation area.

Mitigation Area to be a total of 4.05 acres in size.

Mitigation area size based upon a WBI of 0.48 and an impact area of 1.25 acres.

Therefore:  $0.48 * 1.25 = X(0.52)$   
 $0.60 / 0.52 = 1.15$   
 $1.15 + 2.9 = 4.05$

2.9 is previous mitigation requirement

**BROWARD COUNTY**  
 DEPARTMENT OF PLANNING AND ENVIRONMENTAL PROTECTION  
 BIOLOGICAL RESOURCES DIVISION  
 ENVIRONMENTAL RESOURCE LICENSE  
 BROWARD COUNTY CODE 27-331 to 27-341  
 PROJECT Menorah Gardens  
 REVIEWER M. Walker DATE 5/23/00  
 ATTACHED TO LICENSE NO. DF00-1090  
 DRAWING 6 of 6 : EXPIRES AS INDICATED IN LICENSE



Professional Wetland Scientists  
Environmental Consultation & Permitting

### Sharon Gardens LTD (SCI)

Menorah Gardens Typical Cross-Section  
Wetland Mitigation Area  
Griffin Road & US 27  
Broward County, Florida

Date	Revision	Sheet
April 29, 1999	May 19, 2000 Per DPEP	4 OF 4

J. J. Goldasich & Associates, Incorporated  
(561) 883-9555 FAX (561) 883-0054



**Department of Planning and Environmental Protection**  
Biological Resources Division  
218 S.W. 1st Avenue  
Fort Lauderdale, FL 33301  
(954) 519-1230 • Fax (954) 519-1412

January 8, 2002

Mr. Noel Merwarth  
SCI Funeral Services of Florida, Inc.  
1929 Allen Parkway  
Houston, Texas 77019

Re: Modification of DPEP License No. DF00-1090  
License transfer and expansion of mitigation acreage

Dear Mr. Merwarth:

Your request to modify the license by creating an additional 4.36 acres of mitigation thus creating a total of 8.41 acres of mitigation and is subsequent reconfiguration is hereby approved. The attached drawings stamped by the Department replace drawings 2 of 6 through 6 of 6 of the original license drawings.

The license is also hereby transferred from:

Sharon Gardens Ltd. Partnership  
6800 West Oakland Park Boulevard  
Fort Lauderdale, Florida 33313

to:

SCI Funeral Services of Florida, Inc.  
1929 Allen Parkway  
Houston, Texas 77019

The scope and all other conditions of the license remain the same. Attach this letter to the original license as it becomes a part thereof.

*I have read the terms, conditions, requirements, limitations, and restrictions set forth herein. I accept and agree to abide by all such provisions.*

  
\_\_\_\_\_  
Signature (Licensee or authorized agent)

1/8/02  
Date

Sincerely,

  
Eric Myers  
Director, Biological Resources Division

Attached



# Future Cemetery Development +/-15.75 ac.

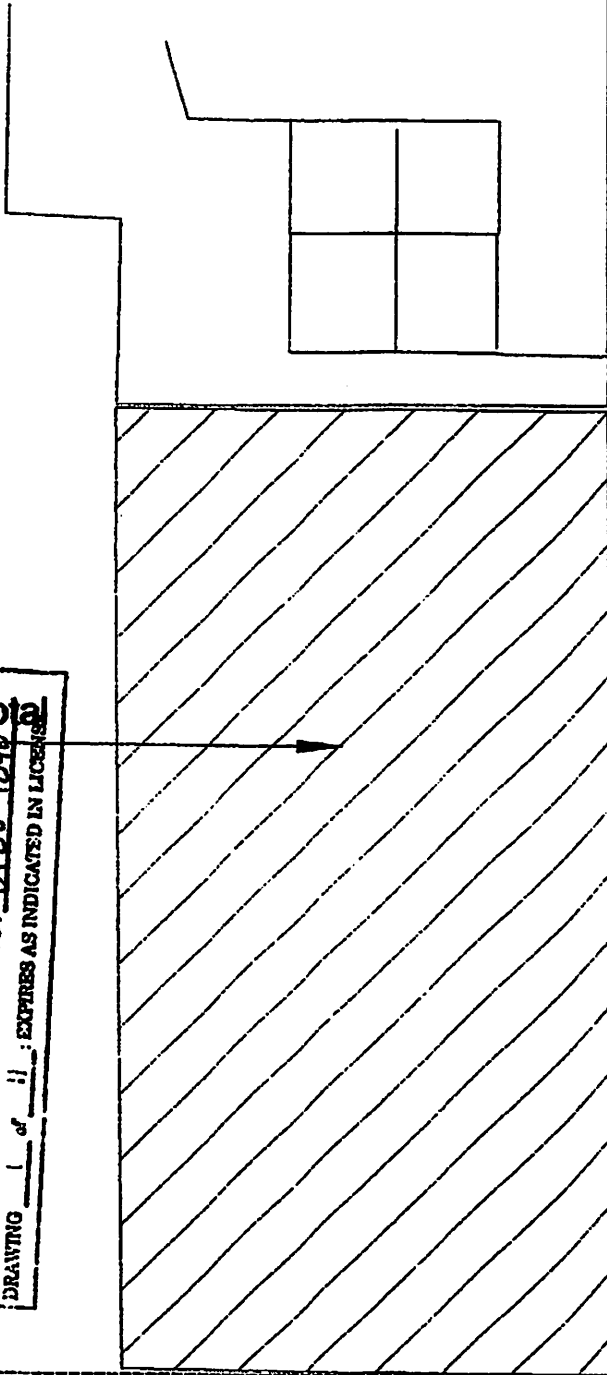

Future Mitigation  
Area +  
To be  
impair

**BROWARD COUNTY**  
DEPARTMENT OF PLANNING AND ENVIRONMENTAL PROTECTION  
**BIOLOGICAL RESOURCES DIVISION**  
**ENVIRONMENTAL RESOURCE LICENSES**  
BROWARD COUNTY CODE 27-331 to 27-341  
PROJECT *12/9/01*  
REVIEWER *K. L. [unclear]* DATE *12/9/01* total  
ATTACHED TO LICENSE NO. *DF00-1040*  
DRAWING *1* of *11*; EXPRES AS INDICATED IN LICENSE

S.B.D.D. Canal R.O.W.

Future Access Road  
+/-2.15 ac.

Match Line



Environmental Consultation & Permitting  
Professional Wetland Scientists

## SCI Funeral Services of Fla., Inc. Menorah Gardens

Property Plan View  
Section 34; Township 50, Range 39  
Broward County, Florida

Date	Revision	1 of 8
June 2001		

J. J. Goldsich and Associates, Incorporated  
(561) 883-9555 FAX (561) 883-0054



Match Line

S.B.D.D. Canal R.O.W.

Future Mitigation  
Area +/-22.11 ac. total  
To be built as impacts occur.

Future Access Road  
+/-2.15 ac.

Proposed Mitigation  
Area For Violations  
Occurring in 1993,  
1998, 2000  
+/-8.41 ac.  
See Sheet 3 of  
8 for details

Reserved for future  
development  
+/-2.1 ac.

Stirling Road 55' South

**BROWARD COUNTY**  
DEPARTMENT OF PLANNING AND ENVIRONMENTAL PROTECTION  
BIOLOGICAL RESOURCES DIVISION  
ENVIRONMENTAL RESOURCE LICENSE  
BROWARD COUNTY CODE 27-331 to 27-341  
PROJECT NO. 27-331-001  
REVIEWER: [Signature] DATE: 8/14/01  
ATTACHED TO LICENSE NO. DE08-1070  
DRAWING

 Environmental Consultation & Permitting Professional Wetland Scientists	<b>SCI Funeral Services of Fla., Inc.</b> <b>Menorah Gardens</b> Property Plan View Section 34, Township 50, Range 39 Broward County, Florida	<b>Date</b>	<b>Revision</b>	<b>2</b> of <b>8</b>
		June 2001		
		J. J. Goldasich and Associates, Incorporated (561) 883-9555 FAX (561) 883-0054		

Cemetery Property/Future Mitigation Area



Scale: As Shown

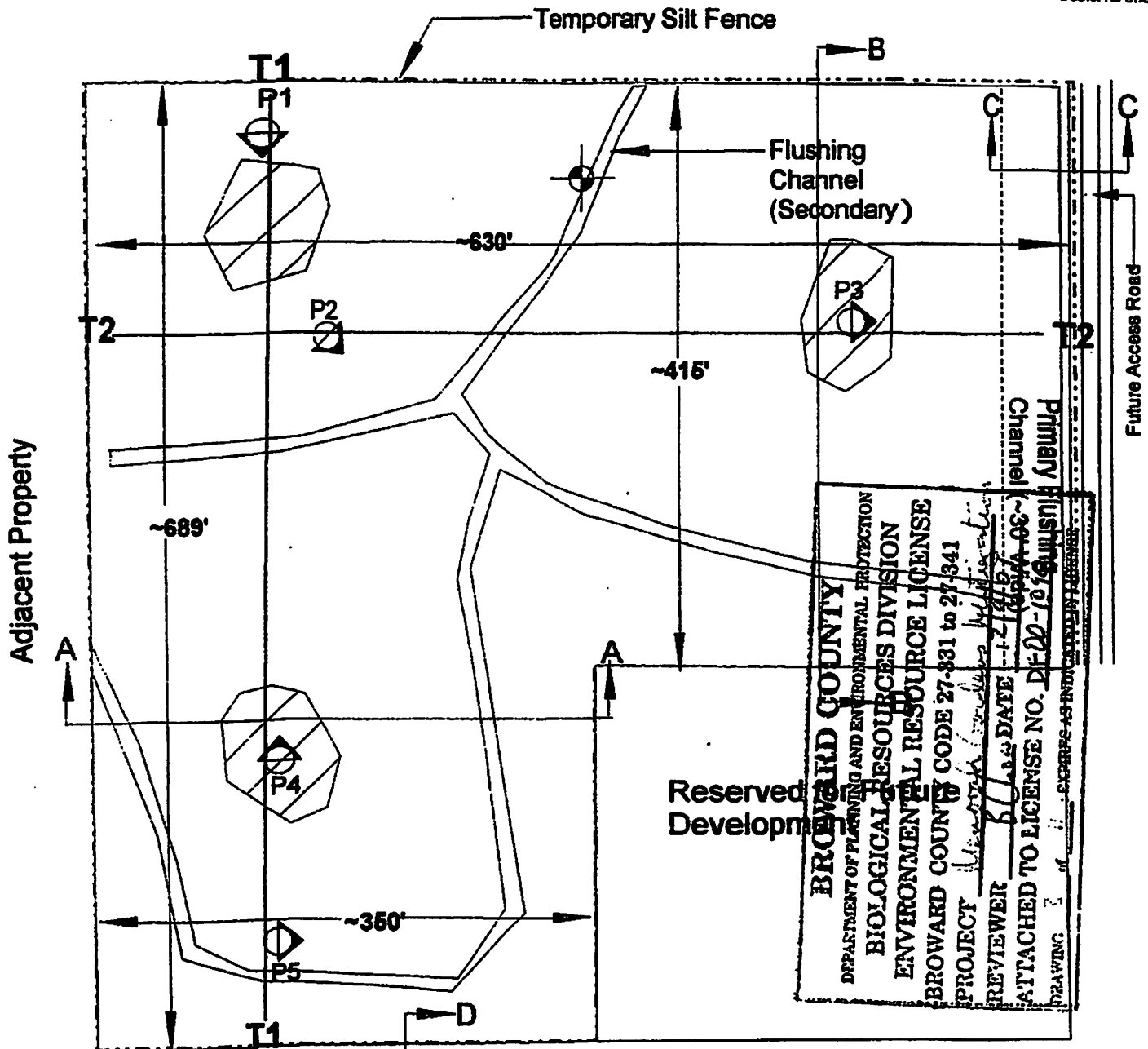

**BROWARD COUNTY**  
DEPARTMENT OF PLANNING AND ENVIRONMENTAL PROTECTION  
**BIOLOGICAL RESOURCES DIVISION**  
ENVIRONMENTAL RESOURCE LICENSE  
BROWARD COUNTY CODE 27-831 to 27-841  
PROJECT: *Menorah Gardens*  
REVIEWER: *[Signature]*  
DATE: *1-2-2001*  
ATTACHED TO LICENSE NO. *DE-00-1079*  
DRAWING NO. *14*

- Hydric Island, ~1.26ac.
- Marsh, ~7.15ac.

Mitigation Acreages:  
1993&1998 violations: 4.05 ac.  
2000 violation: 4.36 ac.  
**TOTAL AREA: 8.41 ac.**

T# = Monitoring Transect No.  
P# Photo Station No. & Direction of Photo  
 Staff Gauge  
- - - - - Location of silt fencing to be installed during construction



**SCI Funeral Services of Fla., Inc.**  
**Menorah Gardens**  
Mitigation Plan View  
Section 34, Township 50, Range 39  
Broward County, Florida

Date	Revision	3 of 8
December 2000	Feb. 2001 Received Permit from SFWMD	
<b>J. J. Goldasich and Associates, Incorporated</b> (561) 893-9555 FAX (561) 893-0054		

Environmental Consultation & Permitting  
Professional Wetland Scientists

### Cross-Section A-A

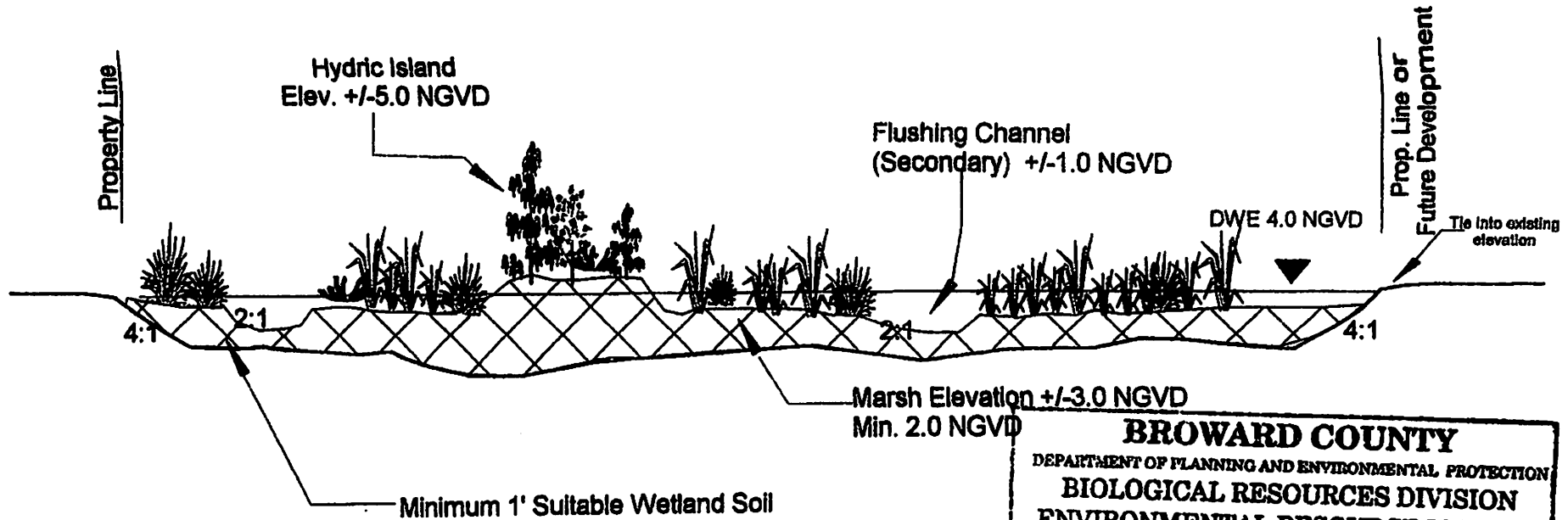

**BROWARD COUNTY**  
 DEPARTMENT OF PLANNING AND ENVIRONMENTAL PROTECTION  
**BIOLOGICAL RESOURCES DIVISION**  
**ENVIRONMENTAL RESOURCE LICENSE**  
 BROWARD COUNTY CODE 27-331 to 27-341  
 PROJECT Menorah Gardens mitigation  
 REVIEWER B. [Signature] DATE 12/9/01  
 ATTACHED TO LICENSE NO. DF00-1098  
 DRAWING 4 OF 11; EXPIRES AS INDICATED IN LICENSE



Professional Wetland Scientists  
 Environmental Consultation & Permitting

**SCI Funeral Services of Fla., Inc.**  
**Menorah Gardens**

Mitigation Cross-Section A-A  
 Section 34, Township 50, Range 39  
 Broward County, Florida

Date	Revision	Sheet
December 2000	Feb. 2001 Removed berm per SFWMD	4 OF 8

J. J. Goldasich & Associates, Incorporated  
 (561) 883-9555 FAX (561) 883-0054

### Cross-Section B-B

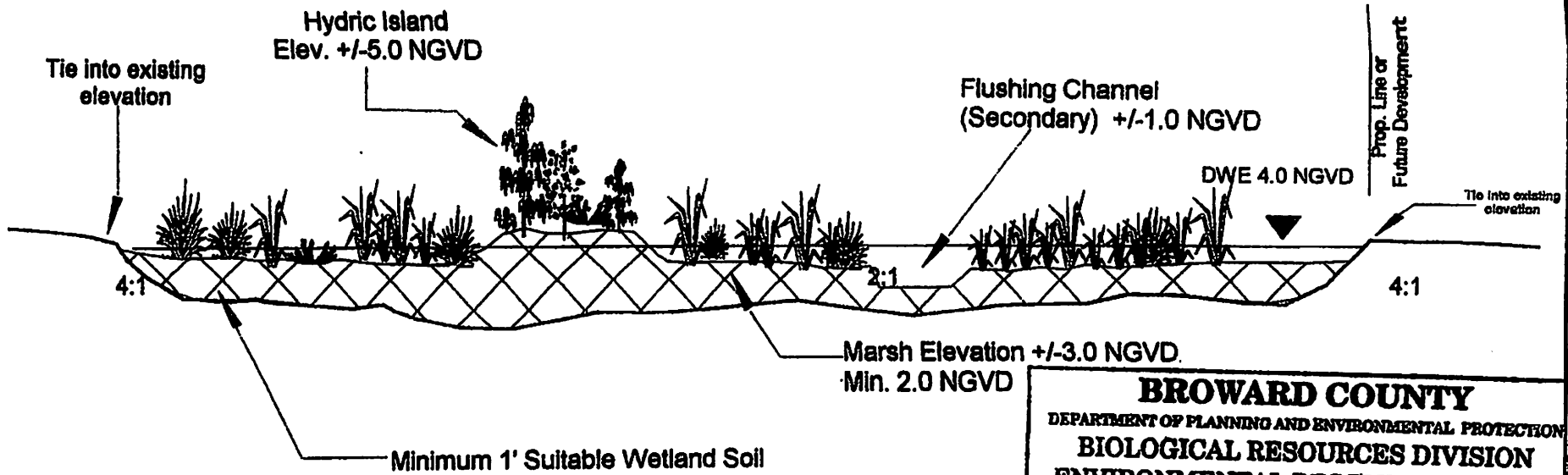

**BROWARD COUNTY**  
 DEPARTMENT OF PLANNING AND ENVIRONMENTAL PROTECTION  
**BIOLOGICAL RESOURCES DIVISION**  
**ENVIRONMENTAL RESOURCE LICENSE**  
 BROWARD COUNTY CODE 27-331 to 27-341  
 PROJECT Menorah Gardens Mitigation  
 REVIEWER D. Chen DATE 12/9/01  
 ATTACHED TO LICENSE NO. D900-1090  
 DRAWING 5 of 11 : EXPIRES AS INDICATED IN LICENSE



Professional Wetland Scientists  
Environmental Consultation & Permitting

**SCI Funeral Services of Fla., Inc.**  
**Menorah Gardens**

Mitigation Cross-Section B-B  
Section 34, Township 50, Range 39  
Broward County, Florida

Date	Revision	Sheet
December 2000	Feb. 2001 (Removed term per SPWMD)	5 OF 8

**J. J. Goldasich & Associates, Incorporated**  
(561) 883-9555 FAX (561) 883-0054



### Cross-Section C-C

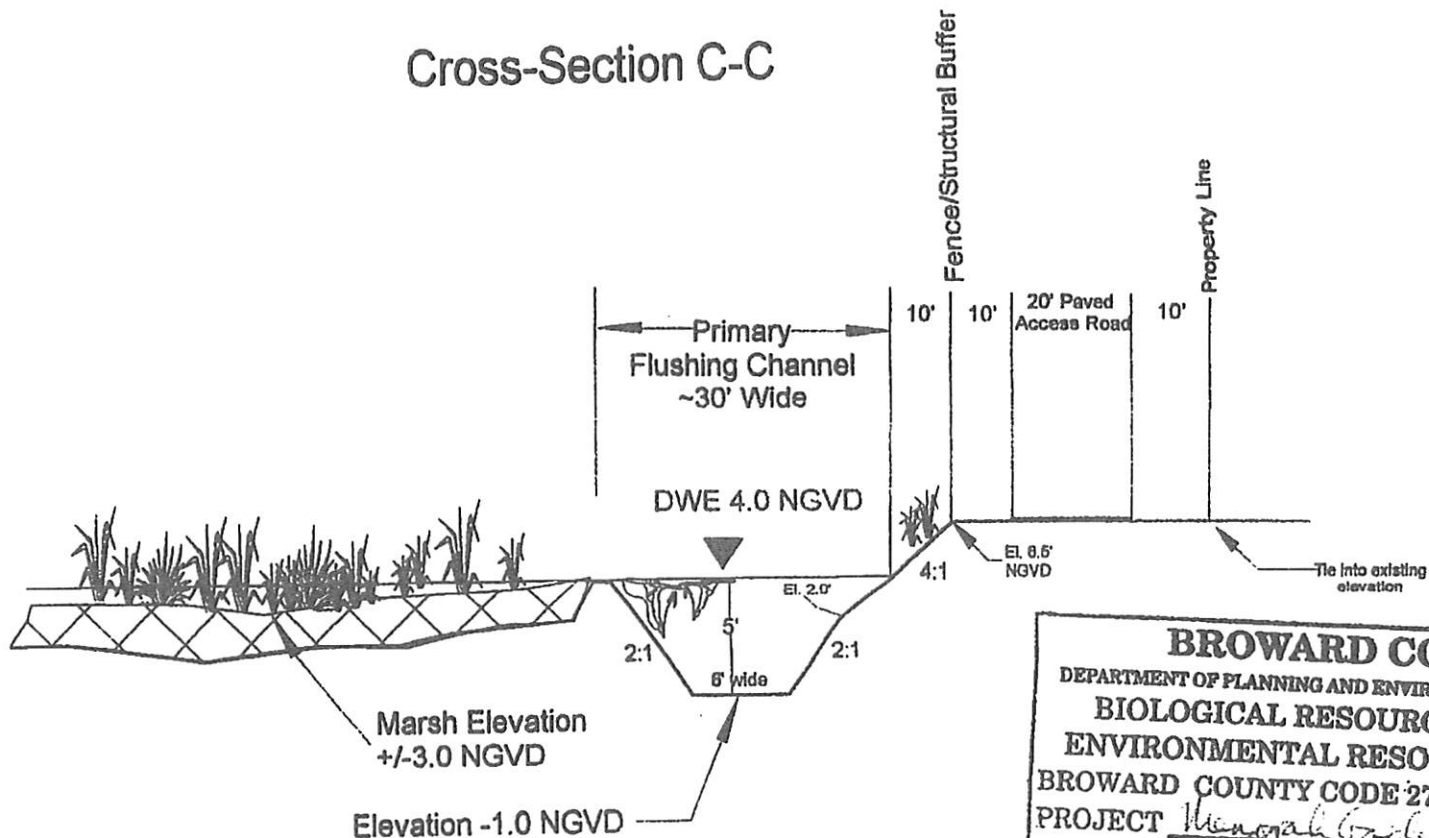

**BROWARD COUNTY**  
 DEPARTMENT OF PLANNING AND ENVIRONMENTAL PROTECTION  
 BIOLOGICAL RESOURCES DIVISION  
 ENVIRONMENTAL RESOURCE LICENSE  
 BROWARD COUNTY CODE 27-331 to 27-341  
 PROJECT Menorah Gardens Restoration  
 REVIEWER B. [Signature] DATE 12/9/01  
 ATTACHED TO LICENSE NO. DE00-1090  
 DRAWING 6 of 11 : EXPIRES AS INDICATED IN LICENSE



Professional Wetland Scientists  
Environmental Consultation & Permitting

SCI Funeral Services of Fla., Inc.  
**Menorah Gardens**

Cross Section C-C  
Section 34, Township 50, Range 39  
Broward County, Florida

Date	Revision	Sheet
December 2000	Feb. 2001   Removed berm per SFWMD	6 OF 8

J. J. Goldasich & Associates, Incorporated  
(561) 883-9555 FAX (561) 883-0054

### Cross-Section D-D

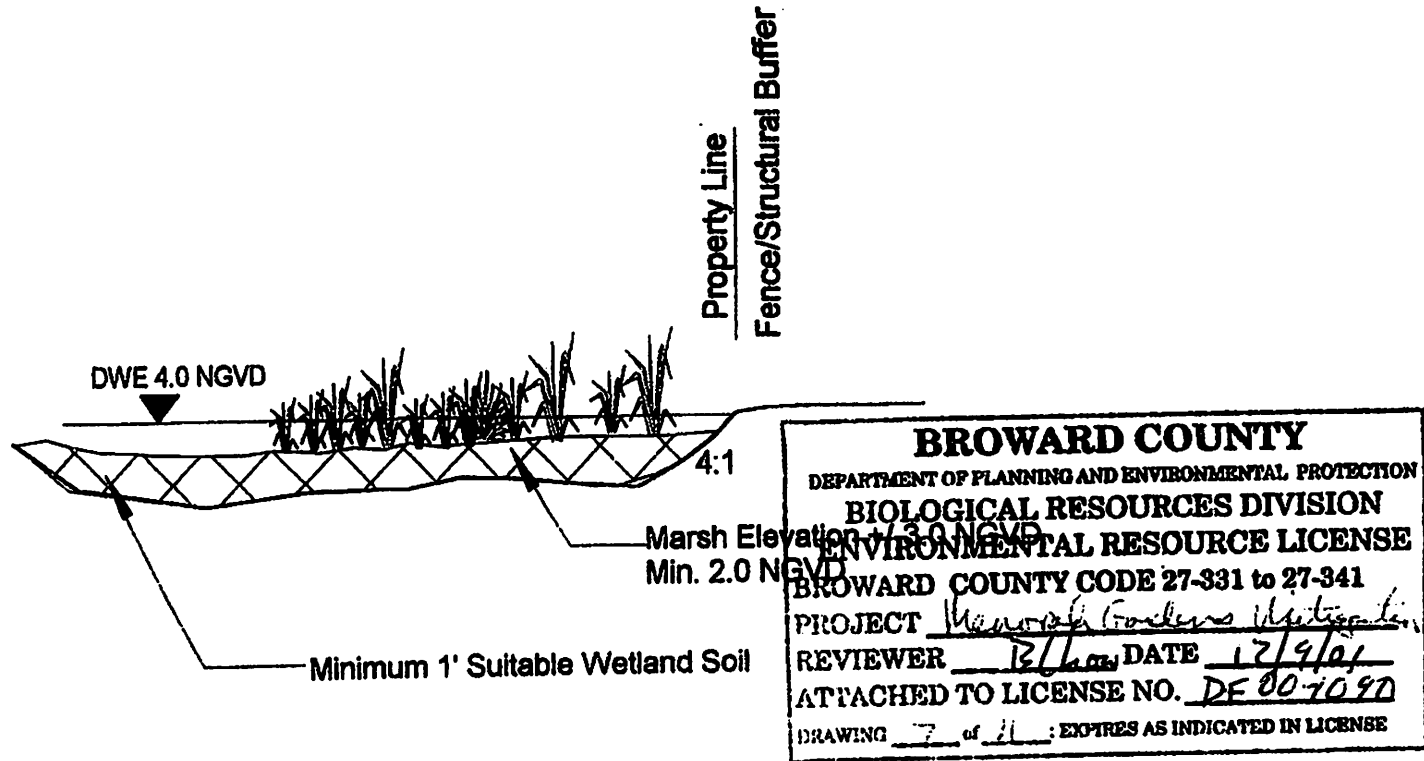

Professional Wetland Scientists  
Environmental Consultation & Permitting

SCI Funeral Services of Fla., Inc.  
Menorah Gardens  
Mitigation Cross-Section D-D  
Section 34, Township 50, Range 39  
Broward County, Florida



Date	Revision	Sheet
February 2001		7 OF 8
J. J. Goldasich & Associates, Incorporated (561) 883-9555 FAX (561) 883-0054		

Future Cemetery Development



**Conceptual Mitigation Area -**  
To be constructed as impacts occur in the future.  
Total Area = 22.11 acres

**Note:**  
All components of conceptual mitigation area to be constructed as per cross sections of initial (Phase I) mitigation area (unless otherwise revised at time of permit modification).

-  Marsh, ~20.49 ac.
-  Hydric Island, ~1.62 ac.

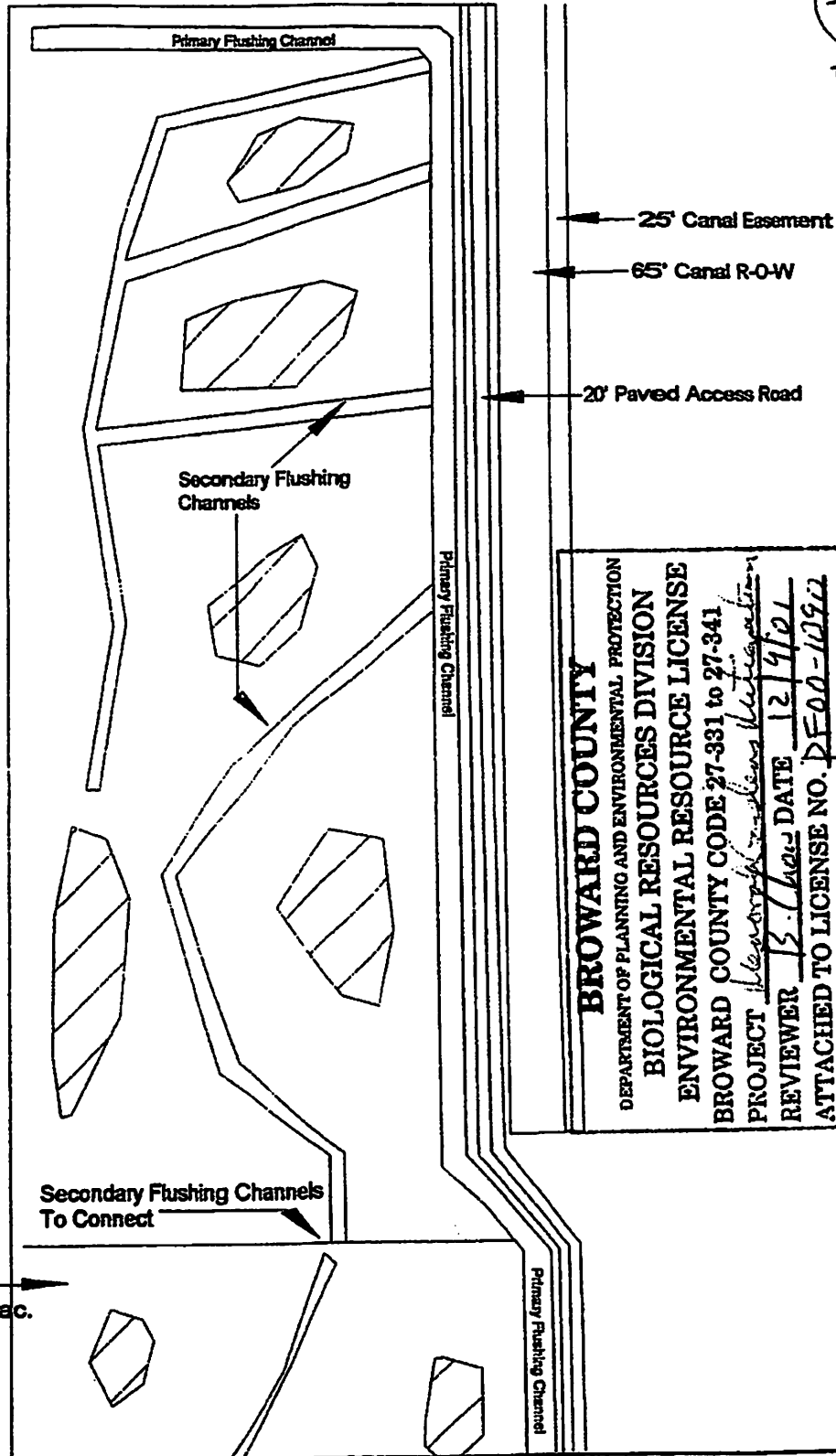

**BROWARD COUNTY**  
DEPARTMENT OF PLANNING AND ENVIRONMENTAL PROTECTION  
BIOLOGICAL RESOURCES DIVISION  
ENVIRONMENTAL RESOURCE LICENSE  
BROWARD COUNTY CODE 27-331 to 27-341  
PROJECT *Menorah Gardens Mitigation*  
REVIEWER *B. Lee* DATE *12/4/01*  
ATTACHED TO LICENSE NO. *PE00-10912*  
DRAWING *5* of *11*; EXPIRES AS INDICATED IN LICENSE



Environmental Consultation & Permitting  
Professional Wetland Scientists

**SCI Funeral Services of Fla., Inc.**  
**Menorah Gardens**  
Conceptual Mitigation Plan  
Section 34, Township 50, Range 39  
Broward County, Florida

Date	Revision	8 of 8
June 2001		
J. J. Goldasich and Associates, Incorporated (561) 883-9555 FAX (561) 883-0054		

**SCI Funeral Services of Fla., Inc. - Menorah Gardens  
Wetland Mitigation Plan**

The 8.41 acre wetland mitigation plan for after-the-fact wetland impacts includes the restoration and creation of a total of 7.15 acres marsh/wet prairie and 1.26 acres of hydric islands. This includes lowering of the ground elevations by scraping the surface organic soils, removal of the underlying limestone and rock as necessary to attain a finished wetland marsh elevation of 3.0 NGVD at top of suitable wetland soils (minimum of 1 foot thick), removal of the melaleuca (*Melaleuca quinquenervia*) trees, roots and tree trunks and the replacement of suitable wetland soils at appropriate wetland elevations. This effort will include the removal of invasive exotic vegetation including Melaleuca and Brazilian pepper (*Schinus terebinthifolius*) from the scraped organic soils. The wetland mitigation areas will be constructed at elevations ranging from 1.0 feet NGVD at the secondary flushing channels to 5.0 feet NGVD at the hydric islands. These areas will provide valuable habitat diversity and wildlife nesting areas not otherwise available in the wetland mitigation area.

The wetland mitigation will be initiated within 90 days of issuance of all of the necessary permits and licenses and be complete by 12/31/01. The specific mitigation sequence will begin with the removal of the suitable soils and screening of the future wetland soil. All unsuitable debris and exotic vegetation will be removed and disposed of in an approved manner. The mitigation area subsurface soils will be lowered to suitable wetland elevations. The suitable wetland soils will then be replaced and graded to achieve a diverse habitat of flushing channels, hydric islands, buffers, and marsh community. Suitable wetland vegetation will be installed following permitting agency review of the graded wetland area.

The Baseline Mitigation Area Monitoring Report will be conducted following removal of the invasive exotic vegetation but before beginning mitigation area work and will be provided to the permitting agencies. Site visits will be initiated with permitting agency staff during the Baseline phase of the project so that the final design and wetland planting parameters may be discussed in the field.

It is anticipated that the wetland mitigation restoration, creation and enhancement efforts will begin during October 2001 with the removal of the invasive exotic vegetation debris and surface soils.

Wetland mitigation area earthwork will continue for approximately two (2) months wherein the ground elevations will be lowered as necessary to the proposed wetland mitigation elevations of 1.0 NGVD to 5.0 NGVD, not including the primary flushing channel that will be at elevation (-)1 foot NGVD.

Following completion of the wetland mitigation area earthwork and as-built survey of the area will be generated and reviewed for consistency with the mitigation plan by 1/31/02. Field evaluations will be requested from the permitting agency compliance staff. Following the field evaluations and confirmation that the wetland mitigation area is at projected elevations the mitigation area will be planted according to the Wetland Mitigation Area Planting Plan, see attached plan.

Maintenance and monitoring of the wetland mitigation area will begin at the Time Zero Mitigation Monitoring Report and continue for a period of five years. An 80% survival rate of planted species will be monitored and maintained throughout the 5-year monitoring period. Following the acceptance of the mitigation area and the Time Zero Monitoring Report, the five-year mitigation area maintenance and monitoring phase will begin. Monitoring reports will be submitted to Broward Co. DPEP on a quarterly basis and to the South Florida Water Management District annually.

**BROWARD COUNTY**  
DEPARTMENT OF PLANNING AND ENVIRONMENTAL PROTECTION  
**BIOLOGICAL RESOURCES DIVISION**  
**ENVIRONMENTAL RESOURCE LICENSE**  
BROWARD COUNTY CODE 27-331 to 27-341  
PROJECT Menorah Gardens Restoration  
REVIEWER [Signature] DATE 12/9/01  
ATTACHED TO LICENSE NO. DF00-1090  
DRAWING \_\_\_\_\_ of \_\_\_\_\_ : EXPIRES AS INDICATED IN LICENSE

## MEMORAH GARDENS

### Wetland Mitigation Area Proposed Time Schedule

Expected Completion Date	Activity
August 31, 2001	Baseline Monitoring Report
November 30, 2001	Remove exotics from Phase I mitigation area
December 31, 2001	Grade mitigation area as per plans, install wetland vegetation
January 31, 2002	Preliminary As-Built Survey of mitigation area and Time Zero Monitoring Report filed with SFWMD, ACOE, and Broward Co. DPEP
February 28, 2002	First Annual Mitigation Monitoring Report filed with SFWMD, ACOE, and Broward Co. DPEP. The report will include data from quarterly monitoring events as outlined in the Monitoring and Maintenance Plan. Note that quarterly monitoring reports will be filed with DPEP as required.
February 28, 2003	Second Annual Mitigation Monitoring Report filed with SFWMD, ACOE, and Broward Co. DPEP. The report will include data from quarterly monitoring events as outlined in the Monitoring and Maintenance Plan. Note that quarterly monitoring reports will be filed with DPEP as required.
February 28, 2004	Third Annual Mitigation Monitoring Report filed with SFWMD, ACOE, and Broward Co. DPEP. The report will include data from quarterly monitoring events as outlined in the Monitoring and Maintenance Plan. Note that quarterly monitoring reports will be filed with DPEP as required.
February 28, 2005	Fourth Annual Mitigation Monitoring Report filed with SFWMD, ACOE, and Broward Co. DPEP. The report will include data from quarterly monitoring events as outlined in the Monitoring and Maintenance Plan. Note that quarterly monitoring reports will be filed with DPEP as required.
March 31, 2005	Onsite meetings with Broward Co. DPEP, SFWMD, and ACOE.
February 28, 2006	Fifth Annual Mitigation Monitoring Report filed with SFWMD, ACOE, and Broward Co. DPEP. The report will include data from quarterly monitoring events as outlined in the Monitoring and Maintenance Plan. Note that quarterly monitoring reports will be filed with DPEP as required.

### BROWARD COUNTY

DEPARTMENT OF PLANNING AND ENVIRONMENTAL PROTECTION  
BIOLOGICAL RESOURCES DIVISION  
ENVIRONMENTAL RESOURCE LICENSE

BROWARD COUNTY CODE 27-331 to 27-341

PROJECT Longleaf Pine Wetland Mitigation

REVIEWER BT DATE 12/9/01

ATTACHED TO LICENSE NO. DF00-1090

DRAWING 1 of 1 : EXPIRES AS INDICATED IN LICENSE

ASSET Time Schedule 4

10/23/01

<b>SCI Funeral Services of Fla., Inc. – Menorah Gardens WETLAND MITIGATION AREA PROPOSED PLANTING PLAN</b>				
Common Name	Botanical Name	~ Spacing / Number of Plants	~ Elevation Range NGVD	Plant Type
<b>HYDRIC ISLANDS</b>				
cypress	<i>Taxodium</i> spp.	Clumps ~15 ft. On Center 240	4.0 – 5.0	3 – 7 gallon mix
dahoon holly	<i>Ilex cassine</i>	Clumps ~15ft. On Center 240	4.0– 5.0	3 gallon
Red bay	<i>Persea palustris</i>	Clumps ~15ft. On Center 240	4.0-5.0	3 gallon
Fakahatchee grass	<i>Tripsacum dactyloides</i>	5 ft. On Center in Clumps 300	4.0– 6.5	1 gallon
cocoplum	<i>Chrysobalanus icaco</i>	5 ft. On Center in Clumps 245	4.0 – 5.0	1 gallon
<b>MARSH AREA</b>				
beak rush	<i>Rhynchospora microcarpa</i>	3 ft. On Center 6,720	3.0 – 4.0	<div style="border: 1px solid black; padding: 5px;"> <p style="text-align: center;"><b>BROWARD COUNTY</b> DEPARTMENT OF PLANNING AND ENVIRONMENTAL PROTECTION BIOLOGICAL RESOURCES DIVISION ENVIRONMENTAL RESOURCE LICENSE BROWARD COUNTY CODE 27-331 to 27-341. PROJECT: <i>Menorah Gardens Wetland Mitigation</i> REVIEWER: <i>B. Lew</i> DATE: <i>12/9/07</i> ATTACHED TO LICENSE NO. <i>D500-1096</i> DRAWING <i>11</i> of <i>11</i>; EXPIRES AS INDICATED IN LICENSE</p> </div>
spike rush	<i>Eleocharis interstincta</i>	3 ft. On Center 5,950	2.5 – 3.0	
duck potato	<i>Sagittaria lancifolia</i>	3 ft. On Center 6,720	2.5 – 3.0	
pickrel weed	<i>Pontederia cordata</i>	3 ft. On Center 6,720	2.5 – 3.0	
waterlily	<i>Nymphaea odorata</i>	3 ft. On Center In Primary Flushing Channel 870	3.0(-)1.0	
fireflag	<i>Thalia geniculata</i>	3 ft. On Center 7,550	2.5-3.0	
<b>Total Trees and Shrubs</b> 965		<b>Total Herbaceous Plants</b> 34,830		

